

# LOT 1501



## LEGEND

	BOUNDARY LINE
	ADJACENT BOUNDARY
	EASEMENT
	SEWER
	STORMWATER
	WATER METER

	TEL	TELSTRA / NBN PIT
	EPIL	ELECTRICAL PILLAR
	LP	LIGHT POLE
	SMH	SEWER MAN HOLE
	PIT	DRAINAGE PIT
	KIP	KERB INLET PIT

## EASEMENTS

- (EA) EASEMENT TO DRAIN WATER 1.5 WIDE (D.P.1277267)
- (HA) EASEMENT TO DRAIN WATER 1.5 WIDE

## DISCLAIMER

- THIS PLAN HAS BEEN COMPILED FROM DESIGN PLANS AT THE SCALE/S STATED. IT IS RECOMMENDED THAT A SURVEY IS UNDERTAKEN PRIOR TO THE PREPARATION OF CONSTRUCTION DRAWINGS. THE PLAN IS SUITABLE FOR DESIGN ONLY & MAY NOT BE SUITABLE FOR ANY OTHER PURPOSE OR FOR USE AT ANY OTHER SCALES/S.
- THE BOUNDARIES & SERVICES SHOWN ARE APPROXIMATE ONLY. FURTHER SURVEY WILL BE REQUIRED IF CONSTRUCTION IS TO TAKE PLACE ON OR ADJACENT TO THE BOUNDARIES.

**NOTE** • ANTICIPATED LOT CLASSIFICATION IS H2

**DELFS LASCELLES**  
CONSULTING SURVEYORS





# LOT 1502

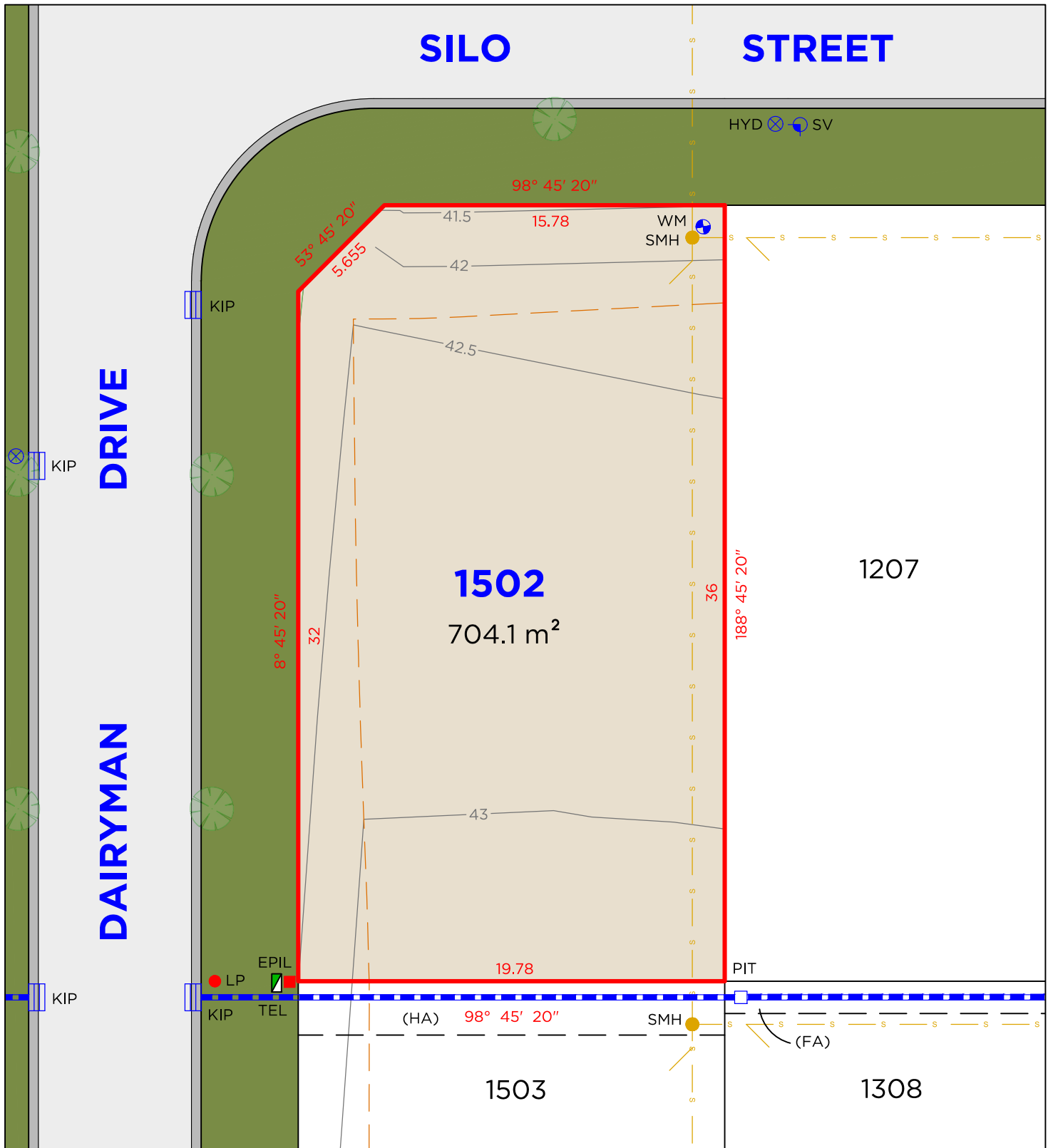



# LOT 1503

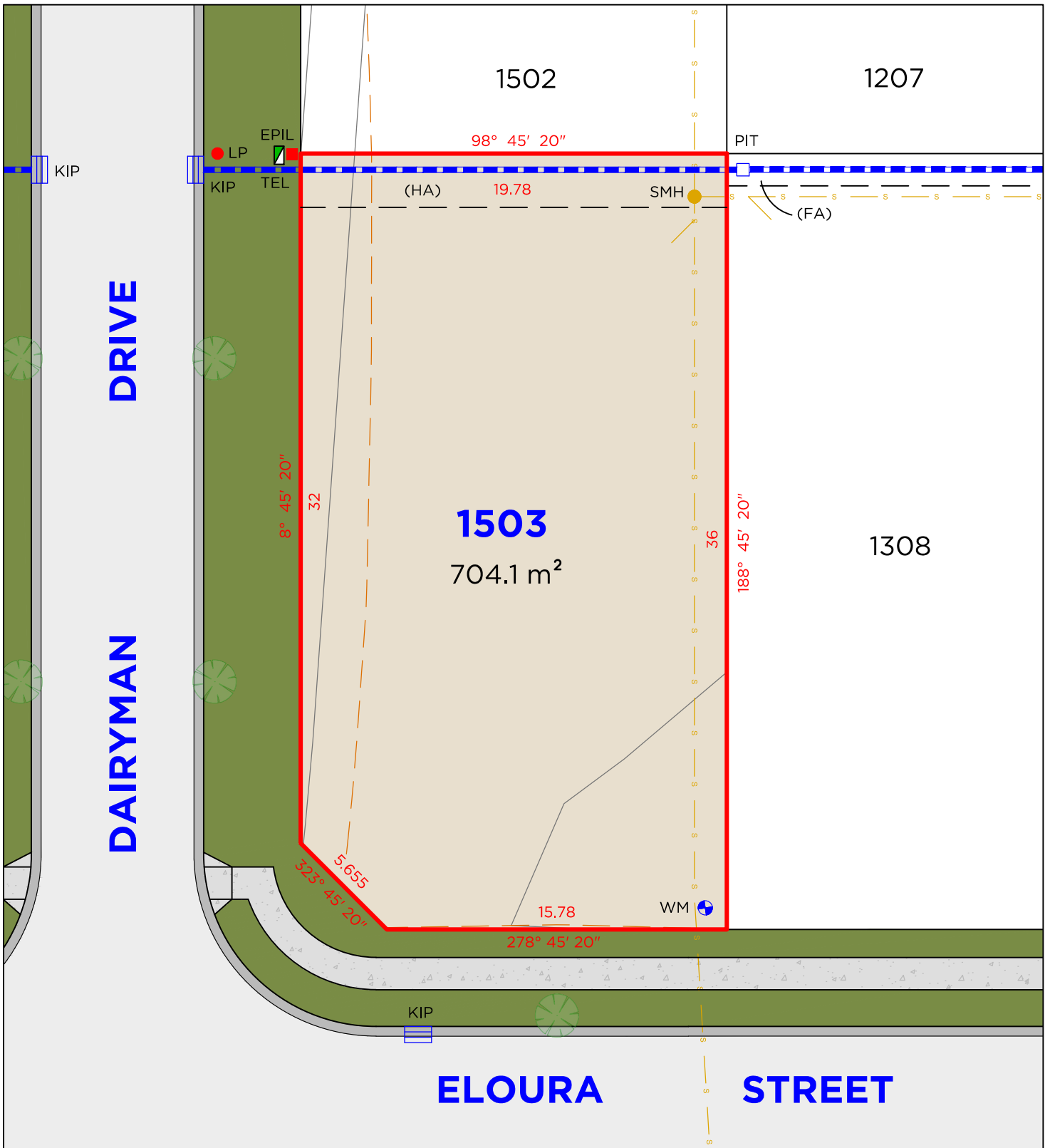

## LEGEND

	BOUNDARY LINE
	ADJACENT BOUNDARY
	EASEMENT
	SEWER
	STORMWATER
	WM
	WATER METER

	TEL	TELSTRA / NBN PIT
	EPIL	ELECTRICAL PILLAR
	LP	LIGHT POLE
	SMH	SEWER MAN HOLE
	PIT	DRAINAGE PIT
	KIP	KERB INLET PIT

## EASEMENTS

- (FA) EASEMENT TO DRAIN WATER 1.5 WIDE (D.P.1277563)
- (HA) EASEMENT TO DRAIN WATER 2.5 WIDE

## DISCLAIMER

- THIS PLAN HAS BEEN COMPILED FROM DESIGN PLANS AT THE SCALE/S STATED. IT IS RECOMMENDED THAT A SURVEY IS UNDERTAKEN PRIOR TO THE PREPARATION OF CONSTRUCTION DRAWINGS. THE PLAN IS SUITABLE FOR DESIGN ONLY & MAY NOT BE SUITABLE FOR ANY OTHER PURPOSE OR FOR USE AT ANY OTHER SCALES/S.
- THE BOUNDARIES & SERVICES SHOWN ARE APPROXIMATE ONLY. FURTHER SURVEY WILL BE REQUIRED IF CONSTRUCTION IS TO TAKE PLACE ON OR ADJACENT TO THE BOUNDARIES.

**NOTE** • ANTICIPATED LOT CLASSIFICATION IS H2

**DELFS LASCELLES**  
CONSULTING SURVEYORS





# LOT 1504

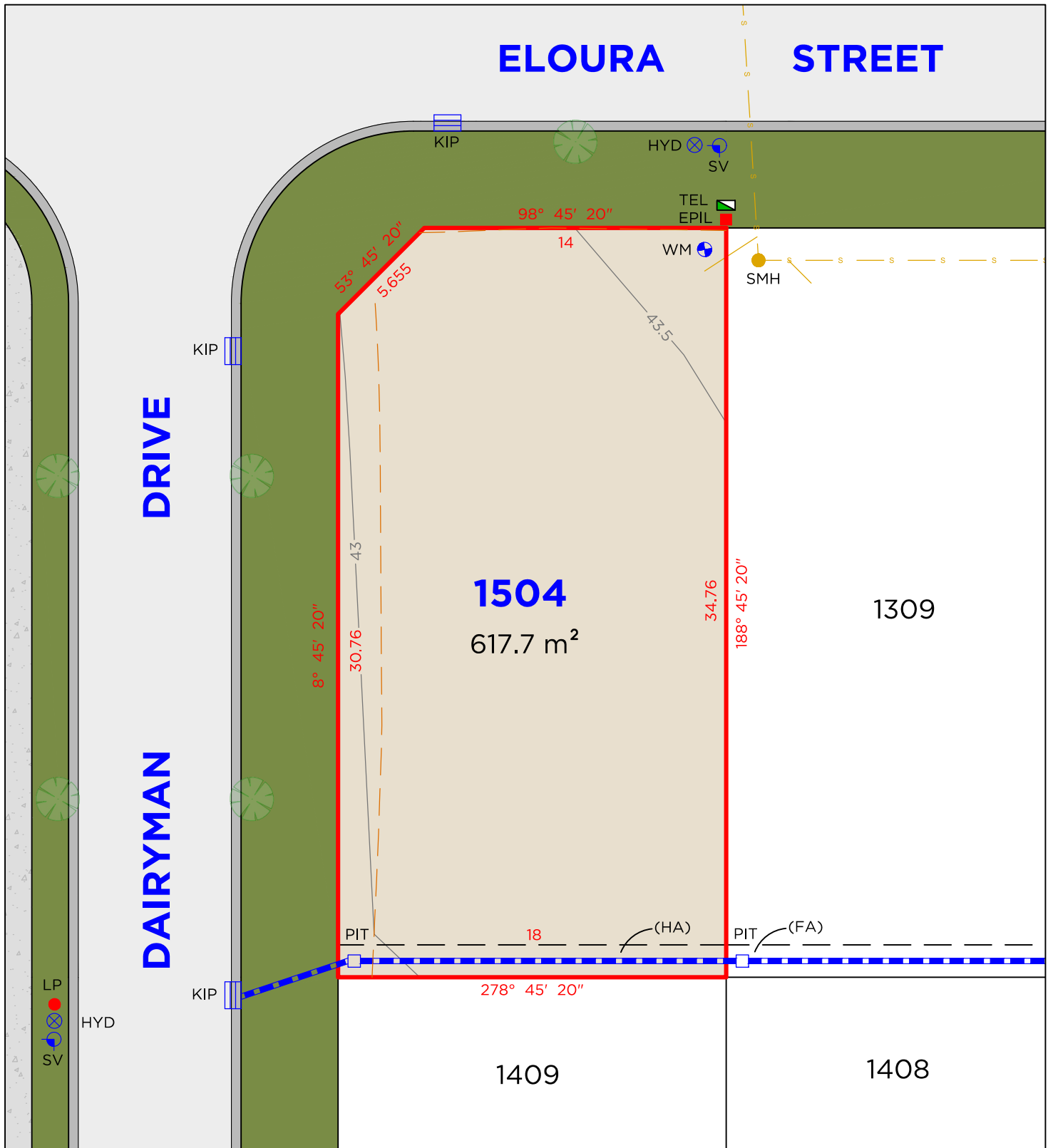

## LEGEND

	BOUNDARY LINE
	ADJACENT BOUNDARY
	EASEMENT
	SEWER
	STORMWATER
	WATER METER
	HYDRANT

	TEL	TELSTRA / NBN PIT
	LP	LIGHT POLE
	SMH	SEWER MAN HOLE
	PIT	DRAINAGE PIT
	KIP	KERB INLET PIT
	EPIL	ELECTRICAL PILLAR
	SV	STOP VALVE

## EASEMENTS

- (FA) EASEMENT TO DRAIN WATER 1.5 WIDE (D.P.1277563)
- (HA) EASEMENT TO DRAIN WATER 1.5 WIDE

## DISCLAIMER

- THIS PLAN HAS BEEN COMPILED FROM DESIGN PLANS AT THE SCALE/S STATED. IT IS RECOMMENDED THAT A SURVEY IS UNDERTAKEN PRIOR TO THE PREPARATION OF CONSTRUCTION DRAWINGS. THE PLAN IS SUITABLE FOR DESIGN ONLY & MAY NOT BE SUITABLE FOR ANY OTHER PURPOSE OR FOR USE AT ANY OTHER SCALES/S.
- THE BOUNDARIES & SERVICES SHOWN ARE APPROXIMATE ONLY. FURTHER SURVEY WILL BE REQUIRED IF CONSTRUCTION IS TO TAKE PLACE ON OR ADJACENT TO THE BOUNDARIES.

**NOTE** • ANTICIPATED LOT CLASSIFICATION IS H2

**DELFS LASCELLES**  
CONSULTING SURVEYORS





# LOT 1505

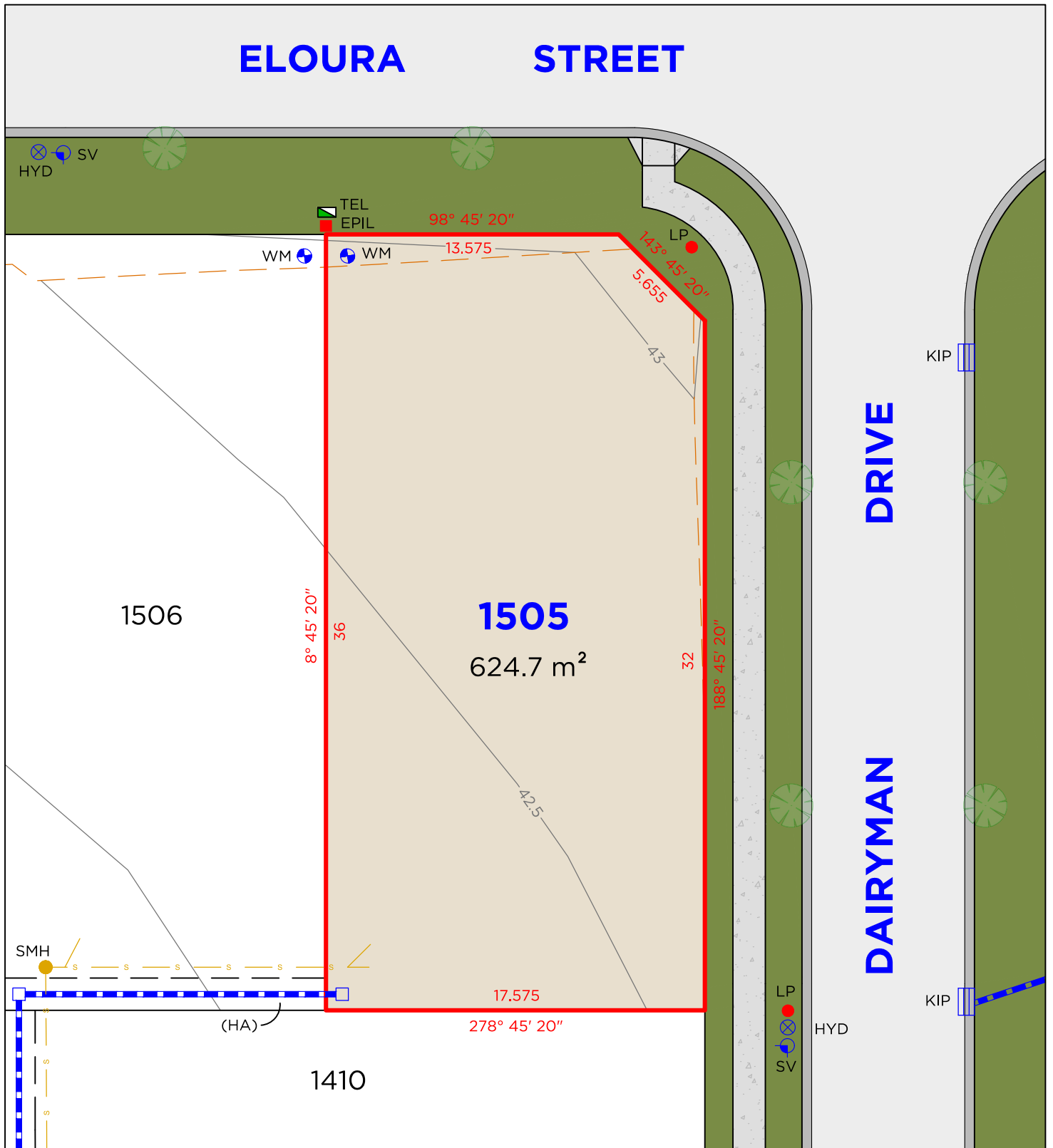

## LEGEND

	BOUNDARY LINE
	ADJACENT BOUNDARY
	EASEMENT
	SEWER
	STORMWATER
	WM WATER METER
	HYD HYDRANT

	TEL TELSTRA / NBN PIT
	EPIL ELECTRICAL PILLAR
	LP LIGHT POLE
	SMH SEWER MAN HOLE
	PIT DRAINAGE PIT
	KIP KERB INLET PIT
	SV STOP VALVE

## EASEMENTS

(HA) EASEMENT TO DRAIN WATER 1.5 WIDE

## DISCLAIMER

1. THIS PLAN HAS BEEN COMPILED FROM DESIGN PLANS AT THE SCALE/S STATED. IT IS RECOMMENDED THAT A SURVEY IS UNDERTAKEN PRIOR TO THE PREPARATION OF CONSTRUCTION DRAWINGS. THE PLAN IS SUITABLE FOR DESIGN ONLY & MAY NOT BE SUITABLE FOR ANY OTHER PURPOSE OR FOR USE AT ANY OTHER SCALES/S.
2. THE BOUNDARIES & SERVICES SHOWN ARE APPROXIMATE ONLY. FURTHER SURVEY WILL BE REQUIRED IF CONSTRUCTION IS TO TAKE PLACE ON OR ADJACENT TO THE BOUNDARIES.

**NOTE** • ANTICIPATED LOT CLASSIFICATION IS H2

**DELFS LASCELLES**  
CONSULTING SURVEYORS

**HEREFORD HILL**  
• LOCHINVAR •



# LOT 1506

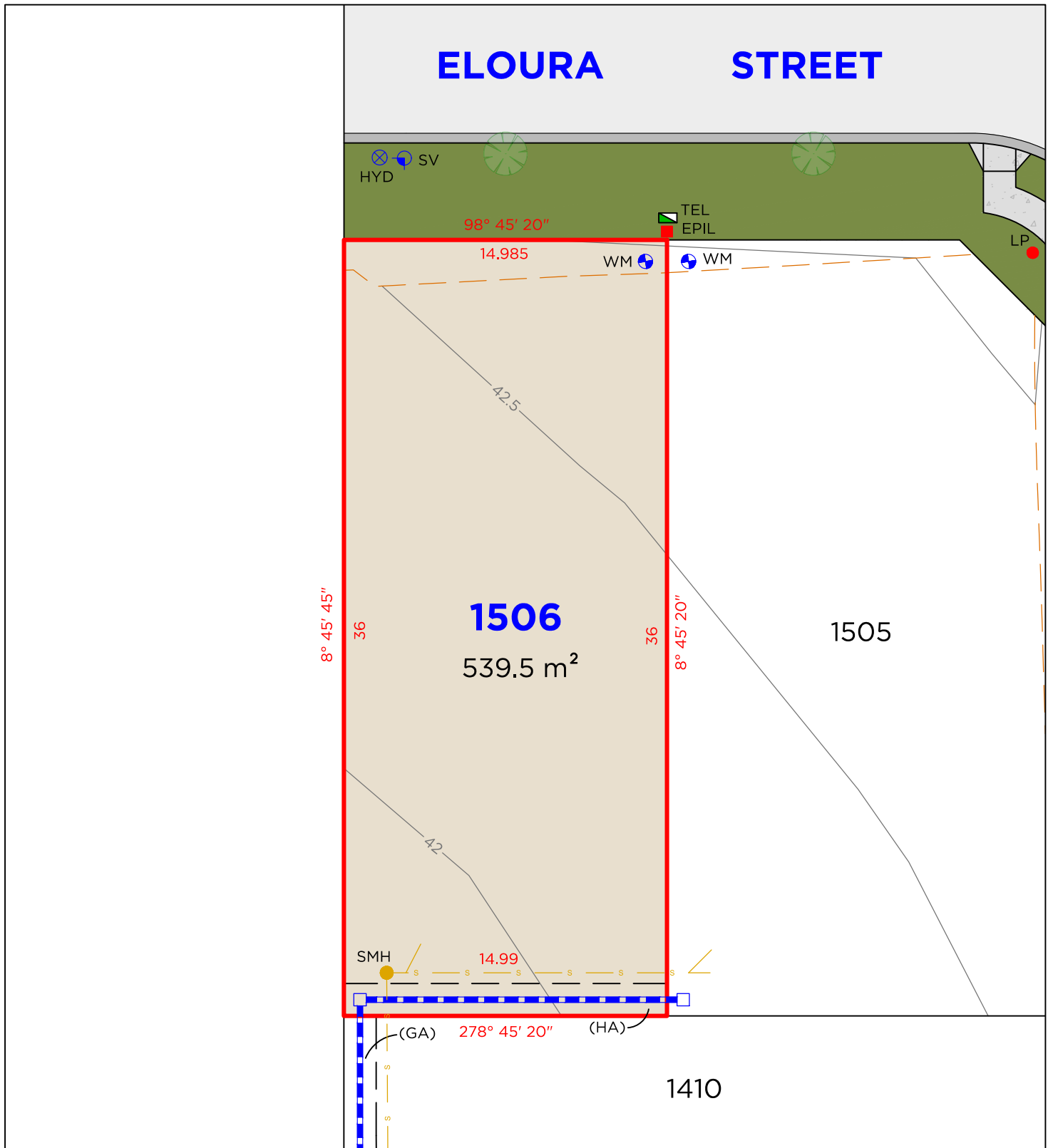

## LEGEND

	BOUNDARY LINE
	ADJACENT BOUNDARY
	EASEMENT
	SEWER
	STORMWATER
	WATER METER
	HYDRANT

	TEL	TELSTRA / NBN PIT
	EPIL	ELECTRICAL PILLAR
	LP	LIGHT POLE
	SMH	SEWER MAN HOLE
	PIT	DRAINAGE PIT
	KIP	KERB INLET PIT
	SV	STOP VALVE

## EASEMENTS

- (GA) EASEMENT TO DRAIN WATER 1.5 WIDE (D.P.1277565)  
(HA) EASEMENT TO DRAIN WATER 1.5 WIDE

## DISCLAIMER

- THIS PLAN HAS BEEN COMPILED FROM DESIGN PLANS AT THE SCALE/S STATED. IT IS RECOMMENDED THAT A SURVEY IS UNDERTAKEN PRIOR TO THE PREPARATION OF CONSTRUCTION DRAWINGS. THE PLAN IS SUITABLE FOR DESIGN ONLY & MAY NOT BE SUITABLE FOR ANY OTHER PURPOSE OR FOR USE AT ANY OTHER SCALES/S.
- THE BOUNDARIES & SERVICES SHOWN ARE APPROXIMATE ONLY. FURTHER SURVEY WILL BE REQUIRED IF CONSTRUCTION IS TO TAKE PLACE ON OR ADJACENT TO THE BOUNDARIES.

**NOTE** • ANTICIPATED LOT CLASSIFICATION IS H2

**DELFS  
LASCELLES**  
CONSULTING SURVEYORS





# LOT 1507

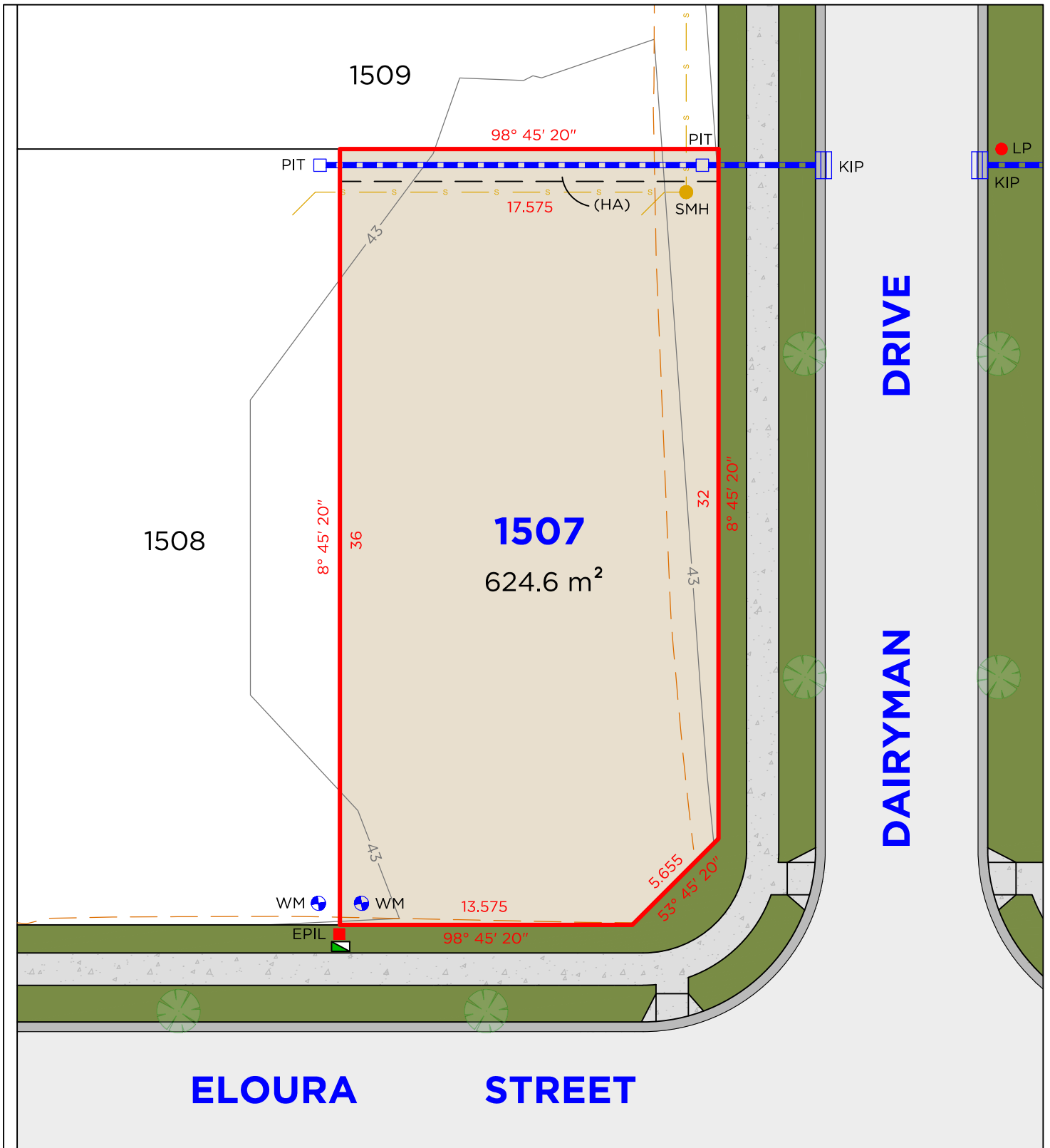

## LEGEND

	BOUNDARY LINE
	ADJACENT BOUNDARY
	EASEMENT
	SEWER
	STORMWATER
	WM
	WATER METER

	TEL	TELSTRA / NBN PIT
	EPIL	ELECTRICAL PILLAR
	LP	LIGHT POLE
	SMH	SEWER MAN HOLE
	PIT	DRAINAGE PIT
	KIP	KERB INLET PIT

## EASEMENTS

(HA) EASEMENT TO DRAIN WATER 1.5 WIDE

## DISCLAIMER

1. THIS PLAN HAS BEEN COMPILED FROM DESIGN PLANS AT THE SCALE/S STATED. IT IS RECOMMENDED THAT A SURVEY IS UNDERTAKEN PRIOR TO THE PREPARATION OF CONSTRUCTION DRAWINGS. THE PLAN IS SUITABLE FOR DESIGN ONLY & MAY NOT BE SUITABLE FOR ANY OTHER PURPOSE OR FOR USE AT ANY OTHER SCALES/S.
2. THE BOUNDARIES & SERVICES SHOWN ARE APPROXIMATE ONLY. FURTHER SURVEY WILL BE REQUIRED IF CONSTRUCTION IS TO TAKE PLACE ON OR ADJACENT TO THE BOUNDARIES.

**NOTE** • ANTICIPATED LOT CLASSIFICATION IS H2

**DELFS LASCELLES**  
CONSULTING SURVEYORS





# LOT 1508

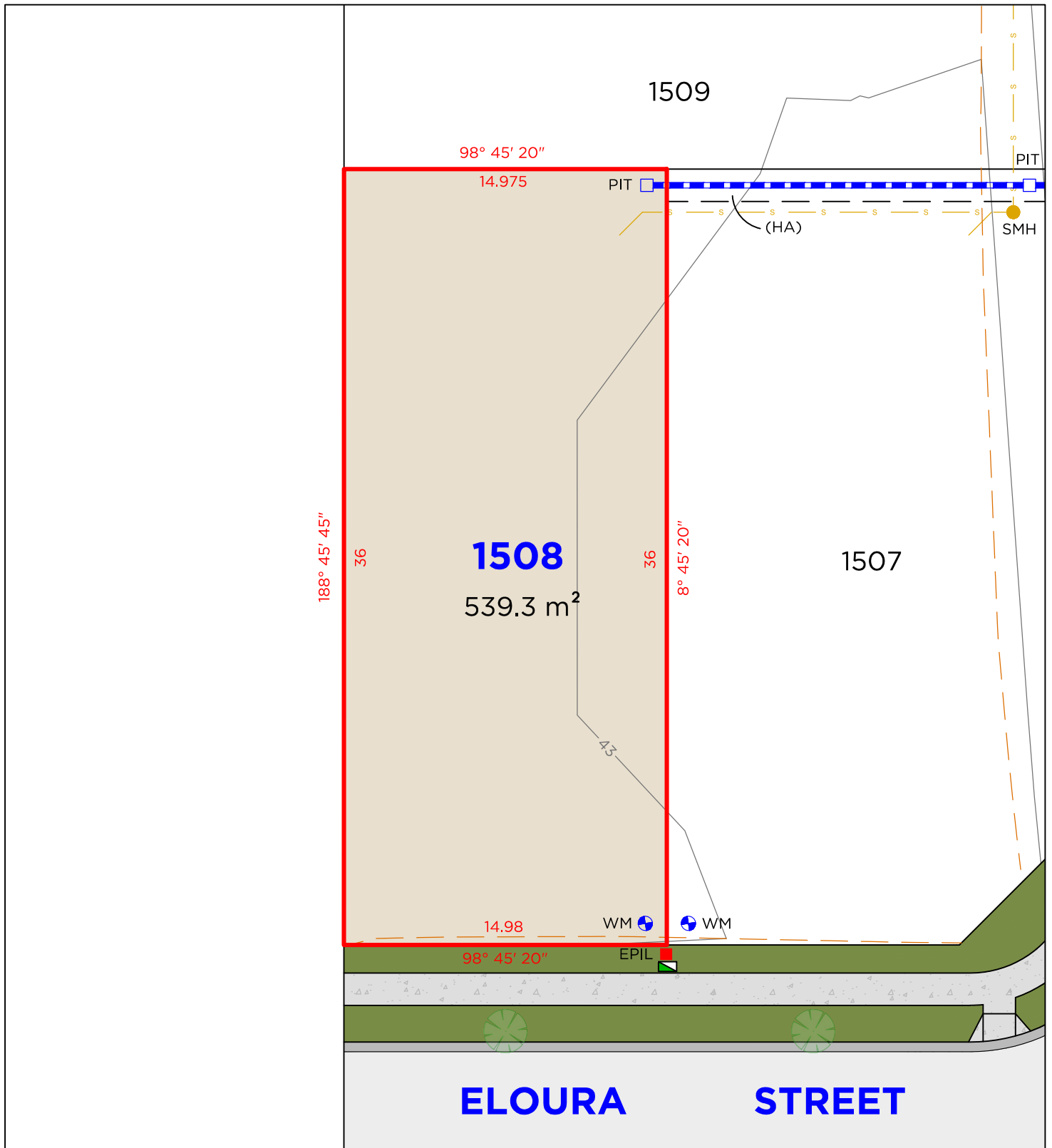

## LEGEND

	BOUNDARY LINE
	ADJACENT BOUNDARY
	EASEMENT
	SEWER
	STORMWATER
	WM WATER METER

	TEL TELSTRA / NBN PIT
	EPIL ELECTRICAL PILLAR
	LP LIGHT POLE
	SMH SEWER MAN HOLE
	PIT DRAINAGE PIT
	KIP KERB INLET PIT

## EASEMENTS

(HA) EASEMENT TO DRAIN WATER 1.5 WIDE

## DISCLAIMER

1. THIS PLAN HAS BEEN COMPILED FROM DESIGN PLANS AT THE SCALE/S STATED. IT IS RECOMMENDED THAT A SURVEY IS UNDERTAKEN PRIOR TO THE PREPARATION OF CONSTRUCTION DRAWINGS. THE PLAN IS SUITABLE FOR DESIGN ONLY & MAY NOT BE SUITABLE FOR ANY OTHER PURPOSE OR FOR USE AT ANY OTHER SCALES/S.
2. THE BOUNDARIES & SERVICES SHOWN ARE APPROXIMATE ONLY. FURTHER SURVEY WILL BE REQUIRED IF CONSTRUCTION IS TO TAKE PLACE ON OR ADJACENT TO THE BOUNDARIES.

**NOTE** • ANTICIPATED LOT CLASSIFICATION IS H2

**DELFS  
LASCELLES**  
CONSULTING SURVEYORS





# LOT 1509

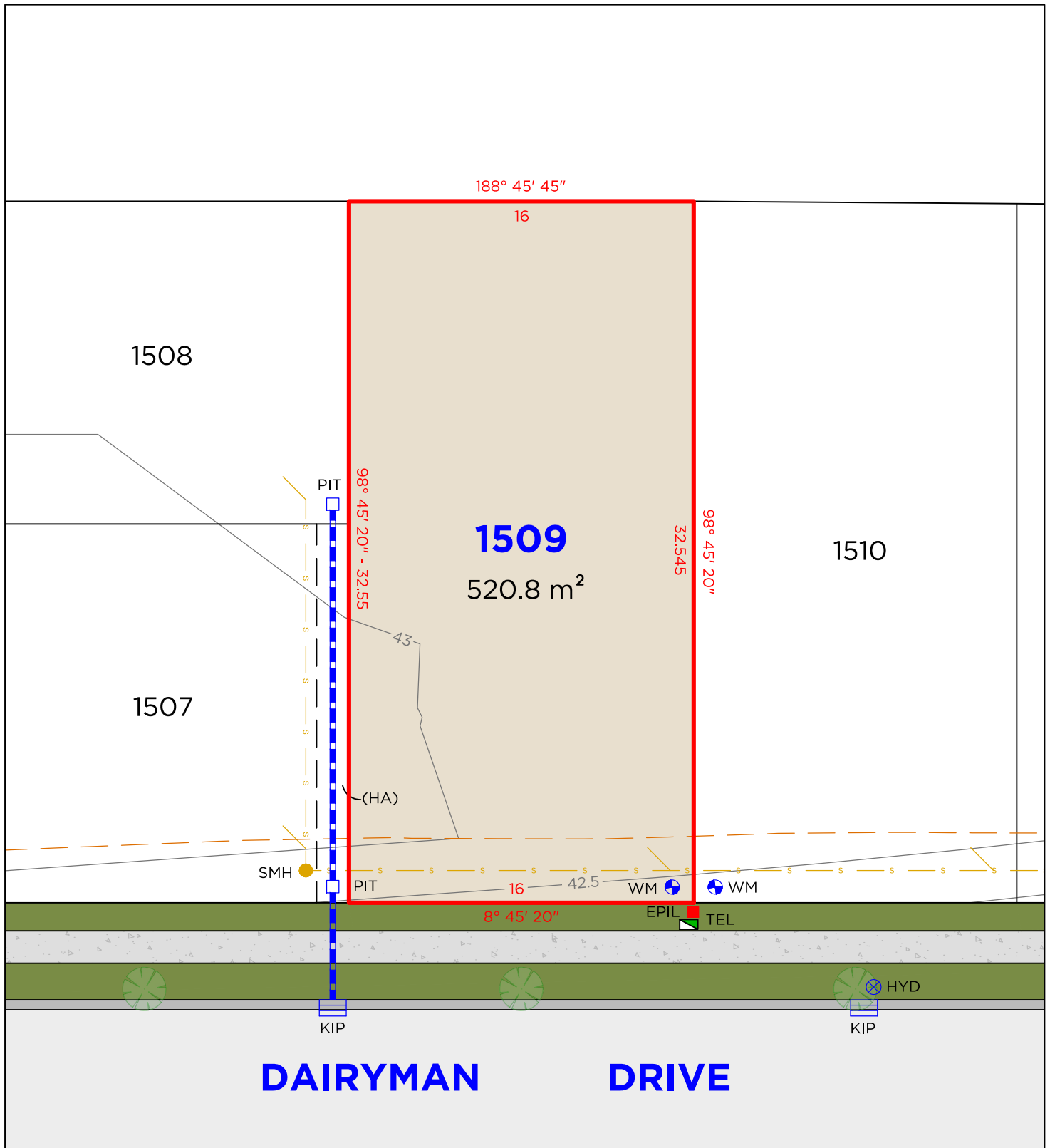

## LEGEND

	BOUNDARY LINE
	ADJACENT BOUNDARY
	EASEMENT
	SEWER
	STORMWATER
	WM WATER METER
	HYD HYDRANT

	TEL TELSTRA / NBN PIT
	EPIL ELECTRICAL PILLAR
	LP LIGHT POLE
	SMH SEWER MAN HOLE
	PIT DRAINAGE PIT
	KIP KERB INLET PIT

## EASEMENTS

(HA) EASEMENT TO DRAIN WATER 1.5 WIDE

## DISCLAIMER

1. THIS PLAN HAS BEEN COMPILED FROM DESIGN PLANS AT THE SCALE/S STATED. IT IS RECOMMENDED THAT A SURVEY IS UNDERTAKEN PRIOR TO THE PREPARATION OF CONSTRUCTION DRAWINGS. THE PLAN IS SUITABLE FOR DESIGN ONLY & MAY NOT BE SUITABLE FOR ANY OTHER PURPOSE OR FOR USE AT ANY OTHER SCALES/S.
2. THE BOUNDARIES & SERVICES SHOWN ARE APPROXIMATE ONLY. FURTHER SURVEY WILL BE REQUIRED IF CONSTRUCTION IS TO TAKE PLACE ON OR ADJACENT TO THE BOUNDARIES.

**NOTE** • ANTICIPATED LOT CLASSIFICATION IS H2

**DELFS LASCELLES**  
CONSULTING SURVEYORS





# LOT 1510

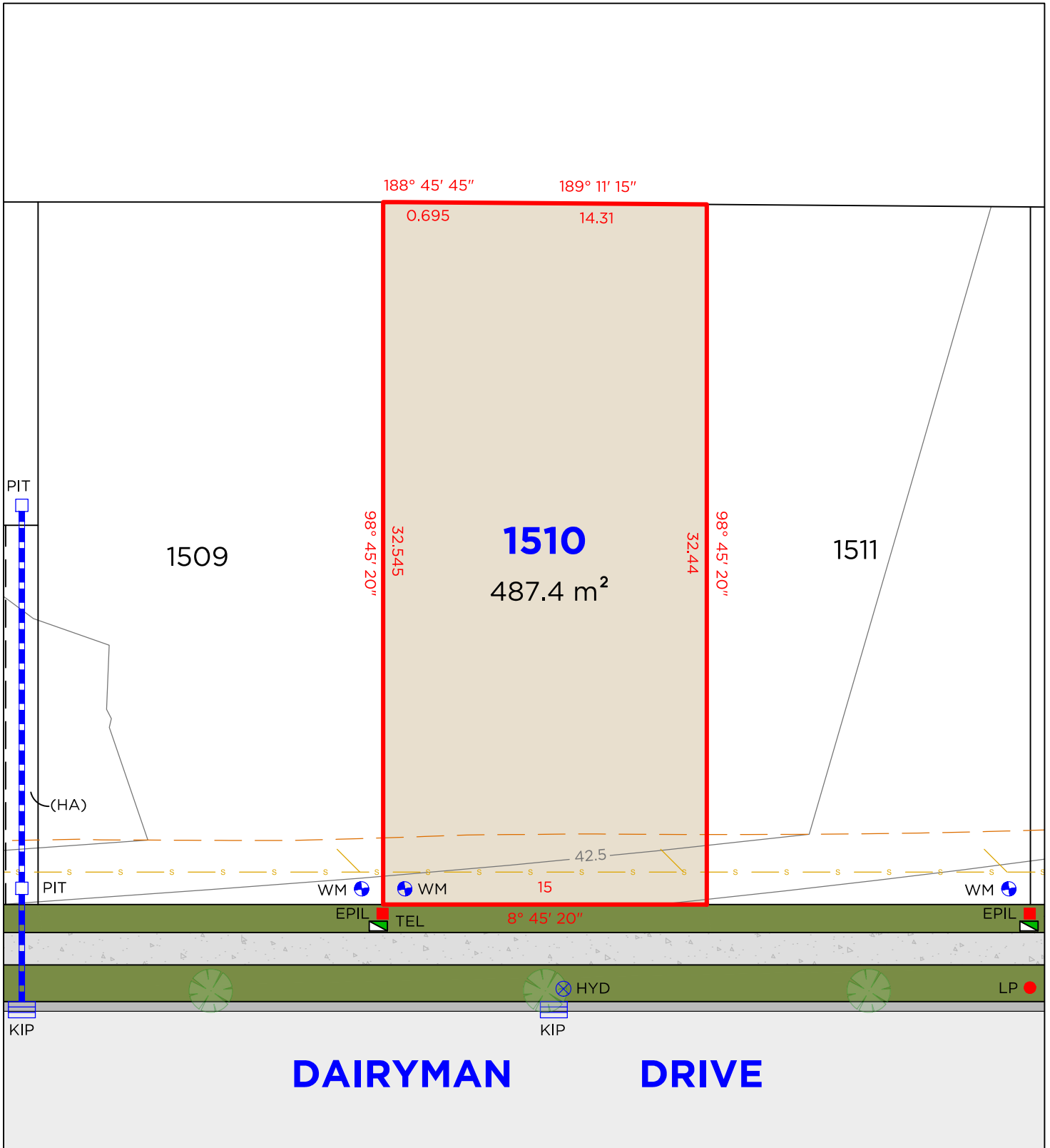

## LEGEND

	BOUNDARY LINE
	ADJACENT BOUNDARY
	EASEMENT
	SEWER
	STORMWATER
	WM WATER METER
	HYD HYDRANT

	TEL TELSTRA / NBN PIT
	EPIL ELECTRICAL PILLAR
	LP LIGHT POLE
	SMH SEWER MAN HOLE
	PIT DRAINAGE PIT
	KIP KERB INLET PIT

## EASEMENTS

(HA) EASEMENT TO DRAIN WATER 1.5 WIDE

## DISCLAIMER

1. THIS PLAN HAS BEEN COMPILED FROM DESIGN PLANS AT THE SCALE/S STATED. IT IS RECOMMENDED THAT A SURVEY IS UNDERTAKEN PRIOR TO THE PREPARATION OF CONSTRUCTION DRAWINGS. THE PLAN IS SUITABLE FOR DESIGN ONLY & MAY NOT BE SUITABLE FOR ANY OTHER PURPOSE OR FOR USE AT ANY OTHER SCALES/S.
2. THE BOUNDARIES & SERVICES SHOWN ARE APPROXIMATE ONLY. FURTHER SURVEY WILL BE REQUIRED IF CONSTRUCTION IS TO TAKE PLACE ON OR ADJACENT TO THE BOUNDARIES.

**NOTE** • ANTICIPATED LOT CLASSIFICATION IS H2

**DELFS LASCELLES**  
CONSULTING SURVEYORS





LOT 1511

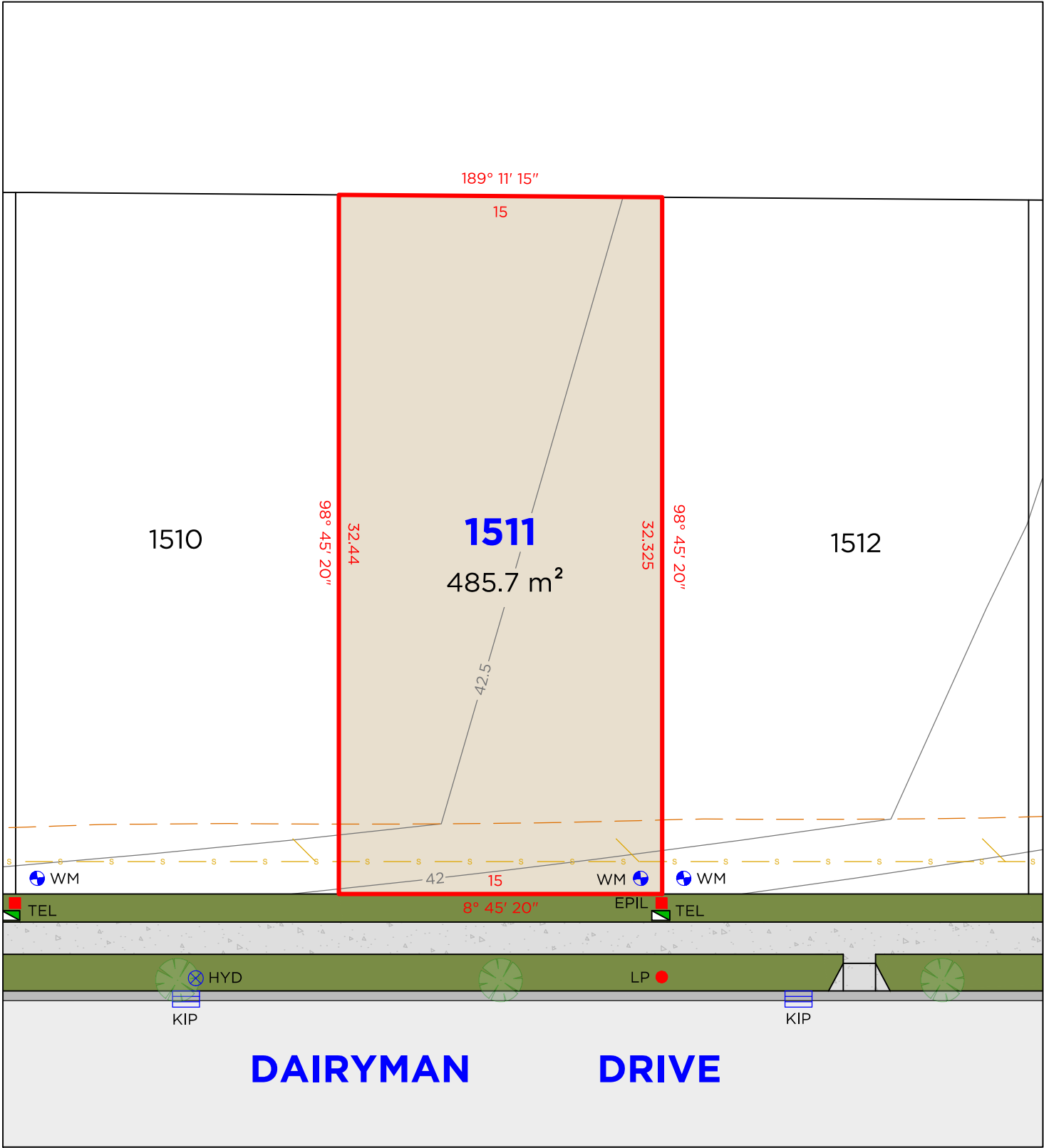

LEGEND

	BOUNDARY LINE		TEL	TELSTRA / NBN PIT
	ADJACENT BOUNDARY		EPIL	ELECTRICAL PILLAR
	EASEMENT		LP	LIGHT POLE
	SEWER		SMH	SEWER MAN HOLE
	WM		KIP	KERB INLET PIT
	HYD			
	HYDRANT			

DISCLAIMER

- THIS PLAN HAS BEEN COMPILED FROM DESIGN PLANS AT THE SCALE/S STATED. IT IS RECOMMENDED THAT A SURVEY IS UNDERTAKEN PRIOR TO THE PREPARATION OF CONSTRUCTION DRAWINGS. THE PLAN IS SUITABLE FOR DESIGN ONLY & MAY NOT BE SUITABLE FOR ANY OTHER PURPOSE OR FOR USE AT ANY OTHER SCALES/S.
- THE BOUNDARIES & SERVICES SHOWN ARE APPROXIMATE ONLY. FURTHER SURVEY WILL BE REQUIRED IF CONSTRUCTION IS TO TAKE PLACE ON OR ADJACENT TO THE BOUNDARIES.

NOTE • ANTICIPATED LOT CLASSIFICATION IS H2

**DELFS LASCELLES**  
CONSULTING SURVEYORS





# LOT 1512

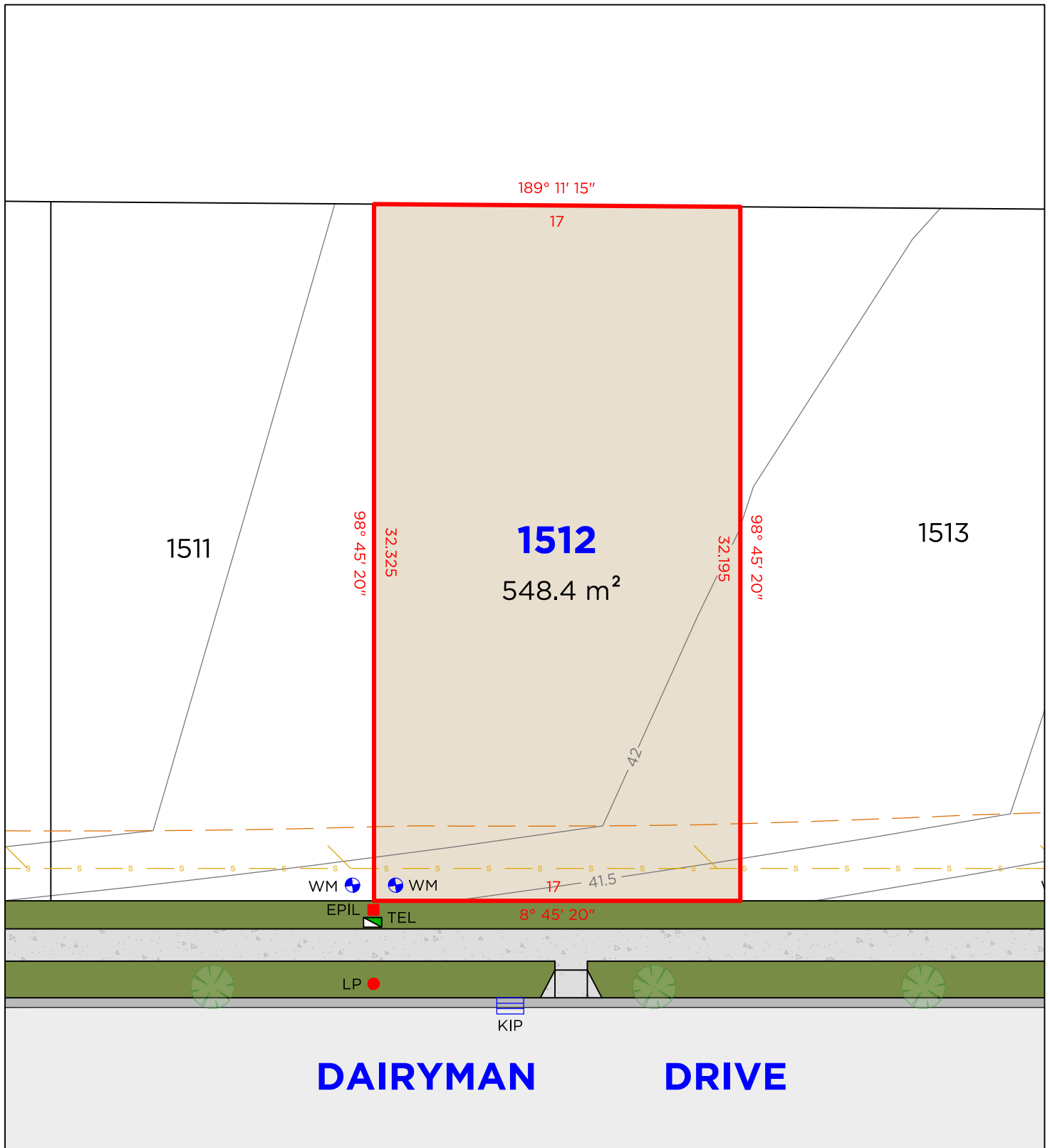

## LEGEND

	BOUNDARY LINE		TEL	TELSTRA / NBN PIT
	ADJACENT BOUNDARY		EPIL	ELECTRICAL PILLAR
	EASEMENT		LP	LIGHT POLE
	SEWER		SMH	SEWER MAN HOLE
	WM		KIP	KERB INLET PIT
	WATER METER			

## DISCLAIMER

1. THIS PLAN HAS BEEN COMPILED FROM DESIGN PLANS AT THE SCALE/S STATED. IT IS RECOMMENDED THAT A SURVEY IS UNDERTAKEN PRIOR TO THE PREPARATION OF CONSTRUCTION DRAWINGS. THE PLAN IS SUITABLE FOR DESIGN ONLY & MAY NOT BE SUITABLE FOR ANY OTHER PURPOSE OR FOR USE AT ANY OTHER SCALES/S.
2. THE BOUNDARIES & SERVICES SHOWN ARE APPROXIMATE ONLY. FURTHER SURVEY WILL BE REQUIRED IF CONSTRUCTION IS TO TAKE PLACE ON OR ADJACENT TO THE BOUNDARIES.

**NOTE** • ANTICIPATED LOT CLASSIFICATION IS H2

**DELFS LASCELLES**  
CONSULTING SURVEYORS





# LOT 1513

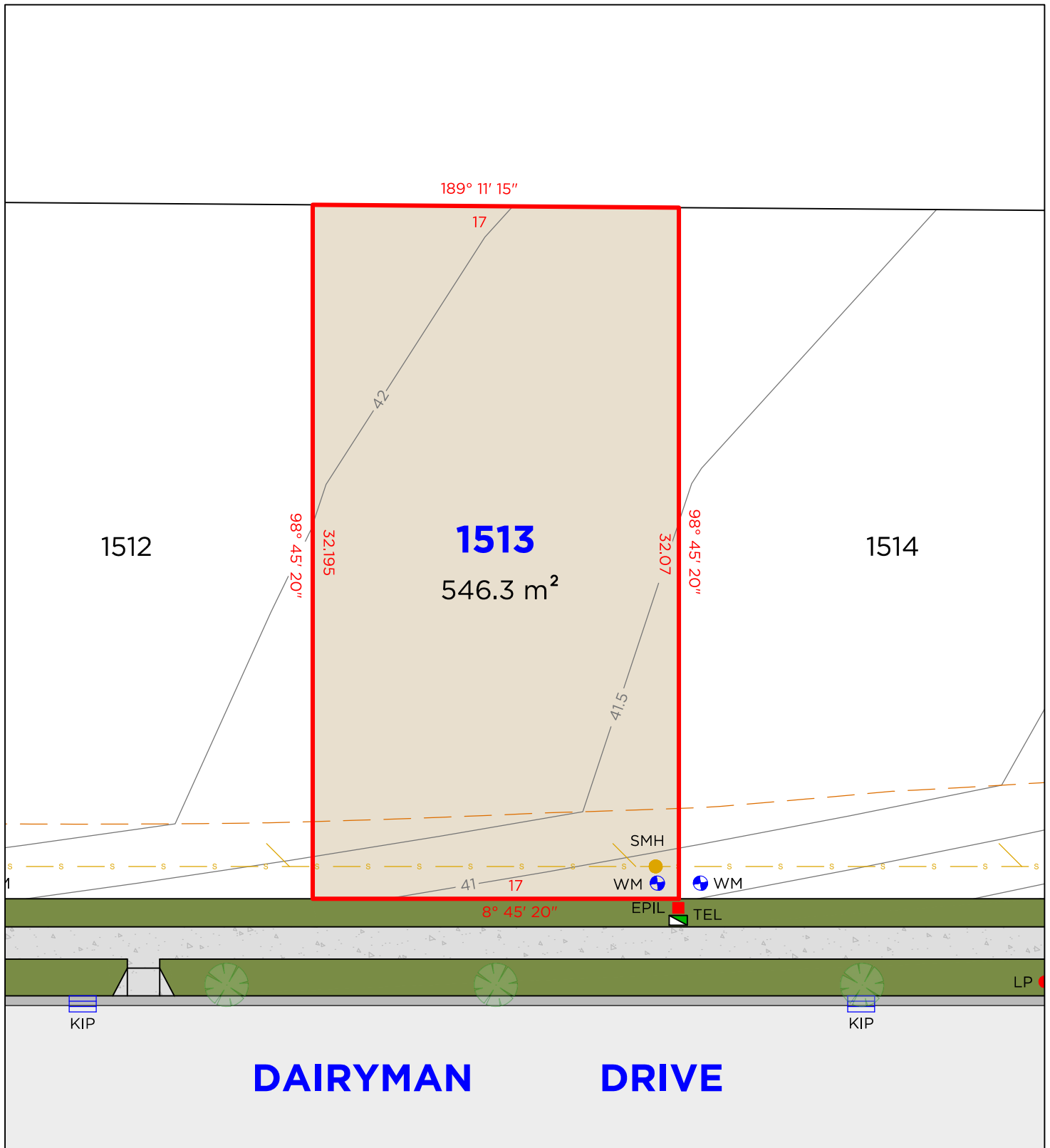

## LEGEND

	BOUNDARY LINE		TEL	TELSTRA / NBN PIT
	ADJACENT BOUNDARY		EPIL	ELECTRICAL PILLAR
	EASEMENT		LP	LIGHT POLE
	SEWER		SMH	SEWER MAN HOLE
	WM		KIP	KERB INLET PIT

## DISCLAIMER

1. THIS PLAN HAS BEEN COMPILED FROM DESIGN PLANS AT THE SCALE/S STATED. IT IS RECOMMENDED THAT A SURVEY IS UNDERTAKEN PRIOR TO THE PREPARATION OF CONSTRUCTION DRAWINGS. THE PLAN IS SUITABLE FOR DESIGN ONLY & MAY NOT BE SUITABLE FOR ANY OTHER PURPOSE OR FOR USE AT ANY OTHER SCALES/S.
2. THE BOUNDARIES & SERVICES SHOWN ARE APPROXIMATE ONLY. FURTHER SURVEY WILL BE REQUIRED IF CONSTRUCTION IS TO TAKE PLACE ON OR ADJACENT TO THE BOUNDARIES.

**NOTE** • ANTICIPATED LOT CLASSIFICATION IS H2

**DELFS**  
**LASCELLES**  
CONSULTING SURVEYORS





# LOT 1514

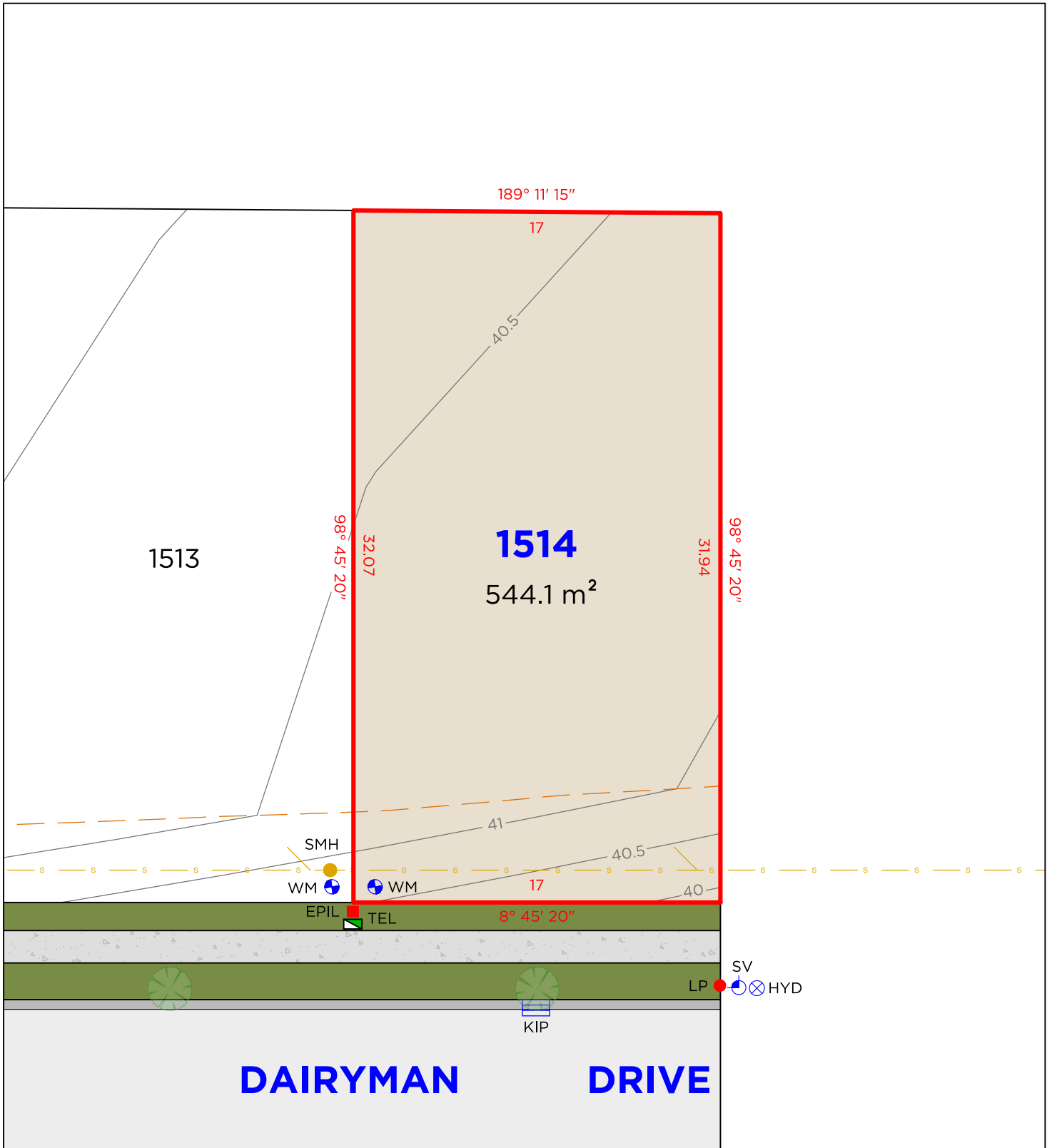

## LEGEND

	BOUNDARY LINE		TEL	TELSTRA / NBN PIT
	ADJACENT BOUNDARY		EPIL	ELECTRICAL PILLAR
	EASEMENT		LP	LIGHT POLE
	SEWER		SMH	SEWER MAN HOLE
	WM		KIP	KERB INLET PIT
	HYD		SV	STOP VALVE
	HYDRANT			

## DISCLAIMER

1. THIS PLAN HAS BEEN COMPILED FROM DESIGN PLANS AT THE SCALE/S STATED. IT IS RECOMMENDED THAT A SURVEY IS UNDERTAKEN PRIOR TO THE PREPARATION OF CONSTRUCTION DRAWINGS. THE PLAN IS SUITABLE FOR DESIGN ONLY & MAY NOT BE SUITABLE FOR ANY OTHER PURPOSE OR FOR USE AT ANY OTHER SCALES/S.
2. THE BOUNDARIES & SERVICES SHOWN ARE APPROXIMATE ONLY. FURTHER SURVEY WILL BE REQUIRED IF CONSTRUCTION IS TO TAKE PLACE ON OR ADJACENT TO THE BOUNDARIES.

**NOTE** • ANTICIPATED LOT CLASSIFICATION IS H2

**DELFS  
LASCELLES**  
CONSULTING SURVEYORS

