

LOT 301, MEADOW STREET, LOCHINVAR



HEREFORD HILL
• LOCHINVAR •

MASTER PLAN



STAGE PLAN



PRELIMINARY SITE ANALYSIS PLAN

SCALE 1:300 @ A4

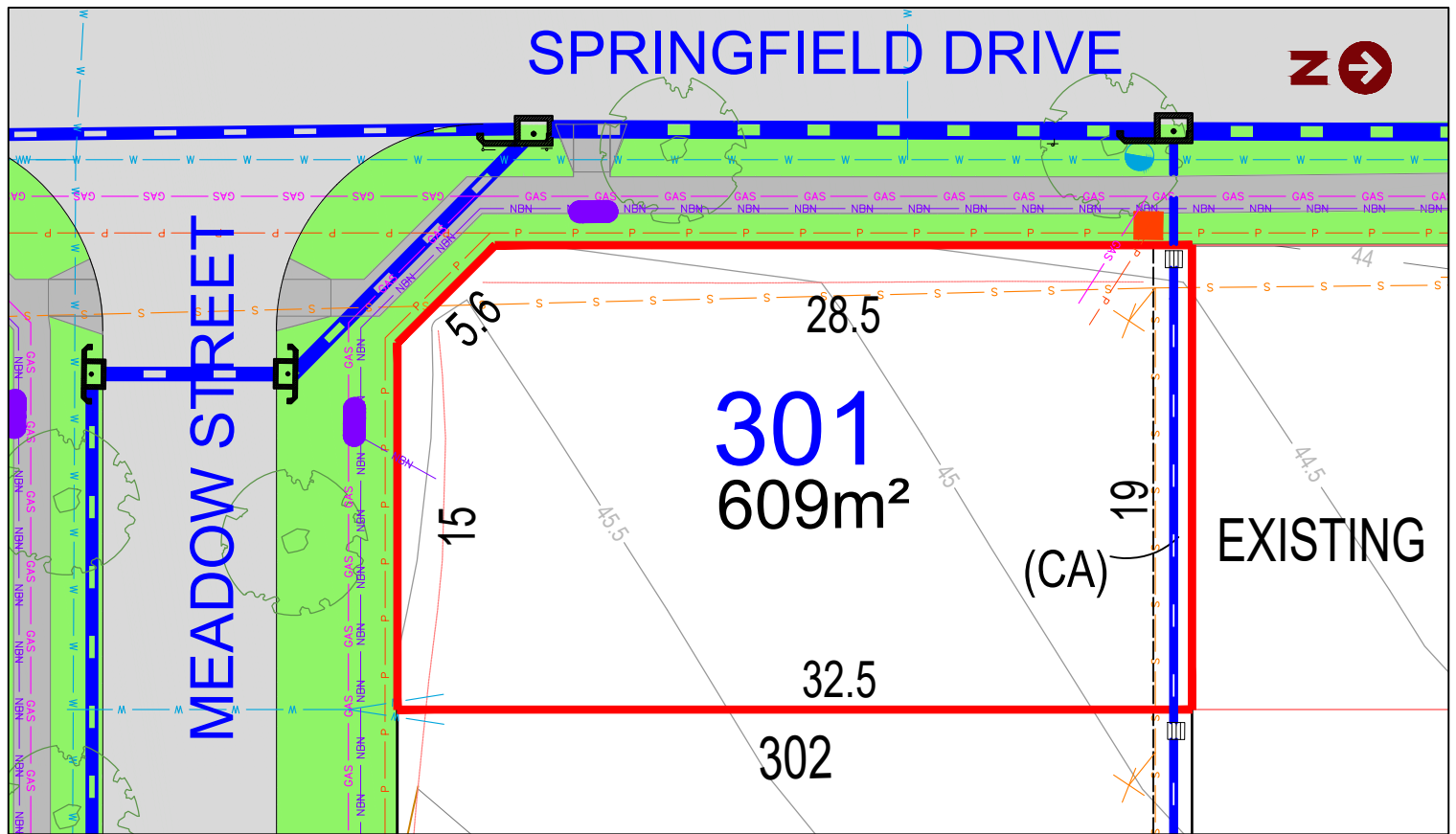
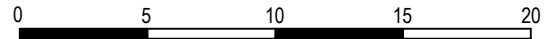

LEGEND:

- TELSTRA /NBN PIT
- HYDRANT
- STOP VALVE
- SEWER MANHOLE
- LIGHT POLE
- KERB INLET PIT
- STORMWATER PIT
- ELECTRICITY PILLAR
- ELECTRICAL SUBSTATION
- STREET TREES
- STORMWATER PIPE
- SEWER JUNCTION
- SEWER MAIN
- GAS
- WATER MAIN
- TELSTRA /NBN
- UNDER GROUND POWER

THE SITE CLASSIFICATION STATED IS TAKEN FROM THE QUALTEST GEOTECHNICAL ASSESSMENT REPORT NEW17P-0054B-AB. DATED 28TH OCTOBER 2020 SECTION 5.1. SITE SPECIFIC CLASSIFICATION SHOULD BE UNDERTAKEN SEPARATELY BY BUILDERS. PRELIMINARY SITE CLASSIFICATION: H2

(CA) EASEMENT TO DRAIN WATER 1.5m WIDE RESTRICTIONS ON USE OF LAND AFFECT THE LOT
RESTRICTIONS ON USE OF LAND AFFECT THE LOT

DISCLAIMER/ NOTES:

1. Contours are based on finished design levels and are subject to construction and Council certification and therefore should not be considered as final or as-built.
2. Location of utility services including but not limited to power, water, sewer, communications and gas are subject to construction and Supply Authority certification and therefore should not be considered as final or as-built.
3. Survey information such as boundary dimensions and areas, easements etc are subject to Final Survey. Purchasers should refer to the Deposited Plan and 88B Instrument contained in the Contract for Sale of Land for further detailed information.
4. Bushfire and Geotechnical classification are provided for convenience. Purchasers should refer to referenced detail specialist reports.
5. This Preliminary Site Analysis Plan has been collated from various sources of design information and is provided for convenience to assist Purchasers in obtaining quotations/tenders for dwelling construction.
6. This document does not form part of the Contract of Sale of the Land.

REVISION/S: HD308 STAGE 3A MARKETING r1

DATE: 23th of November 2020

BY: HIGH DEFINITION DESIGN PTY LTD

LOT 302, MEADOW STREET, LOCHINVAR



HEREFORD HILL
• LOCHINVAR •

MASTER PLAN



STAGE PLAN



PRELIMINARY SITE ANALYSIS PLAN

SCALE 1:400 @ A4

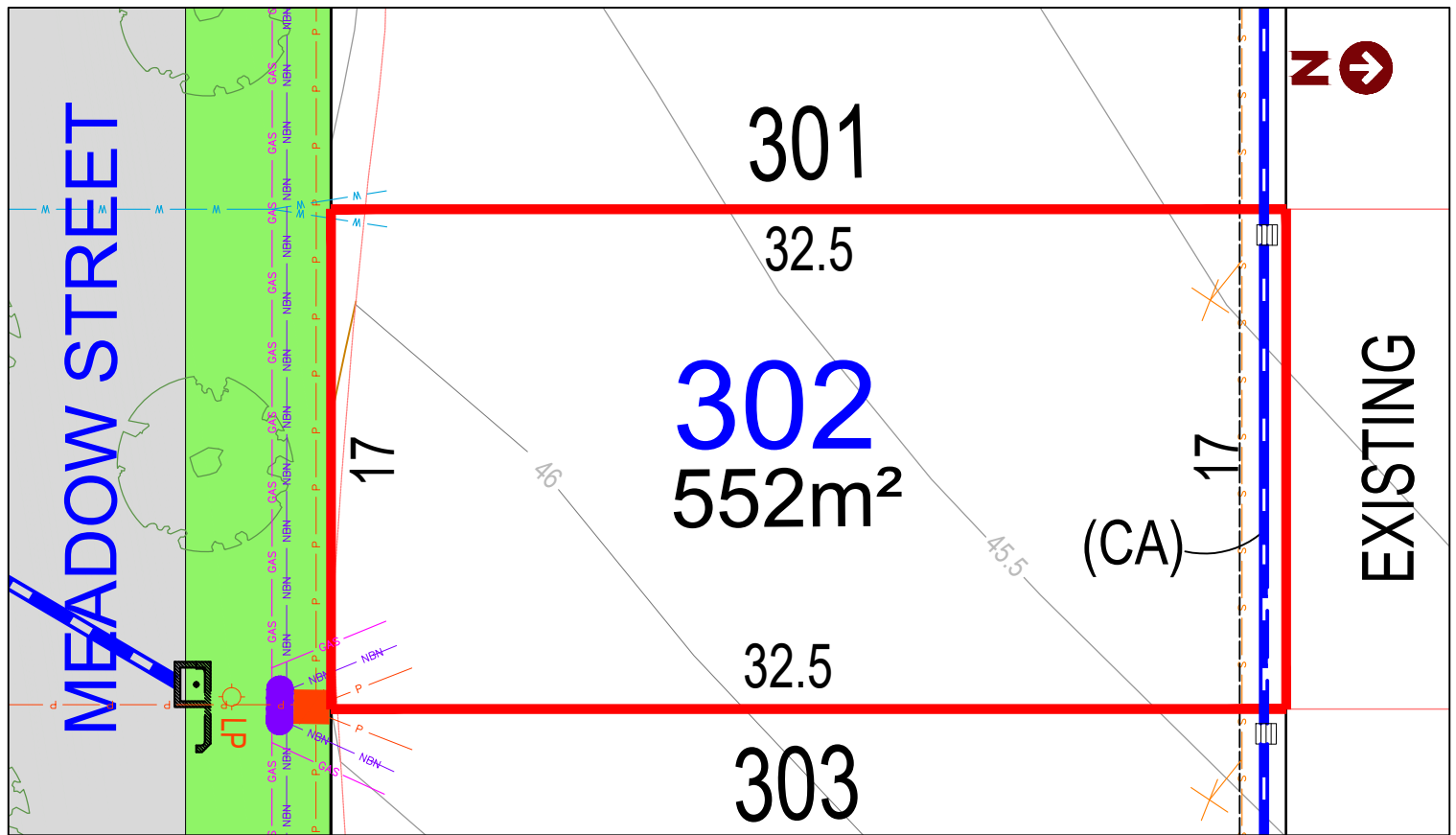
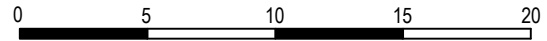

LEGEND:

- TELSTRA /NBN PIT
- HYDRANT
- STOP VALVE
- SEWER MANHOLE
- LIGHT POLE
- KERB INLET PIT
- STORMWATER PIT
- ELECTRICITY PILLAR
- ELECTRICAL SUBSTATION
- STREET TREES
- STORMWATER PIPE
- SEWER JUNCTION
- SEWER MAIN
- GAS
- WATER MAIN
- TELSTRA /NBN
- UNDER GROUND POWER

THE SITE CLASSIFICATION STATED IS TAKEN FROM THE QUALTEST GEOTECHNICAL ASSESSMENT REPORT NEW17P-0054B-AB. DATED 28TH OCTOBER 2020 SECTION 5.1. SITE SPECIFIC CLASSIFICATION SHOULD BE UNDERTAKEN SEPARATELY BY BUILDERS. PRELIMINARY SITE CLASSIFICATION: H2

(CA) EASEMENT TO DRAIN WATER 1.5m WIDE RESTRICTIONS ON USE OF LAND AFFECT THE LOT
RESTRICTIONS ON USE OF LAND AFFECT THE LOT

DISCLAIMER/ NOTES:

1. Contours are based on finished design levels and are subject to construction and Council certification and therefore should not be considered as final or as-built.
2. Location of utility services including but not limited to power, water, sewer, communications and gas are subject to construction and Supply Authority certification and therefore should not be considered as final or as-built.
3. Survey information such as boundary dimensions and areas, easements etc are subject to Final Survey. Purchasers should refer to the Deposited Plan and 88B Instrument contained in the Contract for Sale of Land for further detailed information.
4. Bushfire and Geotechnical classification are provided for convenience. Purchasers should refer to referenced detail specialist reports.
5. This Preliminary Site Analysis Plan has been collated from various sources of design information and is provided for convenience to assist Purchasers in obtaining quotations/tenders for dwelling construction.
6. This document does not form part of the Contract of Sale of the Land.

REVISION/S: HD308 STAGE 3A MARKETING r1

DATE: 23th of November 2020

BY: HIGH DEFINITION DESIGN PTY LTD

LOT 303, MEADOW STREET, LOCHINVAR



HEREFORD HILL
• LOCHINVAR •

MASTER PLAN



STAGE PLAN



PRELIMINARY SITE ANALYSIS PLAN

SCALE 1:400 @ A4

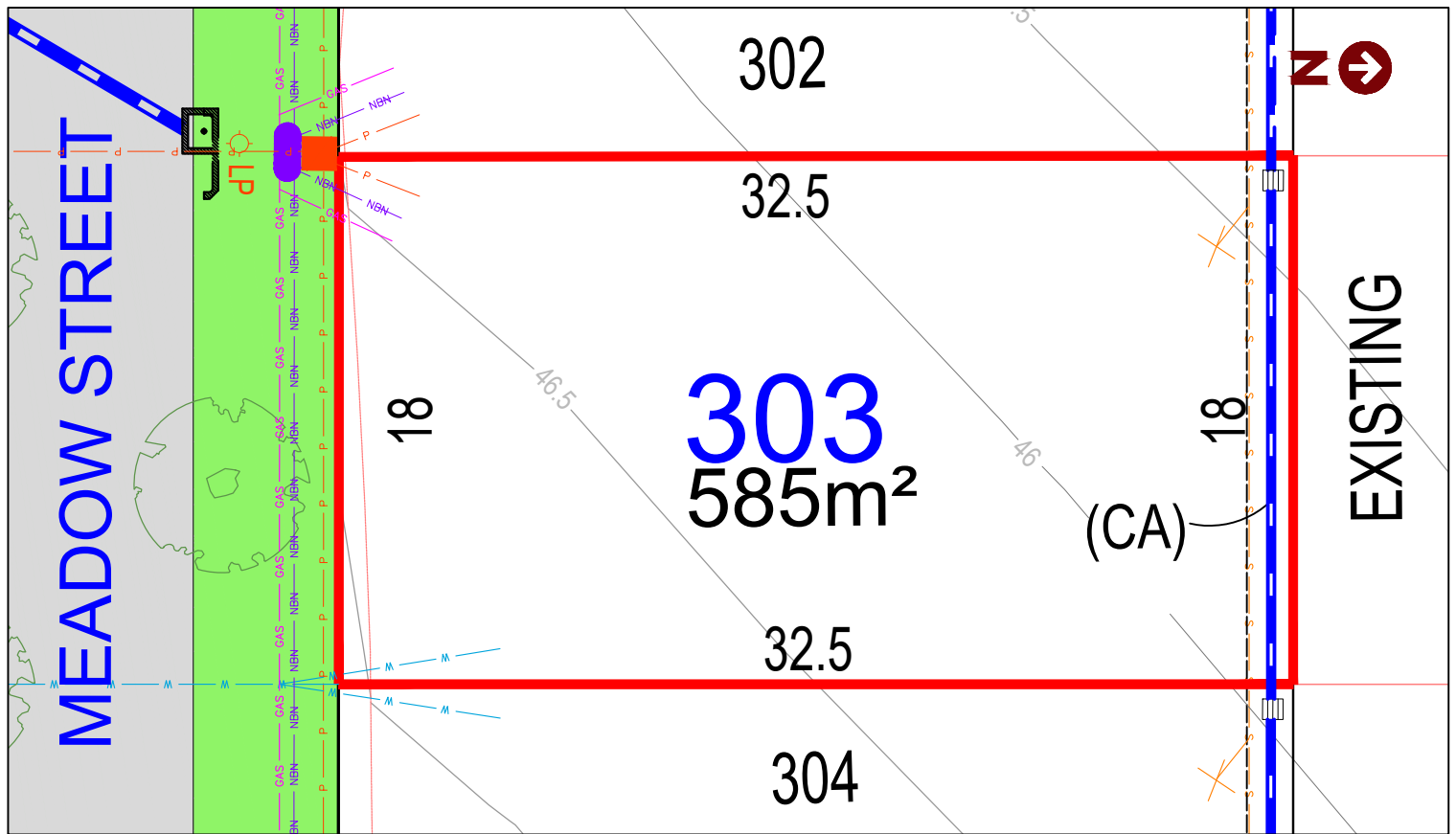
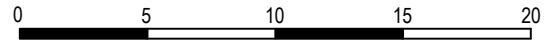

LEGEND:

- TELSTRA /NBN PIT
- HYDRANT
- STOP VALVE
- SEWER MANHOLE
- LIGHT POLE
- KERB INLET PIT
- STORMWATER PIT
- ELECTRICITY PILLAR
- ELECTRICAL SUBSTATION
- STREET TREES
- STORMWATER PIPE
- SEWER JUNCTION
- SEWER MAIN
- GAS
- WATER MAIN
- TELSTRA /NBN
- UNDER GROUND POWER

THE SITE CLASSIFICATION STATED IS TAKEN FROM THE QUALTEST GEOTECHNICAL ASSESSMENT REPORT NEW17P-0054B-AB. DATED 28TH OCTOBER 2020 SECTION 5.1. SITE SPECIFIC CLASSIFICATION SHOULD BE UNDERTAKEN SEPARATELY BY BUILDERS. PRELIMINARY SITE CLASSIFICATION: H2

(CA) EASEMENT TO DRAIN WATER 1.5m WIDE RESTRICTIONS ON USE OF LAND AFFECT THE LOT
RESTRICTIONS ON USE OF LAND AFFECT THE LOT

DISCLAIMER/ NOTES:

1. Contours are based on finished design levels and are subject to construction and Council certification and therefore should not be considered as final or as-built.
2. Location of utility services including but not limited to power, water, sewer, communications and gas are subject to construction and Supply Authority certification and therefore should not be considered as final or as-built.
3. Survey information such as boundary dimensions and areas, easements etc are subject to Final Survey. Purchasers should refer to the Deposited Plan and 88B Instrument contained in the Contract for Sale of Land for further detailed information.
4. Bushfire and Geotechnical classification are provided for convenience. Purchasers should refer to referenced detail specialist reports.
5. This Preliminary Site Analysis Plan has been collated from various sources of design information and is provided for convenience to assist Purchasers in obtaining quotations/tenders for dwelling construction.
6. This document does not form part of the Contract of Sale of the Land.

REVISION/S: HD308 STAGE 3A MARKETING r1

DATE: 23th of November 2020

BY: HIGH DEFINITION DESIGN PTY LTD

LOT 304, MEADOW STREET, LOCHINVAR



HEREFORD HILL
• LOCHINVAR •

MASTER PLAN



STAGE PLAN



PRELIMINARY SITE ANALYSIS PLAN

SCALE 1:400 @ A4

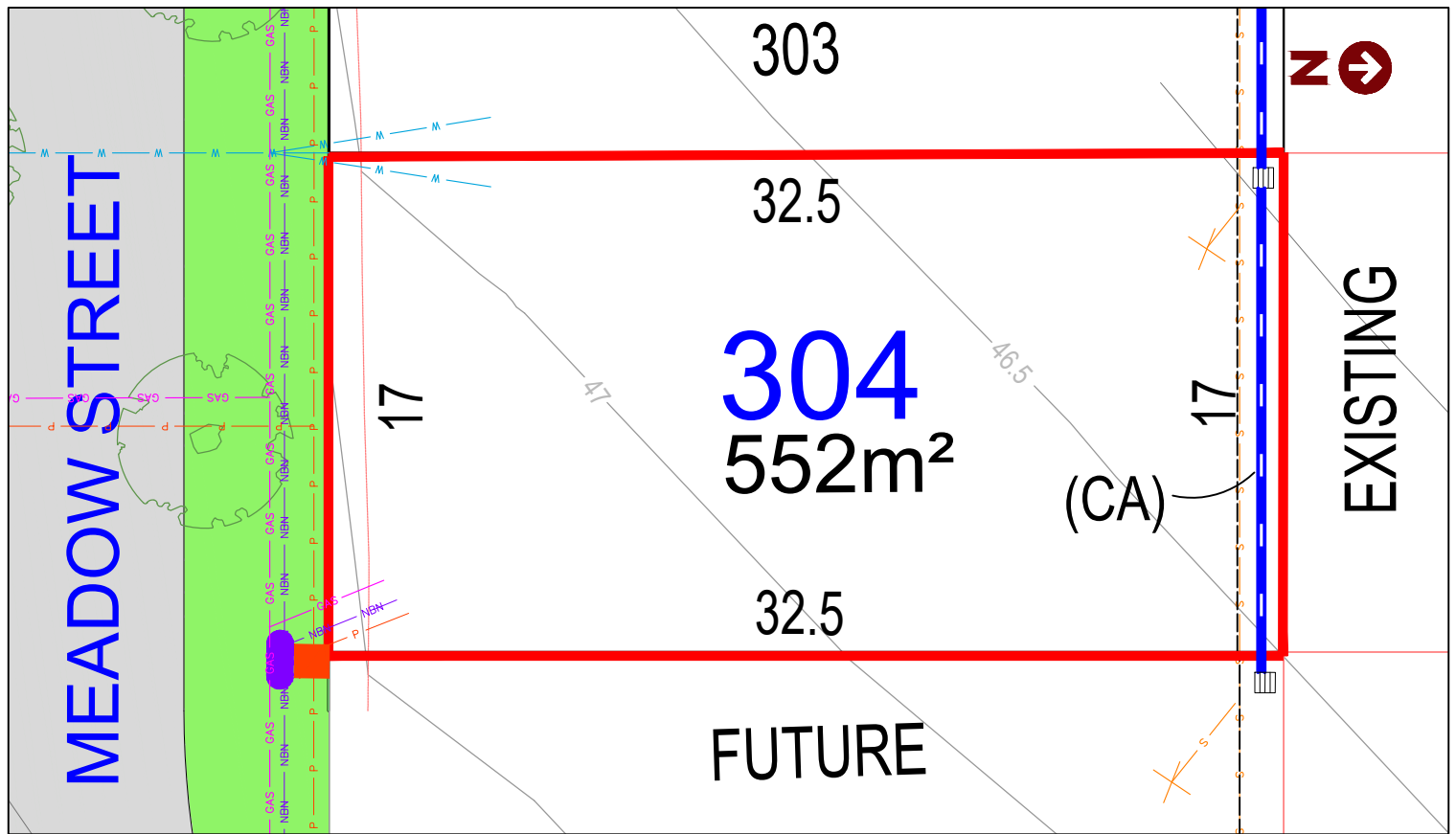
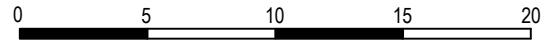

LEGEND:

- TELSTRA /NBN PIT
- HYDRANT
- STOP VALVE
- SEWER MANHOLE
- LIGHT POLE
- KERB INLET PIT
- STORMWATER PIT
- ELECTRICITY PILLAR
- ELECTRICAL SUBSTATION
- STREET TREES
- STORMWATER PIPE
- SEWER JUNCTION
- SEWER MAIN
- GAS
- WATER MAIN
- TELSTRA /NBN
- UNDER GROUND POWER

THE SITE CLASSIFICATION STATED IS TAKEN FROM THE QUALTEST GEOTECHNICAL ASSESSMENT REPORT NEW17P-0054B-AB. DATED 28TH OCTOBER 2020 SECTION 5.1. SITE SPECIFIC CLASSIFICATION SHOULD BE UNDERTAKEN SEPARATELY BY BUILDERS. PRELIMINARY SITE CLASSIFICATION: H2

(CA) EASEMENT TO DRAIN WATER 1.5m WIDE RESTRICTIONS ON USE OF LAND AFFECT THE LOT
RESTRICTIONS ON USE OF LAND AFFECT THE LOT

DISCLAIMER/ NOTES:

1. Contours are based on finished design levels and are subject to construction and Council certification and therefore should not be considered as final or as-built.
2. Location of utility services including but not limited to power, water, sewer, communications and gas are subject to construction and Supply Authority certification and therefore should not be considered as final or as-built.
3. Survey information such as boundary dimensions and areas, easements etc are subject to Final Survey. Purchasers should refer to the Deposited Plan and 88B Instrument contained in the Contract for Sale of Land for further detailed information.
4. Bushfire and Geotechnical classification are provided for convenience. Purchasers should refer to referenced detail specialist reports.
5. This Preliminary Site Analysis Plan has been collated from various sources of design information and is provided for convenience to assist Purchasers in obtaining quotations/tenders for dwelling construction.
6. This document does not form part of the Contract of Sale of the Land.

REVISION/S: HD308 STAGE 3A MARKETING r1

DATE: 23th of November 2020

BY: HIGH DEFINITION DESIGN PTY LTD

LOT 305, MEADOW STREET, LOCHINVAR



HEREFORD HILL
• LOCHINVAR •

MASTER PLAN



STAGE PLAN



PRELIMINARY SITE ANALYSIS PLAN

SCALE 1:400 @ A4

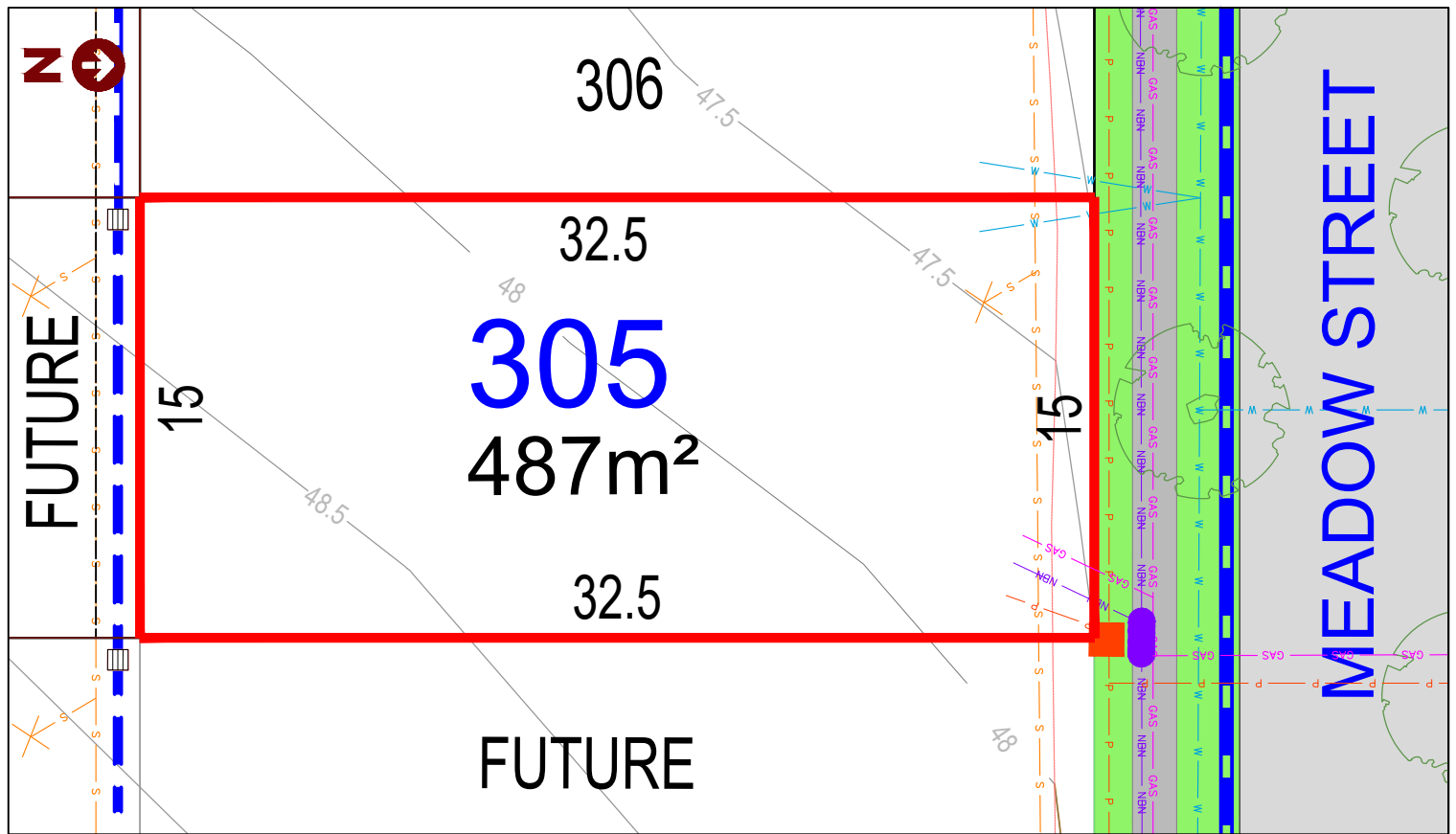
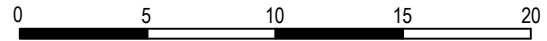

LEGEND:

- TELSTRA /NBN PIT
- HYDRANT
- STOP VALVE
- SEWER MANHOLE
- LIGHT POLE
- KERB INLET PIT
- STORMWATER PIT
- ELECTRICITY PILLAR
- ELECTRICAL SUBSTATION
- STREET TREES
- STORMWATER PIPE
- SEWER JUNCTION
- SEWER MAIN
- GAS
- WATER MAIN
- TELSTRA /NBN
- UNDER GROUND POWER

THE SITE CLASSIFICATION STATED IS TAKEN FROM THE QUALTEST GEOTECHNICAL ASSESSMENT REPORT NEW17P-0054B-AB. DATED 28TH OCTOBER 2020 SECTION 5.1. SITE SPECIFIC CLASSIFICATION SHOULD BE UNDERTAKEN SEPARATELY BY BUILDERS. PRELIMINARY SITE CLASSIFICATION: H2

(CA) EASEMENT TO DRAIN WATER 1.5m WIDE RESTRICTIONS ON USE OF LAND AFFECT THE LOT
RESTRICTIONS ON USE OF LAND AFFECT THE LOT

DISCLAIMER/ NOTES:

1. Contours are based on finished design levels and are subject to construction and Council certification and therefore should not be considered as final or as-built.
2. Location of utility services including but not limited to power, water, sewer, communications and gas are subject to construction and Supply Authority certification and therefore should not be considered as final or as-built.
3. Survey information such as boundary dimensions and areas, easements etc are subject to Final Survey. Purchasers should refer to the Deposited Plan and 88B Instrument contained in the Contract for Sale of Land for further detailed information.
4. Bushfire and Geotechnical classification are provided for convenience. Purchasers should refer to referenced detail specialist reports.
5. This Preliminary Site Analysis Plan has been collated from various sources of design information and is provided for convenience to assist Purchasers in obtaining quotations/tenders for dwelling construction.
6. This document does not form part of the Contract of Sale of the Land.

REVISION/S: HD308 STAGE 3A MARKETING r1

DATE: 23th of November 2020

BY: HIGH DEFINITION DESIGN PTY LTD

HEREFORD-HILL.com.au



LOT 306, MEADOW STREET, LOCHINVAR



HEREFORD HILL
• LOCHINVAR •

MASTER PLAN



STAGE PLAN



PRELIMINARY SITE ANALYSIS PLAN

SCALE 1:400 @ A4

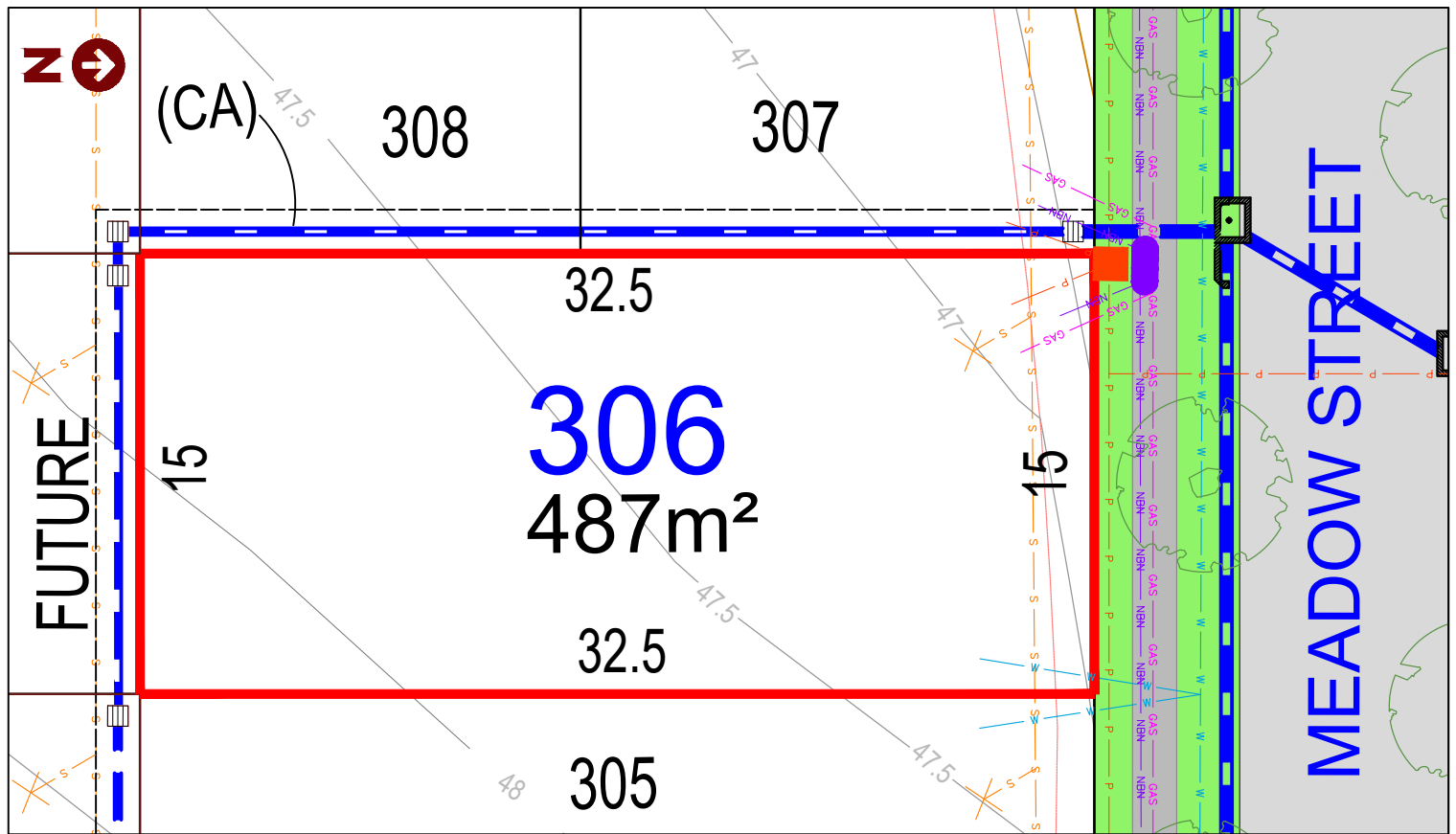
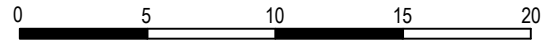

LEGEND:

- TELSTRA /NBN PIT
- HYDRANT
- STOP VALVE
- SEWER MANHOLE
- LIGHT POLE
- KERB INLET PIT
- STORMWATER PIT
- ELECTRICITY PILLAR
- ELECTRICAL SUBSTATION
- STREET TREES
- STORMWATER PIPE
- SEWER JUNCTION
- SEWER MAIN
- GAS
- WATER MAIN
- TELSTRA /NBN
- UNDER GROUND POWER

THE SITE CLASSIFICATION STATED IS TAKEN FROM THE QUALTEST GEOTECHNICAL ASSESSMENT REPORT NEW17P-0054B-AB. DATED 28TH OCTOBER 2020 SECTION 5.1. SITE SPECIFIC CLASSIFICATION SHOULD BE UNDERTAKEN SEPARATELY BY BUILDERS. PRELIMINARY SITE CLASSIFICATION: H2

(CA) EASEMENT TO DRAIN WATER 1.5m WIDE RESTRICTIONS ON USE OF LAND AFFECT THE LOT
RESTRICTIONS ON USE OF LAND AFFECT THE LOT

DISCLAIMER/ NOTES:

1. Contours are based on finished design levels and are subject to construction and Council certification and therefore should not be considered as final or as-built.
2. Location of utility services including but not limited to power, water, sewer, communications and gas are subject to construction and Supply Authority certification and therefore should not be considered as final or as-built.
3. Survey information such as boundary dimensions and areas, easements etc are subject to Final Survey. Purchasers should refer to the Deposited Plan and 88B Instrument contained in the Contract for Sale of Land for further detailed information.
4. Bushfire and Geotechnical classification are provided for convenience. Purchasers should refer to referenced detail specialist reports.
5. This Preliminary Site Analysis Plan has been collated from various sources of design information and is provided for convenience to assist Purchasers in obtaining quotations/tenders for dwelling construction.
6. This document does not form part of the Contract of Sale of the Land.

REVISION/S: HD308 STAGE 3A MARKETING r1

DATE: 23th of November 2020

BY: HIGH DEFINITION DESIGN PTY LTD

LOT 307, MEADOW STREET, LOCHINVAR



HEREFORD HILL
• LOCHINVAR •

MASTER PLAN



STAGE PLAN



PRELIMINARY SITE ANALYSIS PLAN

SCALE 1:300 @ A4

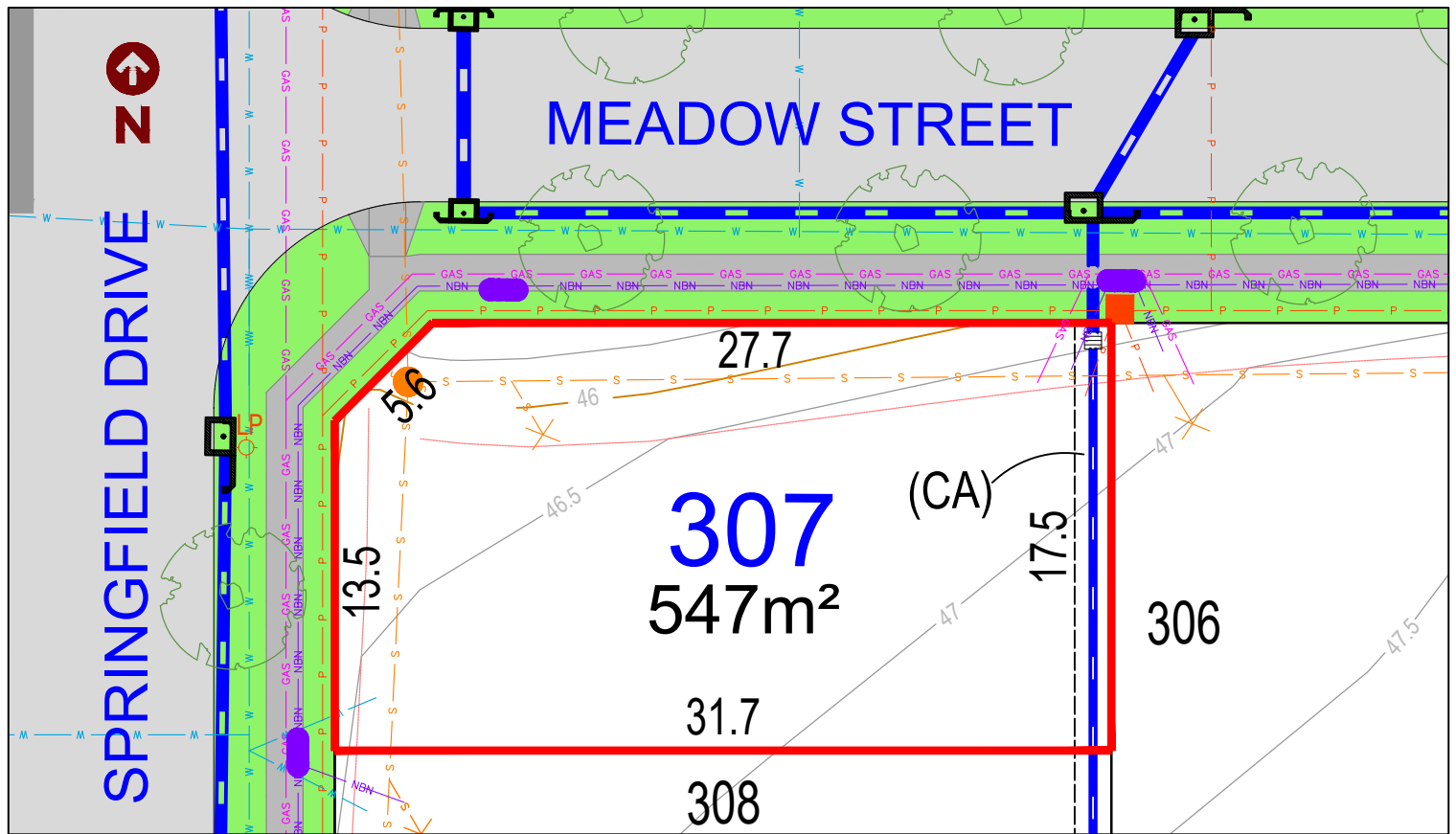
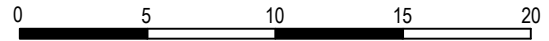

LEGEND:

- TELSTRA /NBN PIT
- HYDRANT
- STOP VALVE
- SEWER MANHOLE
- LIGHT POLE
- KERB INLET PIT
- STORMWATER PIT
- ELECTRICITY PILLAR
- ELECTRICAL SUBSTATION
- STREET TREES
- STORMWATER PIPE
- SEWER JUNCTION
- SEWER MAIN
- GAS
- WATER MAIN
- TELSTRA /NBN
- UNDER GROUND POWER

THE SITE CLASSIFICATION STATED IS TAKEN FROM THE QUALTEST GEOTECHNICAL ASSESSMENT REPORT NEW17P-0054B-AB. DATED 28TH OCTOBER 2020 SECTION 5.1. SITE SPECIFIC CLASSIFICATION SHOULD BE UNDERTAKEN SEPARATELY BY BUILDERS. PRELIMINARY SITE CLASSIFICATION: H2

(CA) EASEMENT TO DRAIN WATER 1.5m WIDE RESTRICTIONS ON USE OF LAND AFFECT THE LOT
RESTRICTIONS ON USE OF LAND AFFECT THE LOT

DISCLAIMER/ NOTES:

1. Contours are based on finished design levels and are subject to construction and Council certification and therefore should not be considered as final or as-built.
2. Location of utility services including but not limited to power, water, sewer, communications and gas are subject to construction and Supply Authority certification and therefore should not be considered as final or as-built.
3. Survey information such as boundary dimensions and areas, easements etc are subject to Final Survey. Purchasers should refer to the Deposited Plan and 88B Instrument contained in the Contract for Sale of Land for further detailed information.
4. Bushfire and Geotechnical classification are provided for convenience. Purchasers should refer to referenced detail specialist reports.
5. This Preliminary Site Analysis Plan has been collated from various sources of design information and is provided for convenience to assist Purchasers in obtaining quotations/tenders for dwelling construction.
6. This document does not form part of the Contract of Sale of the Land.

REVISION/S: HD308 STAGE 3A MARKETING r1

DATE: 23th of November 2020

BY: HIGH DEFINITION DESIGN PTY LTD

LOT 308, SPRINGFIELD DRIVE, LOCHINVAR



HEREFORD HILL
• LOCHINVAR •

MASTER PLAN



STAGE PLAN



PRELIMINARY SITE ANALYSIS PLAN

SCALE 1:400 @ A4

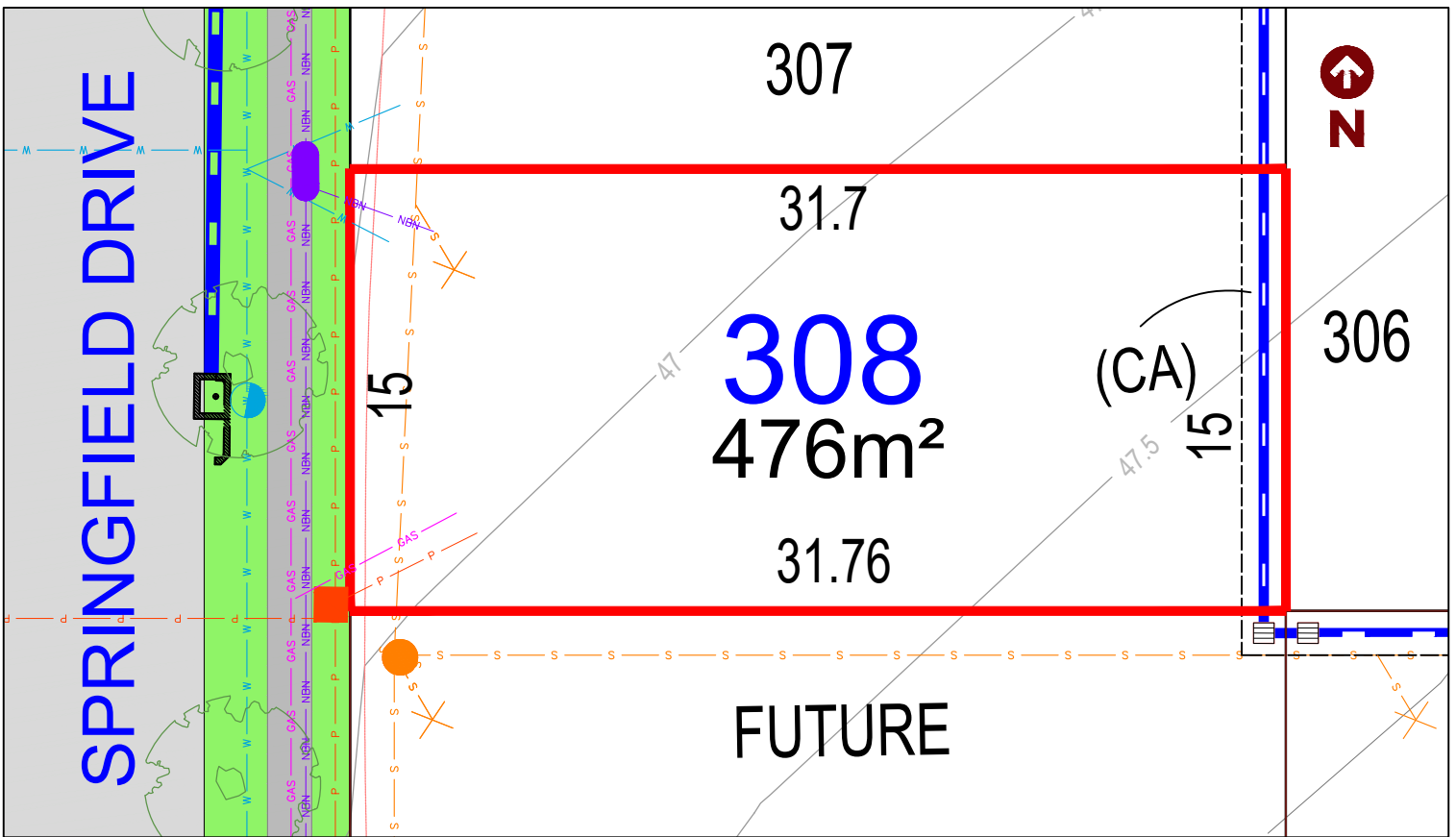
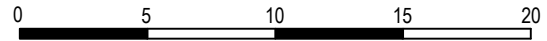

LEGEND:

- TELSTRA /NBN PIT
- HYDRANT
- STOP VALVE
- SEWER MANHOLE
- LIGHT POLE
- KERB INLET PIT
- STORMWATER PIT
- ELECTRICITY PILLAR
- ELECTRICAL SUBSTATION
- STREET TREES
- STORMWATER PIPE
- SEWER JUNCTION
- SEWER MAIN
- GAS
- WATER MAIN
- TELSTRA /NBN
- UNDER GROUND POWER

THE SITE CLASSIFICATION STATED IS TAKEN FROM THE QUALTEST GEOTECHNICAL ASSESSMENT REPORT NEW17P-0054B-AB. DATED 28TH OCTOBER 2020 SECTION 5.1. SITE SPECIFIC CLASSIFICATION SHOULD BE UNDERTAKEN SEPARATELY BY BUILDERS. PRELIMINARY SITE CLASSIFICATION: H2

(CA) EASEMENT TO DRAIN WATER 1.5m WIDE RESTRICTIONS ON USE OF LAND AFFECT THE LOT
RESTRICTIONS ON USE OF LAND AFFECT THE LOT

DISCLAIMER/ NOTES:

1. Contours are based on finished design levels and are subject to construction and Council certification and therefore should not be considered as final or as-built.
2. Location of utility services including but not limited to power, water, sewer, communications and gas are subject to construction and Supply Authority certification and therefore should not be considered as final or as-built.
3. Survey information such as boundary dimensions and areas, easements etc are subject to Final Survey. Purchasers should refer to the Deposited Plan and 88B Instrument contained in the Contract for Sale of Land for further detailed information.
4. Bushfire and Geotechnical classification are provided for convenience. Purchasers should refer to referenced detail specialist reports.
5. This Preliminary Site Analysis Plan has been collated from various sources of design information and is provided for convenience to assist Purchasers in obtaining quotations/tenders for dwelling construction.
6. This document does not form part of the Contract of Sale of the Land.

REVISION/S: HD308 STAGE 3A MARKETING r1

DATE: 23th of November 2020

BY: HIGH DEFINITION DESIGN PTY LTD

LOT 309, SPRINGFIELD DRIVE, LOCHINVAR



HEREFORD HILL
• LOCHINVAR •

MASTER PLAN



STAGE PLAN



PRELIMINARY SITE ANALYSIS PLAN

SCALE 1:250 @ A4

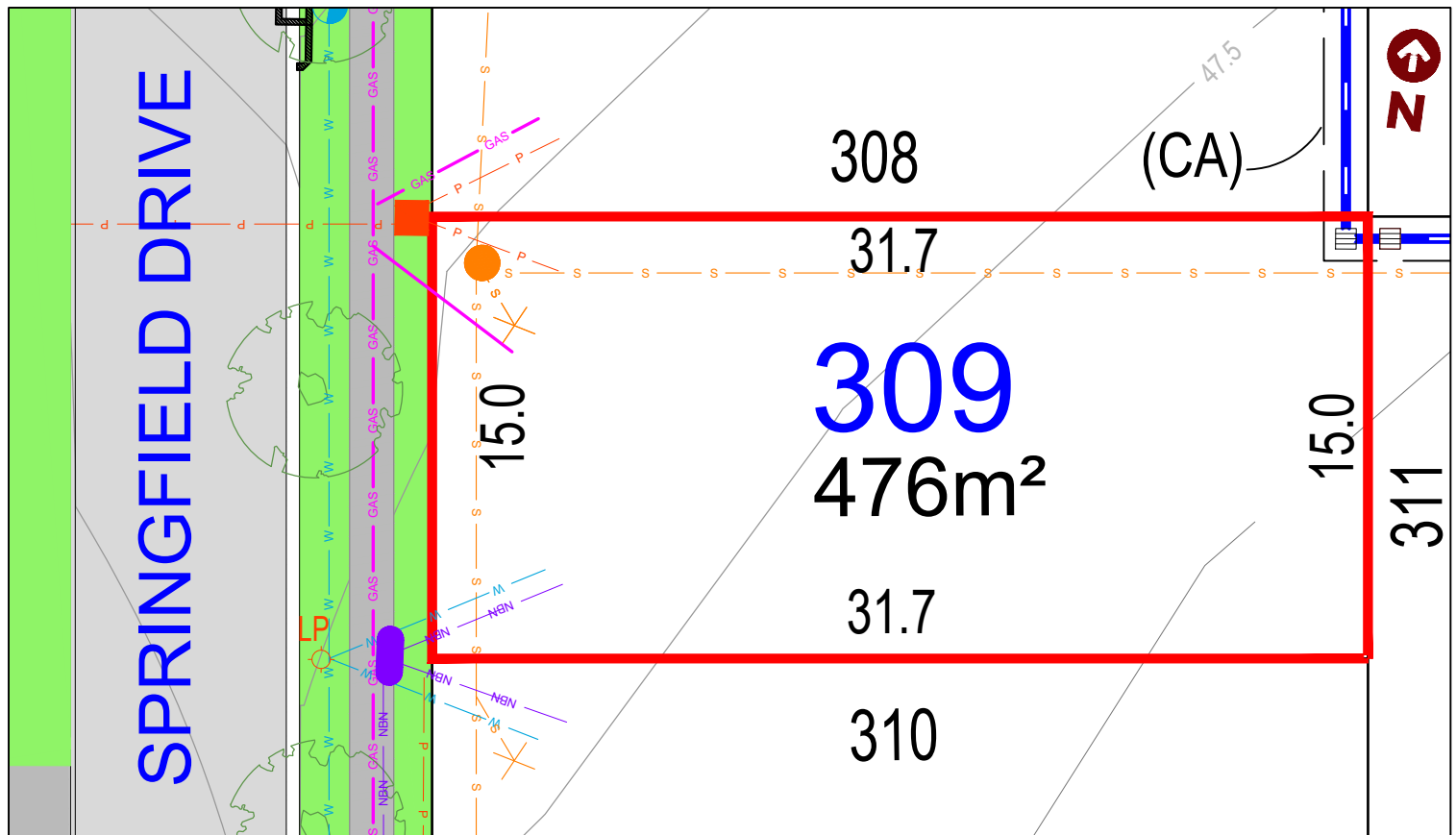
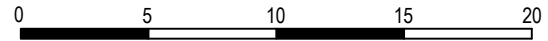

LEGEND:

	TELSTRA /NBN PIT		STORMWATER PIPE
	HYDRANT		SEWER JUNCTION
	STOP VALVE		SEWER MAIN
	SEWER MANHOLE		GAS
	LIGHT POLE		WATER MAIN
	KERB INLET PIT		TELSTRA /NBN
	STORMWATER PIT		UNDER GROUND POWER
	ELECTRICITY PILLAR		
	ELECTRICAL SUBSTATION		
	STREET TREES		

Anticipated Site Classification - H1 Class
(to be confirmed at completion of construction)

(CA) EASEMENT TO DRAIN WATER 1.5m WIDE
RESTRICTIONS ON USE OF LAND AFFECT THE LOT

DISCLAIMER/ NOTES:

1. Contours are based on finished design levels and are subject to construction and Council certification and therefore should not be considered as final or as-built.
2. Location of utility services including but not limited to power, water, sewer, communications and gas are subject to construction and Supply Authority certification and therefore should not be considered as final or as-built.
3. Survey information such as boundary dimensions and areas, easements etc are subject to Final Survey. Purchasers should refer to the Deposited Plan and 88B Instrument contained in the Contract for Sale of Land for further detailed information.
4. Bushfire and Geotechnical classification are provided for convenience. Purchasers should refer to referenced detail specialist reports.
5. This Preliminary Site Analysis Plan has been collated from various sources of design information and is provided for convenience to assist Purchasers in obtaining quotations/tenders for dwelling construction.
6. This document does not form part of the Contract of Sale of the Land.

REVISION/S: HD308 STAGE 3B MARKETING r1

DATE: 3rd of February 2021

BY: HIGH DEFINITION DESIGN PTY LTD

LOT 310, SPRINGFIELD DRIVE, LOCHINVAR



HEREFORD HILL
• LOCHINVAR •

MASTER PLAN



STAGE PLAN



PRELIMINARY SITE ANALYSIS PLAN

SCALE 1:300 @ A4

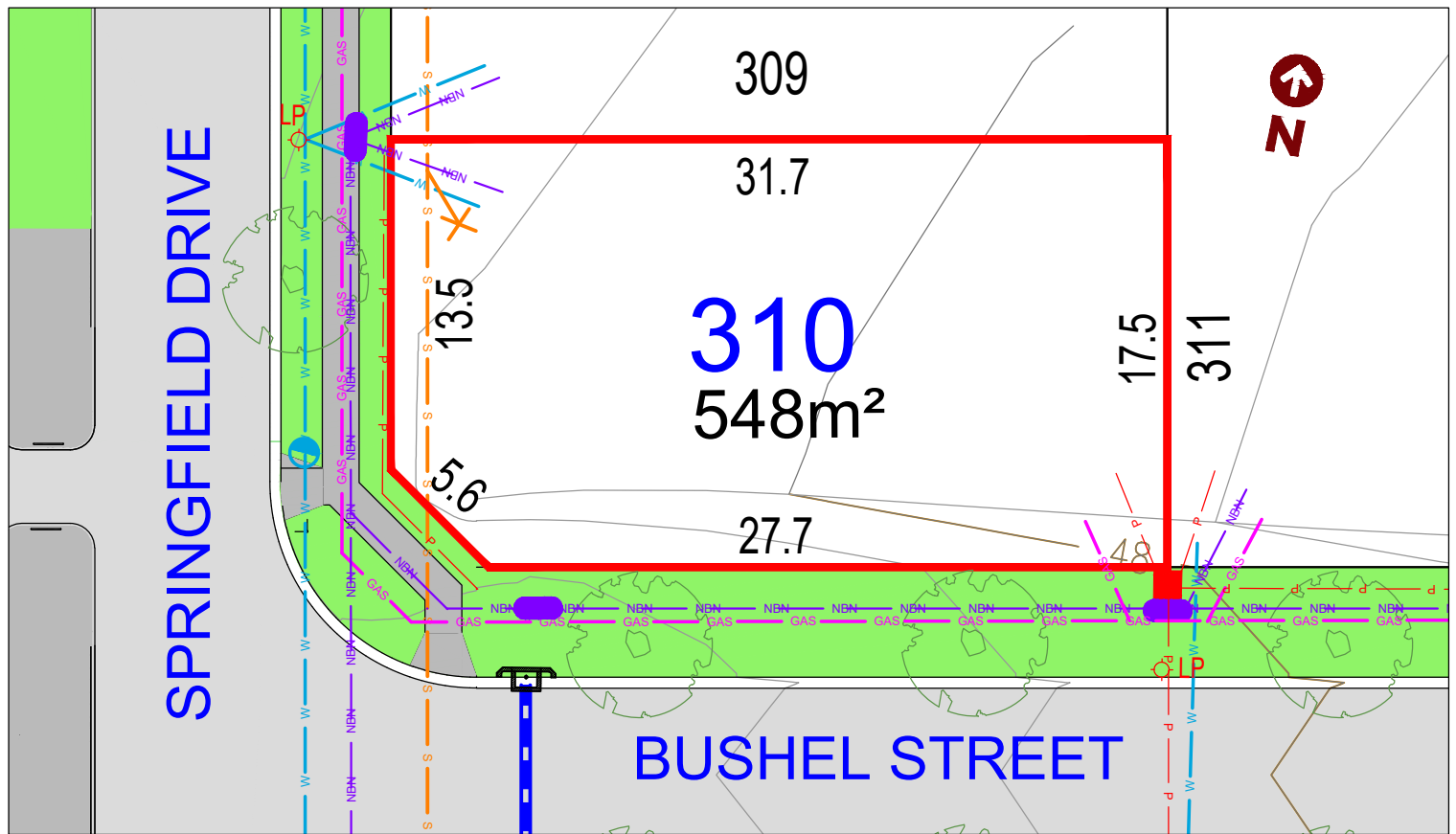
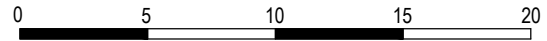

LEGEND:

- TELSTRA /NBN PIT
 - HYDRANT
 - STOP VALVE
 - SEWER MANHOLE
 - LIGHT POLE
 - KERB INLET PIT
 - STORMWATER PIT
 - ELECTRICITY PILLAR
 - ELECTRICAL SUBSTATION
 - STREET TREES
 - STORMWATER PIPE
 - SEWER MAIN
 - GAS
 - WATER MAIN
 - TELSTRA /NBN
 - UNDER GROUND POWER
 - SEWER JUNCTION
- Anticipated Site Classification - H1 Class
(to be confirmed at completion of construction)
- (CA) EASEMENT TO DRAIN WATER 1.5m WIDE
RESTRICTIONS ON USE OF LAND AFFECT THE LOT

DISCLAIMER/ NOTES:

1. Contours are based on finished design levels and are subject to construction and Council certification and therefore should not be considered as final or as-built.
2. Location of utility services including but not limited to power, water, sewer, communications and gas are subject to construction and Supply Authority certification and therefore should not be considered as final or as-built.
3. Survey information such as boundary dimensions and areas, easements etc are subject to Final Survey. Purchasers should refer to the Deposited Plan and 88B Instrument contained in the Contract for Sale of Land for further detailed information.
4. Bushfire and Geotechnical classification are provided for convenience. Purchasers should refer to referenced detail specialist reports.
5. This Preliminary Site Analysis Plan has been collated from various sources of design information and is provided for convenience to assist Purchasers in obtaining quotations/tenders for dwelling construction.
6. This document does not form part of the Contract of Sale of the Land.

REVISIONS: HD308 STAGE 3B MARKETING r1

DATE: 3rd of February 2021

BY: HIGH DEFINITION DESIGN PTY LTD

LOT 311, BUSHEL STREET, LOCHINVAR



HEREFORD HILL
• LOCHINVAR •

MASTER PLAN



STAGE PLAN

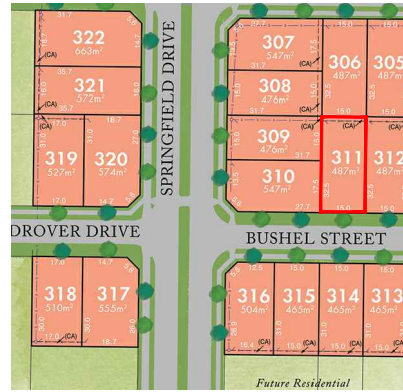

PRELIMINARY SITE ANALYSIS PLAN

SCALE 1:250 @ A4

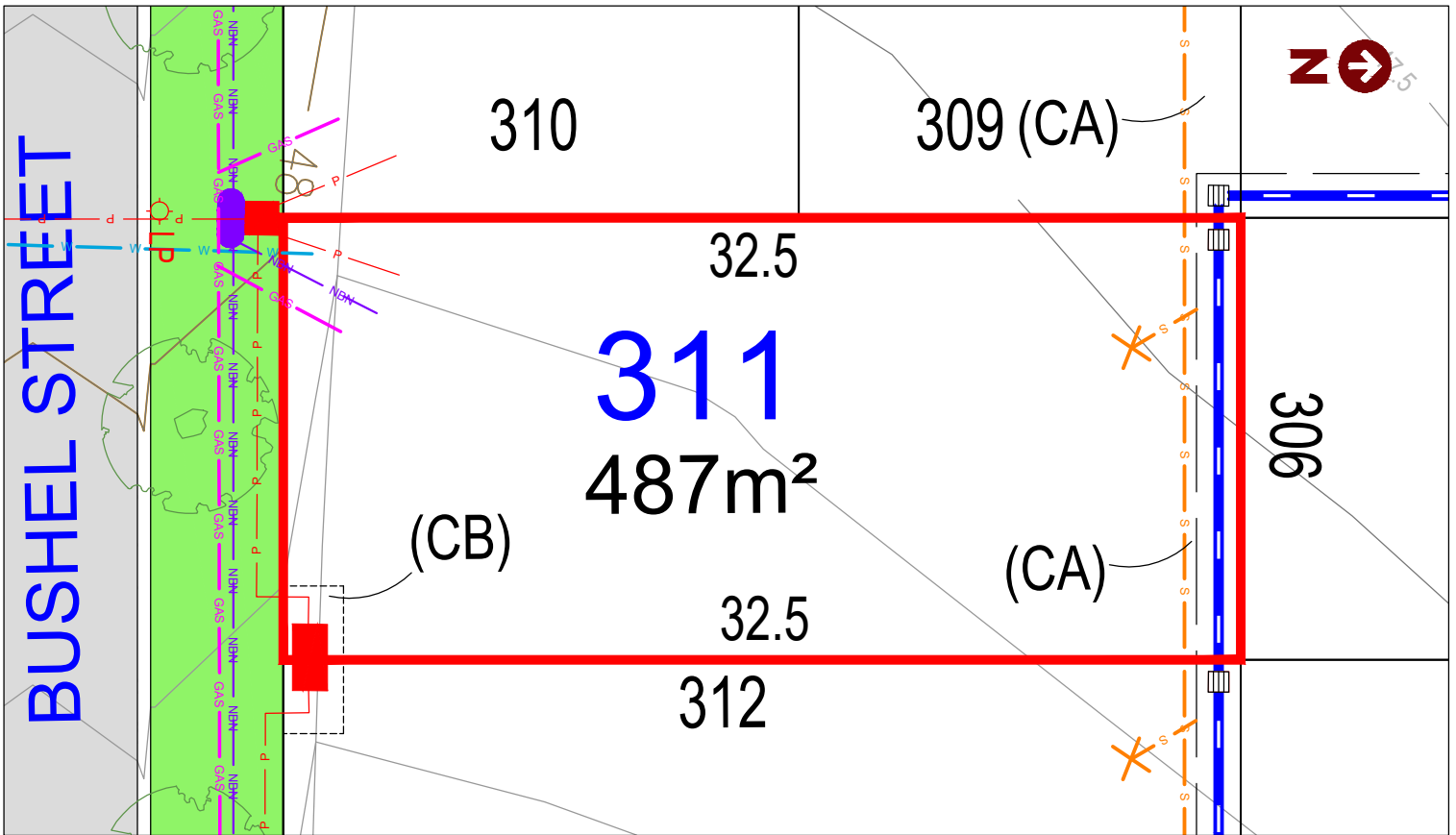
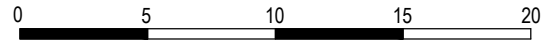

LEGEND:

- | | | | |
|--|-----------------------|--|--------------------|
| | TELSTRA /NBN PIT | | STORMWATER PIPE |
| | HYDRANT | | SEWER JUNCTION |
| | STOP VALVE | | SEWER MAIN |
| | SEWER MANHOLE | | GAS |
| | LIGHT POLE | | WATER MAIN |
| | KERB INLET PIT | | TELSTRA /NBN |
| | STORMWATER PIT | | UNDER GROUND POWER |
| | ELECTRICITY PILLAR | | |
| | ELECTRICAL SUBSTATION | | |
| | STREET TREES | | |

Anticipated Site Classification - H1 Class
(to be confirmed at completion of construction)
(CB) EASEMENT FOR ELECTRICITY AND OTHER PURPOSES 2.06 WIDE
(CA) EASEMENT TO DRAIN WATER 1.5m WIDE
RESTRICTIONS ON USE OF LAND AFFECT THE LOT

DISCLAIMER/ NOTES:

- Contours are based on finished design levels and are subject to construction and Council certification and therefore should not be considered as final or as-built.
- Location of utility services including but not limited to power, water, sewer, communications and gas are subject to construction and Supply Authority certification and therefore should not be considered as final or as-built.
- Survey information such as boundary dimensions and areas, easements etc are subject to Final Survey. Purchasers should refer to the Deposited Plan and 88B Instrument contained in the Contract for Sale of Land for further detailed information.
- Bushfire and Geotechnical classification are provided for convenience. Purchasers should refer to referenced detail specialist reports.
- This Preliminary Site Analysis Plan has been collated from various sources of design information and is provided for convenience to assist Purchasers in obtaining quotations/tenders for dwelling construction.
- This document does not form part of the Contract of Sale of the Land.

REVISION/S: HD308 STAGE 3B MARKETING r1

DATE: 3rd of February 2021

BY: HIGH DEFINITION DESIGN PTY LTD

LOT 312, BUSHEL STREET, LOCHINVAR



HEREFORD HILL
• LOCHINVAR •

MASTER PLAN



STAGE PLAN



PRELIMINARY SITE ANALYSIS PLAN

SCALE 1:400 @ A4

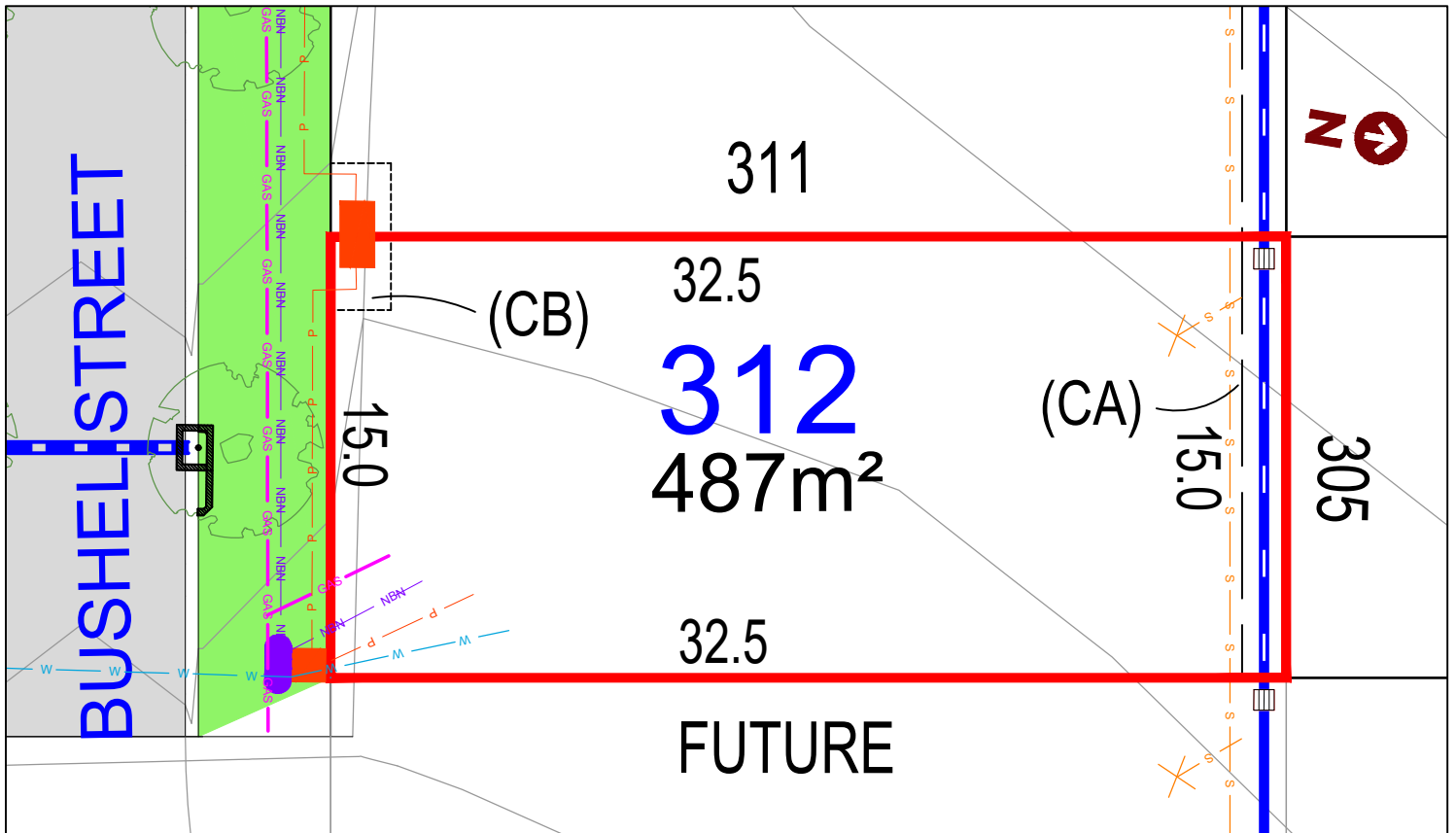
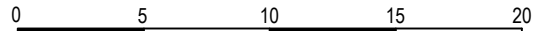

LEGEND:

- | | | | |
|--|-----------------------|--|--------------------|
| | TELSTRA /NBN PIT | | STORMWATER PIPE |
| | HYDRANT | | SEWER JUNCTION |
| | STOP VALVE | | SEWER MAIN |
| | SEWER MANHOLE | | GAS |
| | LIGHT POLE | | WATER MAIN |
| | KERB INLET PIT | | TELSTRA /NBN |
| | STORMWATER PIT | | UNDER GROUND POWER |
| | ELECTRICITY PILLAR | | |
| | ELECTRICAL SUBSTATION | | |
| | STREET TREES | | |

Anticipated Site Classification - H1 Class
(to be confirmed at completion of construction)

(CB) EASEMENT FOR ELECTRICITY AND OTHER PURPOSES 2.06 WIDE
(CA) EASEMENT TO DRAIN WATER 1.5m WIDE
RESTRICTIONS ON USE OF LAND AFFECT THE LOT

DISCLAIMER/ NOTES:

1. Contours are based on finished design levels and are subject to construction and Council certification and therefore should not be considered as final or as-built.
2. Location of utility services including but not limited to power, water, sewer, communications and gas are subject to construction and Supply Authority certification and therefore should not be considered as final or as-built.
3. Survey information such as boundary dimensions and areas, easements etc are subject to Final Survey. Purchasers should refer to the Deposited Plan and 88B Instrument contained in the Contract for Sale of Land for further detailed information.
4. Bushfire and Geotechnical classification are provided for convenience. Purchasers should refer to referenced detail specialist reports.
5. This Preliminary Site Analysis Plan has been collated from various sources of design information and is provided for convenience to assist Purchasers in obtaining quotations/tenders for dwelling construction.
6. This document does not form part of the Contract of Sale of the Land.

REVISION/S: HD308 STAGE 3B MARKETING r1

DATE: 3rd of February 2021

BY: HIGH DEFINITION DESIGN PTY LTD

LOT 313, BUSHEL STREET, LOCHINVAR



HEREFORD HILL
• LOCHINVAR •

MASTER PLAN



STAGE PLAN



PRELIMINARY SITE ANALYSIS PLAN

SCALE 1:250 @ A4

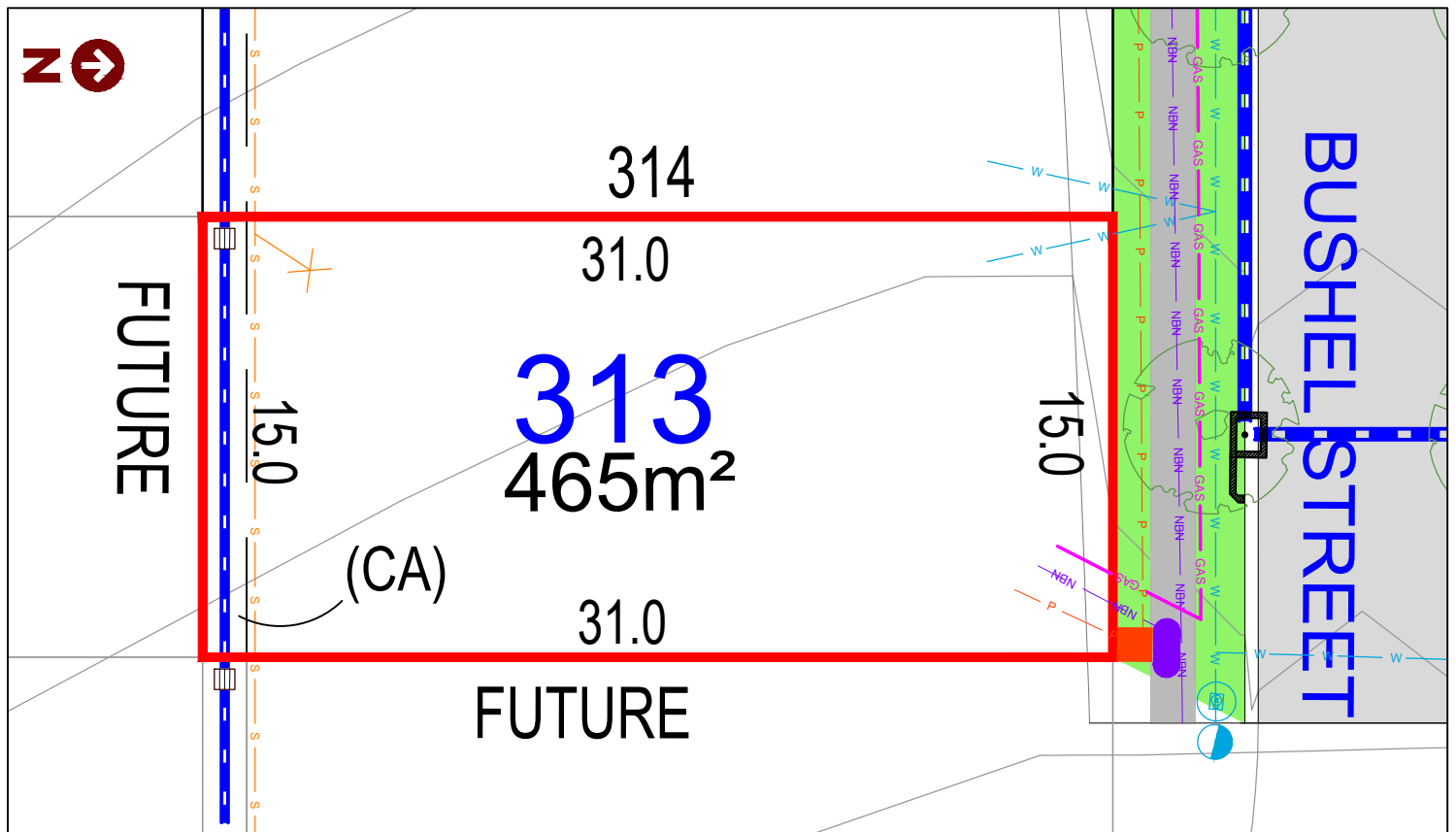
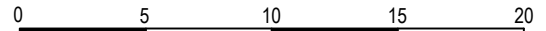

LEGEND:

	TELSTRA /NBN PIT		STORMWATER PIPE
	HYDRANT		SEWER JUNCTION
	STOP VALVE		SEWER MAIN
	SEWER MANHOLE		GAS
	LIGHT POLE		WATER MAIN
	KERB INLET PIT		TELSTRA /NBN
	STORMWATER PIT		UNDER GROUND POWER
	ELECTRICITY PILLAR		
	ELECTRICAL SUBSTATION		
	STREET TREES		

Anticipated Site Classification - H1 Class
(to be confirmed at completion of construction)

(CA) EASEMENT TO DRAIN WATER 1.5m WIDE
RESTRICTIONS ON USE OF LAND AFFECT THE LOT

DISCLAIMER/ NOTES:

1. Contours are based on finished design levels and are subject to construction and Council certification and therefore should not be considered as final or as-built.
2. Location of utility services including but not limited to power, water, sewer, communications and gas are subject to construction and Supply Authority certification and therefore should not be considered as final or as-built.
3. Survey information such as boundary dimensions and areas, easements etc are subject to Final Survey. Purchasers should refer to the Deposited Plan and 88B Instrument contained in the Contract for Sale of Land for further detailed information.
4. Bushfire and Geotechnical classification are provided for convenience. Purchasers should refer to referenced detail specialist reports.
5. This Preliminary Site Analysis Plan has been collated from various sources of design information and is provided for convenience to assist Purchasers in obtaining quotations/tenders for dwelling construction.
6. This document does not form part of the Contract of Sale of the Land.

REVISIONS/ HD308 STAGE 3B MARKETING r1

DATE: 3rd of February 2021

BY: HIGH DEFINITION DESIGN PTY LTD

LOT 314, BUSHEL STREET , LOCHINVAR



HEREFORD HILL
• LOCHINVAR •

MASTER PLAN



STAGE PLAN



PRELIMINARY SITE ANALYSIS PLAN

SCALE 1:400 @ A4

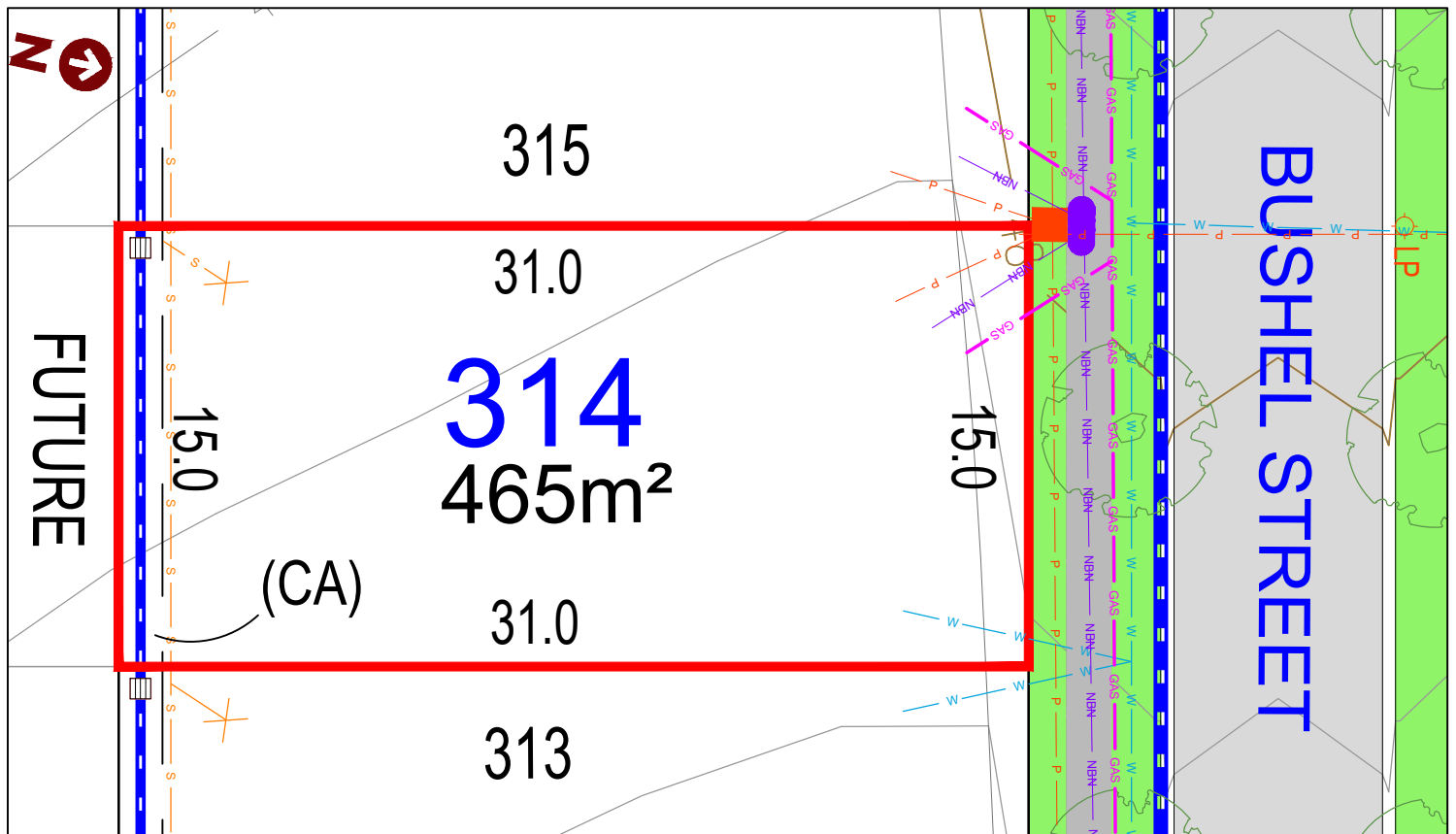
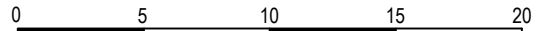

LEGEND:

- | | | | |
|--|-----------------------|--|--------------------|
| | TELSTRA /NBN PIT | | STORMWATER PIPE |
| | HYDRANT | | SEWER JUNCTION |
| | STOP VALVE | | SEWER MAIN |
| | SEWER MANHOLE | | GAS |
| | LIGHT POLE | | WATER MAIN |
| | KERB INLET PIT | | TELSTRA /NBN |
| | STORMWATER PIT | | UNDER GROUND POWER |
| | ELECTRICITY PILLAR | | |
| | ELECTRICAL SUBSTATION | | |
| | STREET TREES | | |
- Anticipated Site Classification - H1 Class
(to be confirmed at completion of construction)
- (CA) EASEMENT TO DRAIN WATER 1.5m WIDE
RESTRICTIONS ON USE OF LAND AFFECT THE LOT

DISCLAIMER/ NOTES:

- Contours are based on finished design levels and are subject to construction and Council certification and therefore should not be considered as final or as-built.
- Location of utility services including but not limited to power, water, sewer, communications and gas are subject to construction and Supply Authority certification and therefore should not be considered as final or as-built.
- Survey information such as boundary dimensions and areas, easements etc are subject to Final Survey. Purchasers should refer to the Deposited Plan and 88B Instrument contained in the Contract for Sale of Land for further detailed information.
- Bushfire and Geotechnical classification are provided for convenience. Purchasers should refer to referenced detail specialist reports.
- This Preliminary Site Analysis Plan has been collated from various sources of design information and is provided for convenience to assist Purchasers in obtaining quotations/tenders for dwelling construction.
- This document does not form part of the Contract of Sale of the Land.

REVISIONS: HD308 STAGE 3B MARKETING r1

DATE: 3rd of February 2021

BY: HIGH DEFINITION DESIGN PTY LTD

LOT 315, BUSHEL STREET, LOCHINVAR



HEREFORD HILL
• LOCHINVAR •

MASTER PLAN



STAGE PLAN



PRELIMINARY SITE ANALYSIS PLAN

SCALE 1:400 @ A4

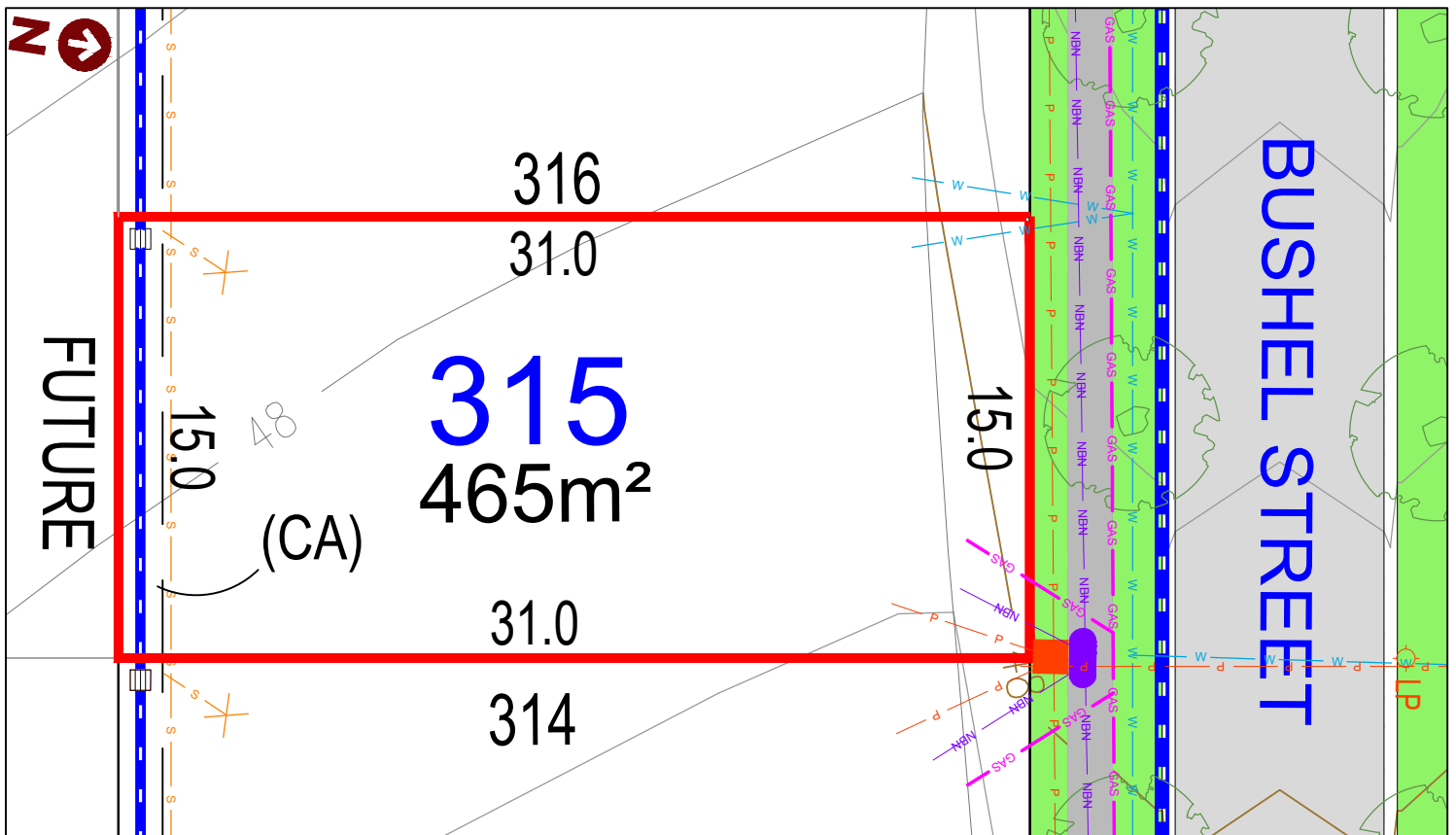
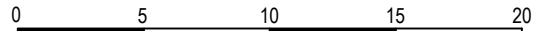

LEGEND:

	TELSTRA /NBN PIT		STORMWATER PIPE
	HYDRANT		SEWER JUNCTION
	STOP VALVE		SEWER MAIN
	SEWER MANHOLE		GAS
	LIGHT POLE		WATER MAIN
	KERB INLET PIT		TELSTRA /NBN
	STORMWATER PIT		UNDER GROUND POWER
	ELECTRICITY PILLAR		
	ELECTRICAL SUBSTATION		
	STREET TREES		

Anticipated Site Classification - H1 Class
(to be confirmed at completion of construction)

(CA) EASEMENT TO DRAIN WATER 1.5m WIDE
RESTRICTIONS ON USE OF LAND AFFECT THE LOT

DISCLAIMER/ NOTES:

1. Contours are based on finished design levels and are subject to construction and Council certification and therefore should not be considered as final or as-built.
2. Location of utility services including but not limited to power, water, sewer, communications and gas are subject to construction and Supply Authority certification and therefore should not be considered as final or as-built.
3. Survey information such as boundary dimensions and areas, easements etc are subject to Final Survey. Purchasers should refer to the Deposited Plan and 88B Instrument contained in the Contract for Sale of Land for further detailed information.
4. Bushfire and Geotechnical classification are provided for convenience. Purchasers should refer to referenced detail specialist reports.
5. This Preliminary Site Analysis Plan has been collated from various sources of design information and is provided for convenience to assist Purchasers in obtaining quotations/tenders for dwelling construction.
6. This document does not form part of the Contract of Sale of the Land.

REVISIONS/ HD308 STAGE 3B MARKETING r1

DATE: 3rd of February 2021

BY: HIGH DEFINITION DESIGN PTY LTD

LOT 316, BUSHEL STREET, LOCHINVAR



HEREFORD HILL
• LOCHINVAR •

MASTER PLAN



PRELIMINARY SITE ANALYSIS PLAN

STAGE PLAN



SCALE 1:400 @ A4

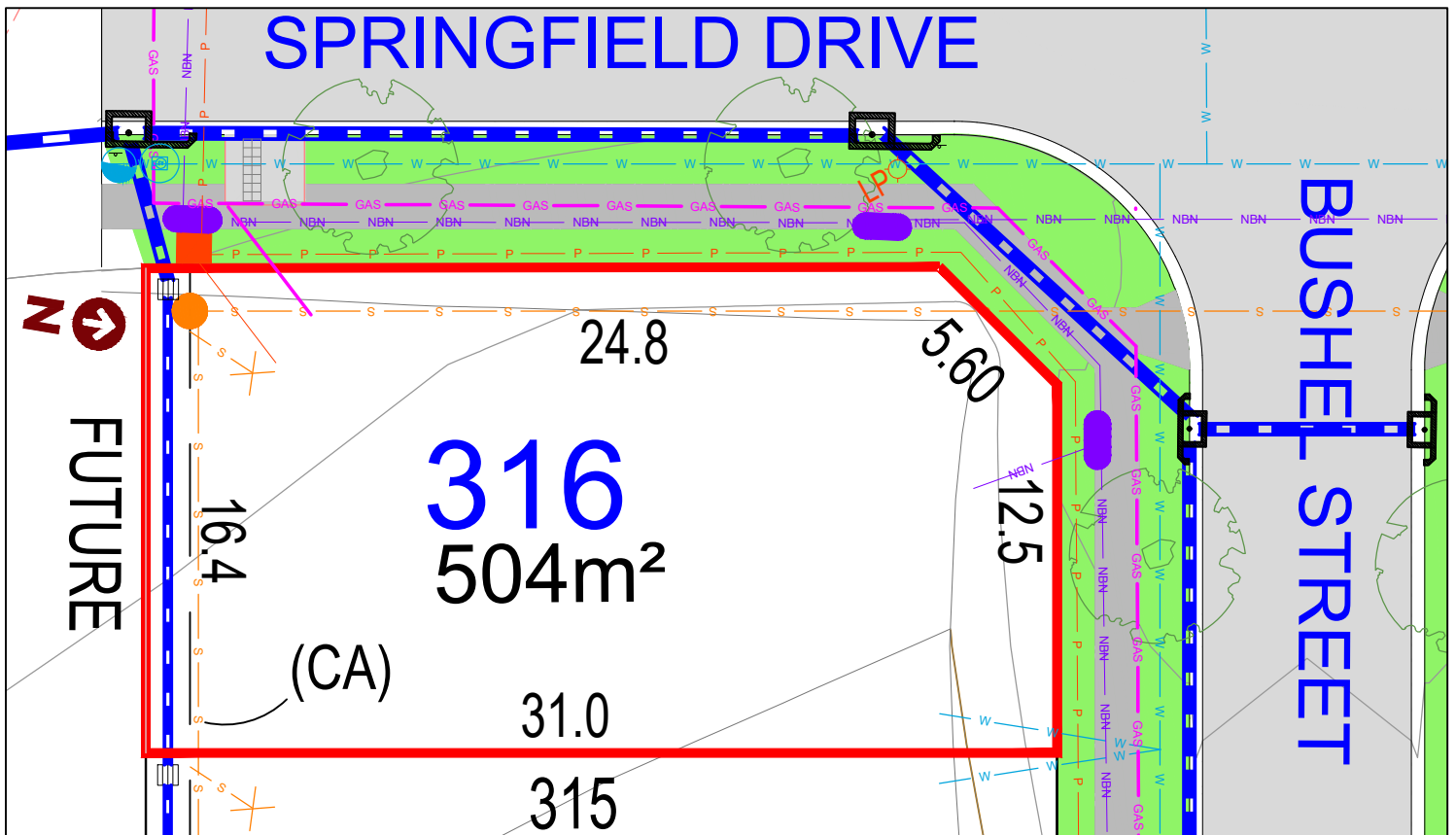
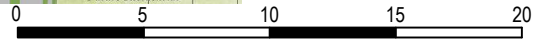

LEGEND:

- TELSTRA /NBN PIT
 - HYDRANT
 - STOP VALVE
 - SEWER MANHOLE
 - LIGHT POLE
 - KERB INLET PIT
 - STORMWATER PIT
 - ELECTRICITY PILLAR
 - ELECTRICAL SUBSTATION
 - STREET TREES
 - STORMWATER PIPE
 - SEWER JUNCTION
 - SEWER MAIN
 - GAS
 - WATER MAIN
 - TELSTRA /NBN
 - UNDER GROUND POWER
- Anticipated Site Classification - H1 Class
(to be confirmed at completion of construction)
- (CA) EASEMENT TO DRAIN WATER 1.5m WIDE
RESTRICTIONS ON USE OF LAND AFFECT THE LOT

DISCLAIMER/ NOTES:

1. Contours are based on finished design levels and are subject to construction and Council certification and therefore should not be considered as final or as-built.
2. Location of utility services including but not limited to power, water, sewer, communications and gas are subject to construction and Supply Authority certification and therefore should not be considered as final or as-built.
3. Survey information such as boundary dimensions and areas, easements etc are subject to Final Survey. Purchasers should refer to the Deposited Plan and 88B Instrument contained in the Contract for Sale of Land for further detailed information.
4. Bushfire and Geotechnical classification are provided for convenience. Purchasers should refer to referenced detail specialist reports.
5. This Preliminary Site Analysis Plan has been collated from various sources of design information and is provided for convenience to assist Purchasers in obtaining quotations/tenders for dwelling construction.
6. This document does not form part of the Contract of Sale of the Land.

REVISIONS/ HD308 STAGE 3B MARKETING r1

DATE: 3rd of February 2021

BY: HIGH DEFINITION DESIGN PTY LTD

LOT 317, DROVER DRIVE, LOCHINVAR



HEREFORD HILL
• LOCHINVAR •

MASTER PLAN



STAGE PLAN



PRELIMINARY SITE ANALYSIS PLAN

SCALE 1:300 @ A4

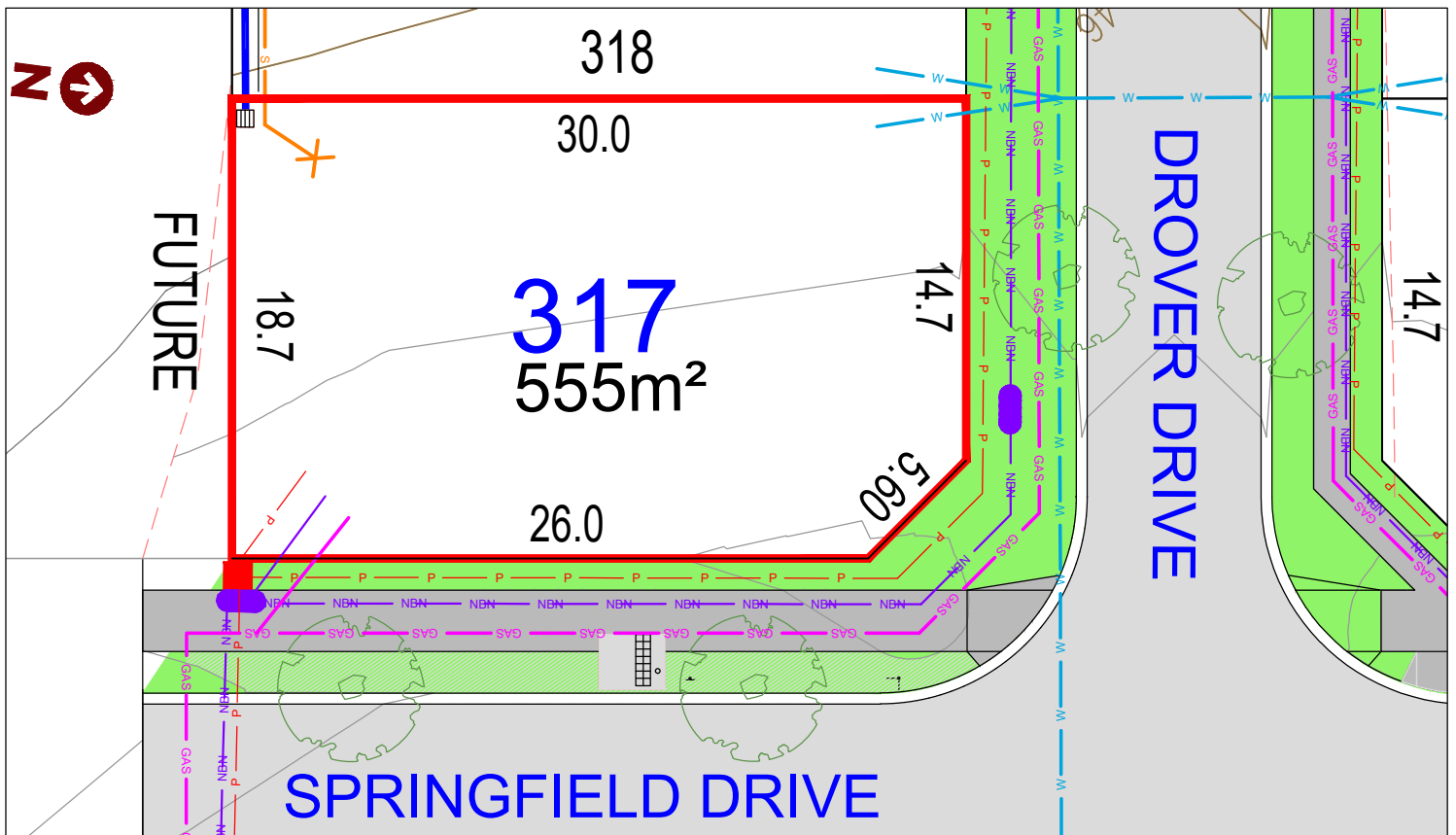
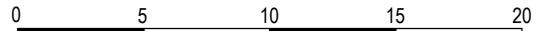

LEGEND:

- | | | | |
|--|-----------------------|--|--------------------|
| | TELSTRA /NBN PIT | | STORMWATER PIPE |
| | HYDRANT | | SEWER JUNCTION |
| | STOP VALVE | | SEWER MAIN |
| | SEWER MANHOLE | | GAS |
| | LIGHT POLE | | WATER MAIN |
| | KERB INLET PIT | | TELSTRA /NBN |
| | STORMWATER PIT | | UNDER GROUND POWER |
| | ELECTRICITY PILLAR | | |
| | ELECTRICAL SUBSTATION | | |
| | STREET TREES | | |
- Anticipated Site Classification - H1 Class
(to be confirmed at completion of construction)
- (CA) EASEMENT TO DRAIN WATER 1.5m WIDE
RESTRICTIONS ON USE OF LAND AFFECT THE LOT

DISCLAIMER/ NOTES:

1. Contours are based on finished design levels and are subject to construction and Council certification and therefore should not be considered as final or as-built.
2. Location of utility services including but not limited to power, water, sewer, communications and gas are subject to construction and Supply Authority certification and therefore should not be considered as final or as-built.
3. Survey information such as boundary dimensions and areas, easements etc are subject to Final Survey. Purchasers should refer to the Deposited Plan and 88B Instrument contained in the Contract for Sale of Land for further detailed information.
4. Bushfire and Geotechnical classification are provided for convenience. Purchasers should refer to referenced detail specialist reports.
5. This Preliminary Site Analysis Plan has been collated from various sources of design information and is provided for convenience to assist Purchasers in obtaining quotations/tenders for dwelling construction.
6. This document does not form part of the Contract of Sale of the Land.

REVISIONS: HD308 STAGE 3B MARKETING r1

DATE: 3rd of February 2021

BY: HIGH DEFINITION DESIGN PTY LTD

LOT 318, DROVER DRIVE, LOCHINVAR



HEREFORD HILL
• LOCHINVAR •

MASTER PLAN



STAGE PLAN



PRELIMINARY SITE ANALYSIS PLAN

SCALE 1:400 @ A4

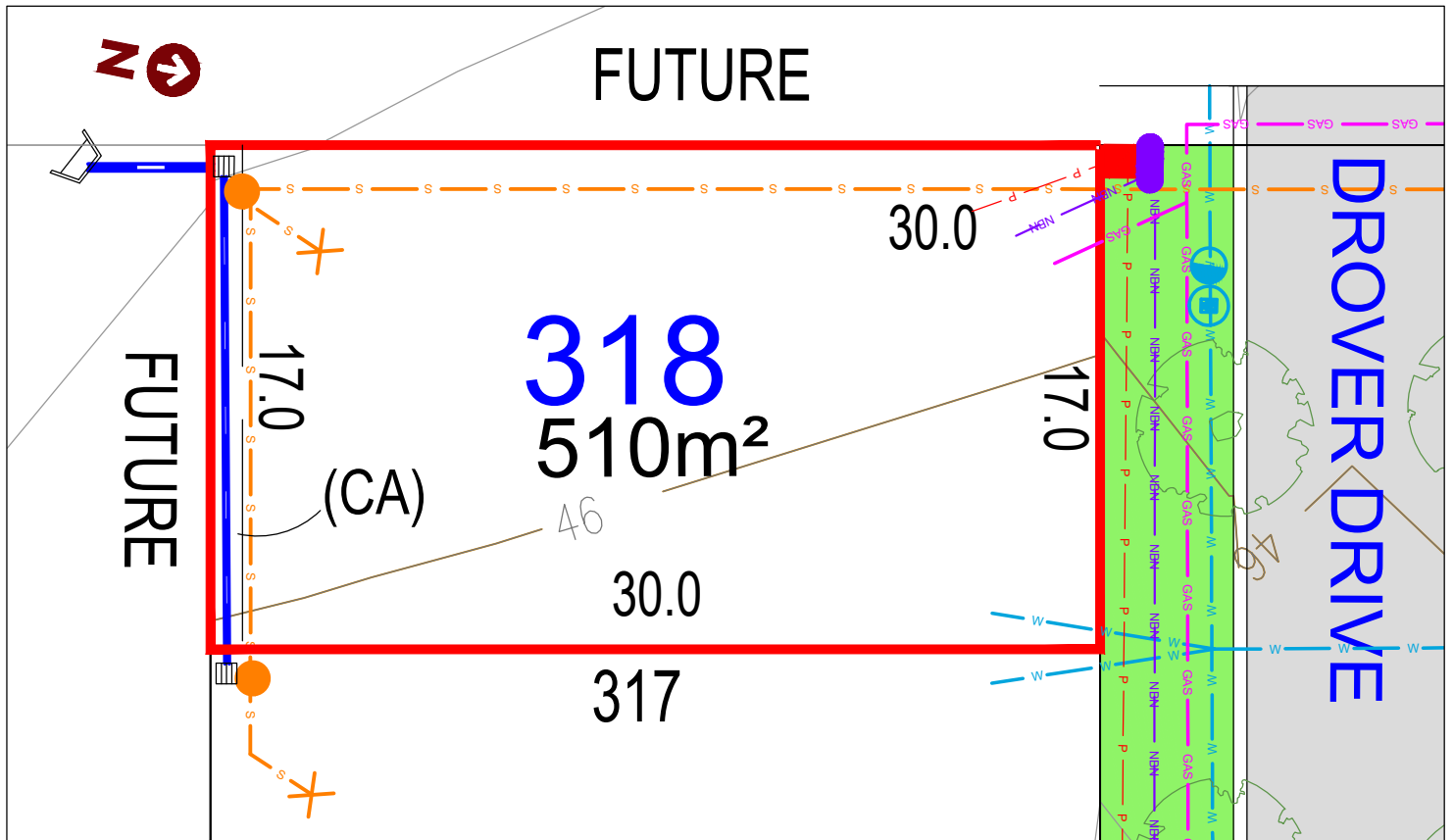
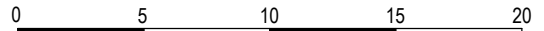

LEGEND:

- | | | | |
|--|-----------------------|--|--------------------|
| | TELSTRA /NBN PIT | | STORMWATER PIPE |
| | HYDRANT | | SEWER JUNCTION |
| | STOP VALVE | | SEWER MAIN |
| | SEWER MANHOLE | | GAS |
| | LIGHT POLE | | GAS |
| | KERB INLET PIT | | WATER MAIN |
| | STORMWATER PIT | | TELSTRA /NBN |
| | ELECTRICITY PILLAR | | UNDER GROUND POWER |
| | ELECTRICAL SUBSTATION | | |
| | STREET TREES | | |
- Anticipated Site Classification - H1 Class
(to be confirmed at completion of construction)
- (CA) EASEMENT TO DRAIN WATER 1.5m WIDE
RESTRICTIONS ON USE OF LAND AFFECT THE LOT

DISCLAIMER/ NOTES:

- Contours are based on finished design levels and are subject to construction and Council certification and therefore should not be considered as final or as-built.
- Location of utility services including but not limited to power, water, sewer, communications and gas are subject to construction and Supply Authority certification and therefore should not be considered as final or as-built.
- Survey information such as boundary dimensions and areas, easements etc are subject to Final Survey. Purchasers should refer to the Deposited Plan and 88B Instrument contained in the Contract for Sale of Land for further detailed information.
- Bushfire and Geotechnical classification are provided for convenience. Purchasers should refer to referenced detail specialist reports.
- This Preliminary Site Analysis Plan has been collated from various sources of design information and is provided for convenience to assist Purchasers in obtaining quotations/tenders for dwelling construction.
- This document does not form part of the Contract of Sale of the Land.

REVISIONS: HD308 STAGE 3B MARKETING r1

DATE: 3rd of February 2021

BY: HIGH DEFINITION DESIGN PTY LTD

LOT 319, DROVER DRIVE, LOCHINVAR



HEREFORD HILL
• LOCHINVAR •

MASTER PLAN



STAGE PLAN



PRELIMINARY SITE ANALYSIS PLAN

SCALE 1:250 @ A4

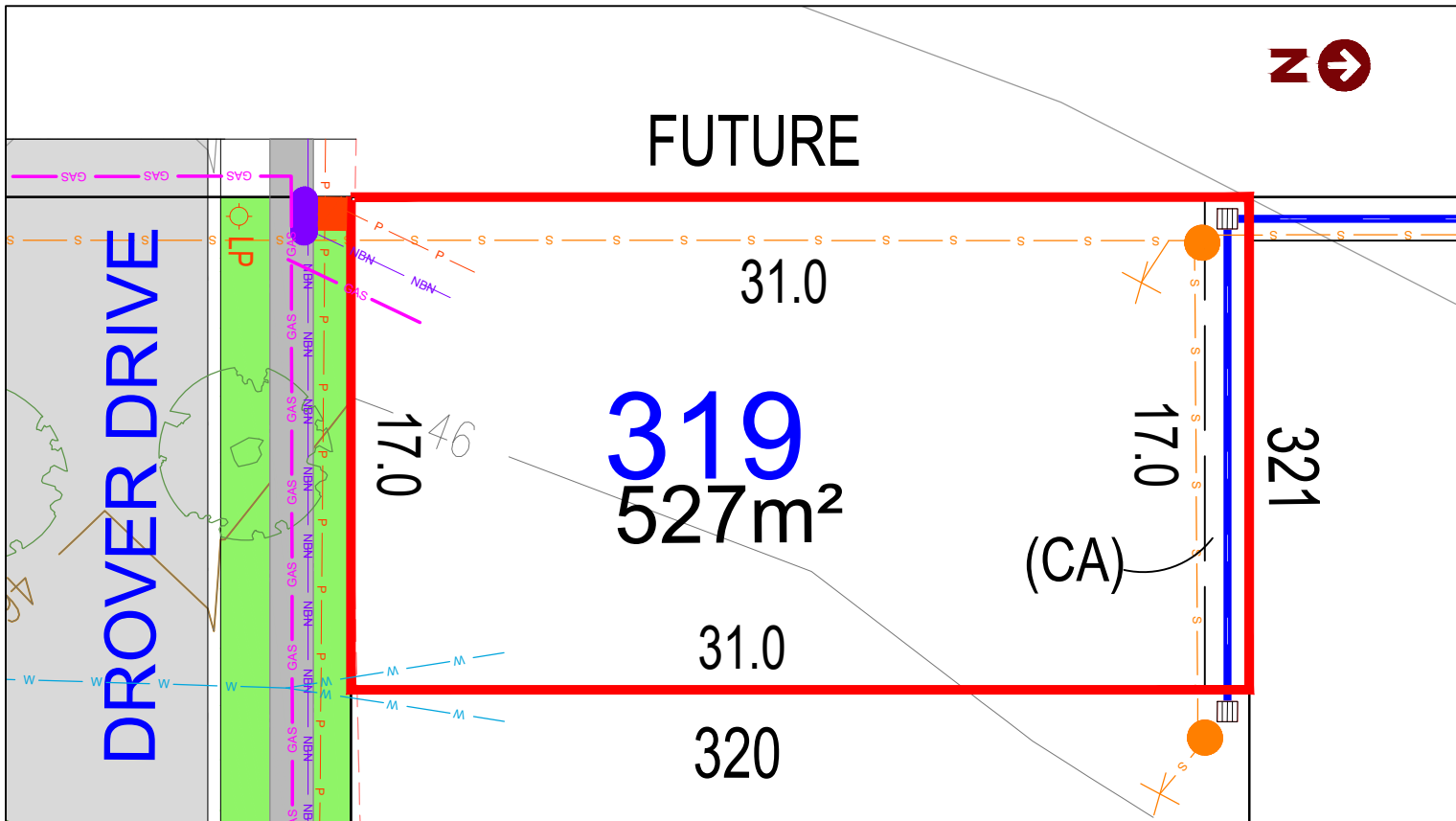
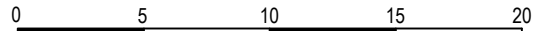

LEGEND:

- | | | | |
|--|-----------------------|--|--------------------|
| | TELSTRA /NBN PIT | | STORMWATER PIPE |
| | HYDRANT | | SEWER JUNCTION |
| | STOP VALVE | | SEWER MAIN |
| | SEWER MANHOLE | | GAS |
| | LIGHT POLE | | WATER MAIN |
| | KERB INLET PIT | | TELSTRA /NBN |
| | STORMWATER PIT | | UNDER GROUND POWER |
| | ELECTRICITY PILLAR | | |
| | ELECTRICAL SUBSTATION | | |
| | STREET TREES | | |
- Anticipated Site Classification - H1 Class
(to be confirmed at completion of construction)
- (CA) EASEMENT TO DRAIN WATER 1.5m WIDE
RESTRICTIONS ON USE OF LAND AFFECT THE LOT

DISCLAIMER/ NOTES:

1. Contours are based on finished design levels and are subject to construction and Council certification and therefore should not be considered as final or as-built.
2. Location of utility services including but not limited to power, water, sewer, communications and gas are subject to construction and Supply Authority certification and therefore should not be considered as final or as-built.
3. Survey information such as boundary dimensions and areas, easements etc are subject to Final Survey. Purchasers should refer to the Deposited Plan and 88B Instrument contained in the Contract for Sale of Land for further detailed information.
4. Bushfire and Geotechnical classification are provided for convenience. Purchasers should refer to referenced detail specialist reports.
5. This Preliminary Site Analysis Plan has been collated from various sources of design information and is provided for convenience to assist Purchasers in obtaining quotations/tenders for dwelling construction.
6. This document does not form part of the Contract of Sale of the Land.

REVISION/S: HD308 STAGE 3B MARKETING r1

DATE: 3rd of February 2021

BY: HIGH DEFINITION DESIGN PTY LTD

LOT 320, DROVER DRIVE, LOCHINVAR



HEREFORD HILL
• LOCHINVAR •

MASTER PLAN



STAGE PLAN

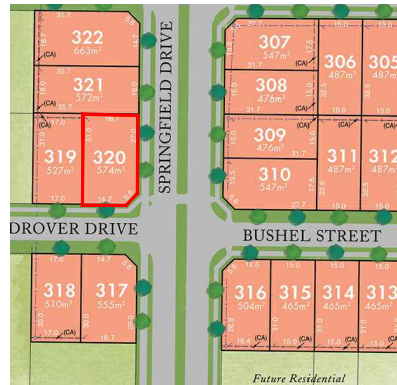

PRELIMINARY SITE ANALYSIS PLAN

SCALE 1:300 @ A4

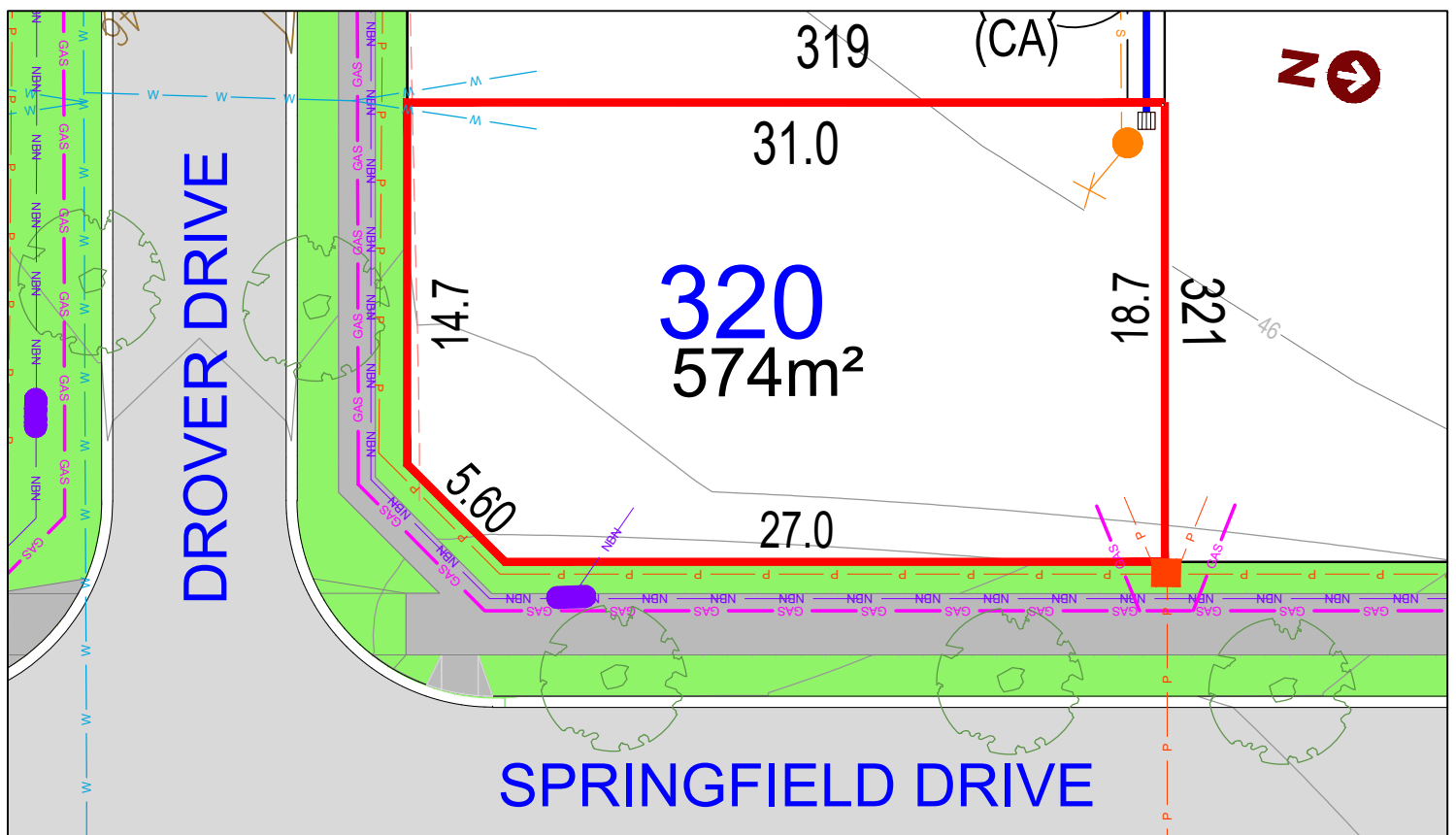
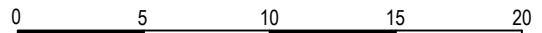

LEGEND:

- | | | | |
|--|-----------------------|--|--------------------|
| | TELSTRA /NBN PIT | | STORMWATER PIPE |
| | HYDRANT | | SEWER JUNCTION |
| | STOP VALVE | | SEWER MAIN |
| | SEWER MANHOLE | | GAS |
| | LIGHT POLE | | WATER MAIN |
| | KERB INLET PIT | | TELSTRA /NBN |
| | STORMWATER PIT | | UNDER GROUND POWER |
| | ELECTRICITY PILLAR | | |
| | ELECTRICAL SUBSTATION | | |
| | STREET TREES | | |

Anticipated Site Classification - H1 Class
(to be confirmed at completion of construction)

(CA) EASEMENT TO DRAIN WATER 1.5m WIDE
RESTRICTIONS ON USE OF LAND AFFECT THE LOT

DISCLAIMER/ NOTES:

- Contours are based on finished design levels and are subject to construction and Council certification and therefore should not be considered as final or as-built.
- Location of utility services including but not limited to power, water, sewer, communications and gas are subject to construction and Supply Authority certification and therefore should not be considered as final or as-built.
- Survey information such as boundary dimensions and areas, easements etc are subject to Final Survey. Purchasers should refer to the Deposited Plan and 88B Instrument contained in the Contract for Sale of Land for further detailed information.
- Bushfire and Geotechnical classification are provided for convenience. Purchasers should refer to referenced detail specialist reports.
- This Preliminary Site Analysis Plan has been collated from various sources of design information and is provided for convenience to assist Purchasers in obtaining quotations/tenders for dwelling construction.
- This document does not form part of the Contract of Sale of the Land.

REVISIONS/ HD308 STAGE 3B MARKETING r1

DATE: 3rd of February 2021

BY: HIGH DEFINITION DESIGN PTY LTD

LOT 321, SPRINGFIELD DRIVE, LOCHINVAR



HEREFORD HILL
• LOCHINVAR •

MASTER PLAN



STAGE PLAN



PRELIMINARY SITE ANALYSIS PLAN

SCALE 1:400 @ A4

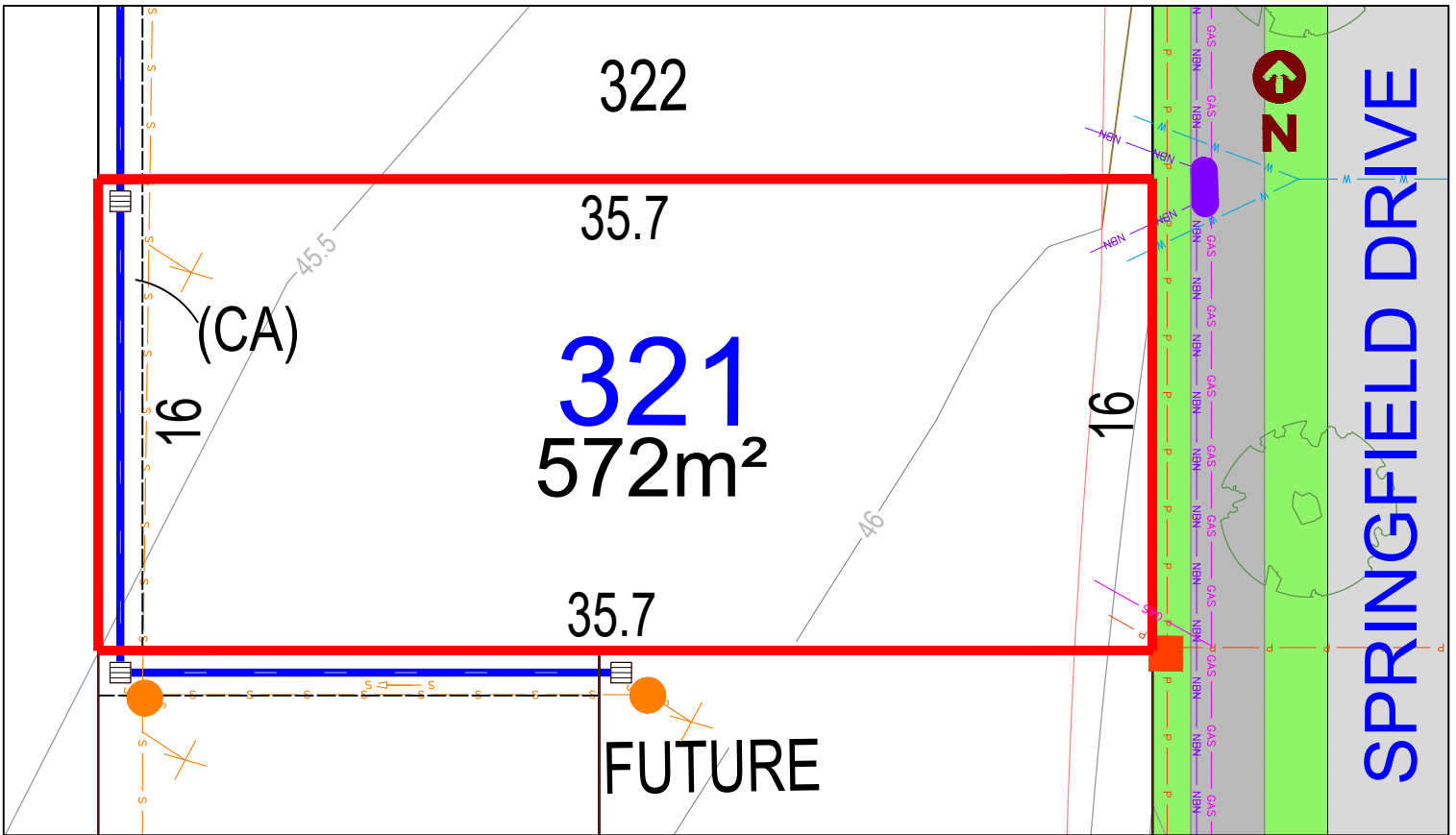
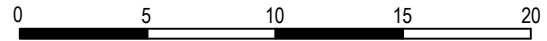

LEGEND:

- TELSTRA /NBN PIT
 - HYDRANT
 - STOP VALVE
 - SEWER MANHOLE
 - LIGHT POLE
 - KERB INLET PIT
 - STORMWATER PIT
 - ELECTRICITY PILLAR
 - ELECTRICAL SUBSTATION
 - STREET TREES
 - STORMWATER PIPE
 - SEWER JUNCTION
 - SEWER MAIN
 - GAS
 - WATER MAIN
 - TELSTRA /NBN
 - UNDER GROUND POWER
- THE SITE CLASSIFICATION STATED IS TAKEN FROM THE QUALTEST GEOTECHNICAL ASSESSMENT REPORT NEW17P-0054B-AB. DATED 28TH OCTOBER 2020 SECTION 5.1. SITE SPECIFIC CLASSIFICATION SHOULD BE UNDERTAKEN SEPARATELY BY BUILDERS. PRELIMINARY SITE CLASSIFICATION: H2
- (CA) EASEMENT TO DRAIN WATER 1.5m WIDE RESTRICTIONS ON USE OF LAND AFFECT THE LOT
RESTRICTIONS ON USE OF LAND AFFECT THE LOT

DISCLAIMER/ NOTES:

- Contours are based on finished design levels and are subject to construction and Council certification and therefore should not be considered as final or as-built.
- Location of utility services including but not limited to power, water, sewer, communications and gas are subject to construction and Supply Authority certification and therefore should not be considered as final or as-built.
- Survey information such as boundary dimensions and areas, easements etc are subject to Final Survey. Purchasers should refer to the Deposited Plan and 88B Instrument contained in the Contract for Sale of Land for further detailed information.
- Bushfire and Geotechnical classification are provided for convenience. Purchasers should refer to referenced detail specialist reports.
- This Preliminary Site Analysis Plan has been collated from various sources of design information and is provided for convenience to assist Purchasers in obtaining quotations/tenders for dwelling construction.
- This document does not form part of the Contract of Sale of the Land.

REVISION/S: HD308 STAGE 3A MARKETING r1

DATE: 23th of November 2020

BY: HIGH DEFINITION DESIGN PTY LTD

LOT 322, SPRINGFIELD DRIVE, LOCHINVAR



HEREFORD HILL
• LOCHINVAR •

MASTER PLAN



STAGE PLAN



PRELIMINARY SITE ANALYSIS PLAN

SCALE 1:300 @ A4

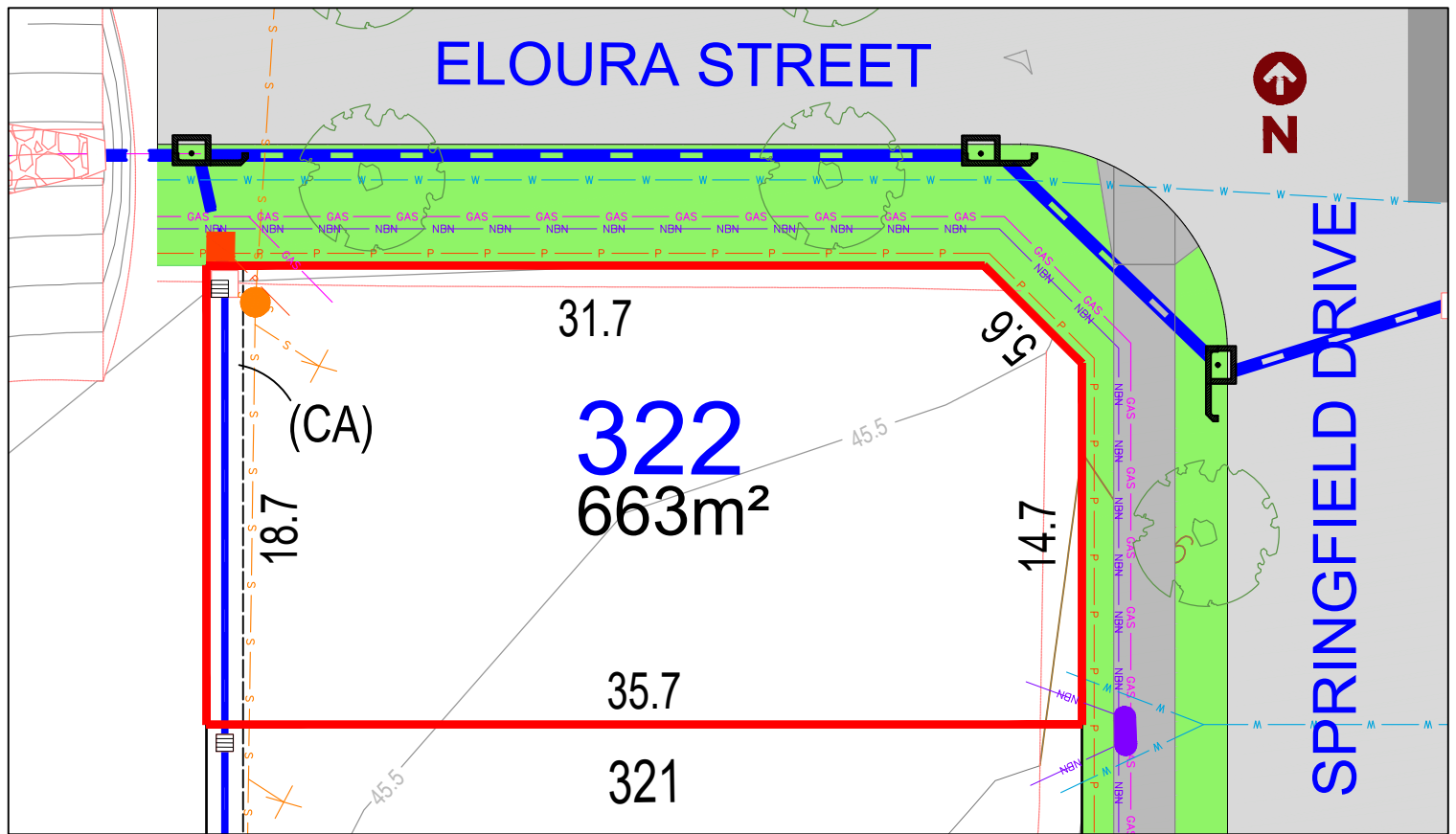
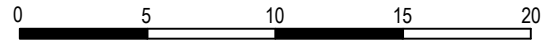

LEGEND:

- TELSTRA /NBN PIT
- HYDRANT
- STOP VALVE
- SEWER MANHOLE
- LIGHT POLE
- KERB INLET PIT
- STORMWATER PIT
- ELECTRICITY PILLAR
- ELECTRICAL SUBSTATION
- STREET TREES
- STORMWATER PIPE
- SEWER JUNCTION
- SEWER MAIN
- GAS
- WATER MAIN
- TELSTRA /NBN
- UNDER GROUND POWER

THE SITE CLASSIFICATION STATED IS TAKEN FROM THE QUALTEST GEOTECHNICAL ASSESSMENT REPORT NEW17P-0054B-AB. DATED 28TH OCTOBER 2020 SECTION 5.1. SITE SPECIFIC CLASSIFICATION SHOULD BE UNDERTAKEN SEPARATELY BY BUILDERS. PRELIMINARY SITE CLASSIFICATION: H2

(CA) EASEMENT TO DRAIN WATER 1.5m WIDE RESTRICTIONS ON USE OF LAND AFFECT THE LOT
RESTRICTIONS ON USE OF LAND AFFECT THE LOT

DISCLAIMER/ NOTES:

1. Contours are based on finished design levels and are subject to construction and Council certification and therefore should not be considered as final or as-built.
2. Location of utility services including but not limited to power, water, sewer, communications and gas are subject to construction and Supply Authority certification and therefore should not be considered as final or as-built.
3. Survey information such as boundary dimensions and areas, easements etc are subject to Final Survey. Purchasers should refer to the Deposited Plan and 88B Instrument contained in the Contract for Sale of Land for further detailed information.
4. Bushfire and Geotechnical classification are provided for convenience. Purchasers should refer to referenced detail specialist reports.
5. This Preliminary Site Analysis Plan has been collated from various sources of design information and is provided for convenience to assist Purchasers in obtaining quotations/tenders for dwelling construction.
6. This document does not form part of the Contract of Sale of the Land.

REVISION/S: HD308 STAGE 3A MARKETING r1
DATE: 23th of November 2020
BY: HIGH DEFINITION DESIGN PTY LTD

LOT 323, SPRINGFIELD DRIVE, LOCHINVAR



HEREFORD HILL
• LOCHINVAR •

MASTER PLAN



STAGE PLAN



PRELIMINARY SITE ANALYSIS PLAN

SCALE 1:300 @ A4

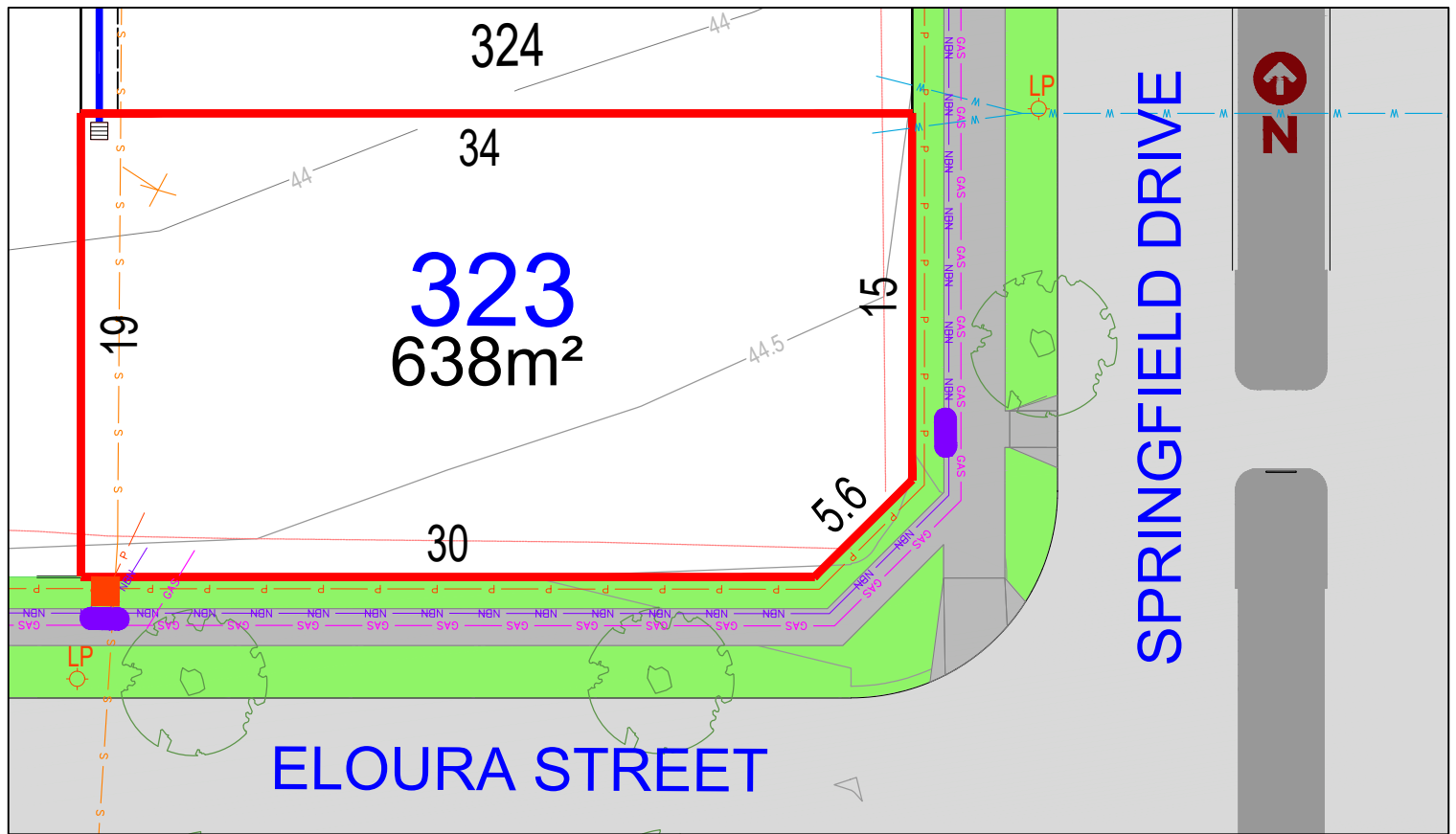
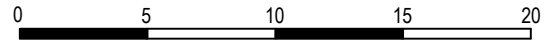

LEGEND:

- TELSTRA /NBN PIT
- HYDRANT
- STOP VALVE
- SEWER MANHOLE
- LIGHT POLE
- KERB INLET PIT
- STORMWATER PIT
- ELECTRICITY PILLAR
- ELECTRICAL SUBSTATION
- STREET TREES
- STORMWATER PIPE
- SEWER JUNCTION
- SEWER MAIN
- GAS
- WATER MAIN
- TELSTRA /NBN
- UNDER GROUND POWER

THE SITE CLASSIFICATION STATED IS TAKEN FROM THE QUALTEST GEOTECHNICAL ASSESSMENT REPORT NEW17P-0054B-AB. DATED 28TH OCTOBER 2020 SECTION 5.1. SITE SPECIFIC CLASSIFICATION SHOULD BE UNDERTAKEN SEPARATELY BY BUILDERS. PRELIMINARY SITE CLASSIFICATION: H2

(CA) EASEMENT TO DRAIN WATER 1.5m WIDE RESTRICTIONS ON USE OF LAND AFFECT THE LOT
RESTRICTIONS ON USE OF LAND AFFECT THE LOT

DISCLAIMER/ NOTES:

- Contours are based on finished design levels and are subject to construction and Council certification and therefore should not be considered as final or as-built.
- Location of utility services including but not limited to power, water, sewer, communications and gas are subject to construction and Supply Authority certification and therefore should not be considered as final or as-built.
- Survey information such as boundary dimensions and areas, easements etc are subject to Final Survey. Purchasers should refer to the Deposited Plan and 88B Instrument contained in the Contract for Sale of Land for further detailed information.
- Bushfire and Geotechnical classification are provided for convenience. Purchasers should refer to referenced detail specialist reports.
- This Preliminary Site Analysis Plan has been collated from various sources of design information and is provided for convenience to assist Purchasers in obtaining quotations/tenders for dwelling construction.
- This document does not form part of the Contract of Sale of the Land.

REVISION/S: HD308 STAGE 3A MARKETING r1

DATE: 23th of November 2020

BY: HIGH DEFINITION DESIGN PTY LTD

LOT 324, SPRINGFIELD DRIVE, LOCHINVAR



HEREFORD HILL
• LOCHINVAR •

MASTER PLAN



STAGE PLAN



PRELIMINARY SITE ANALYSIS PLAN

SCALE 1:400 @ A4

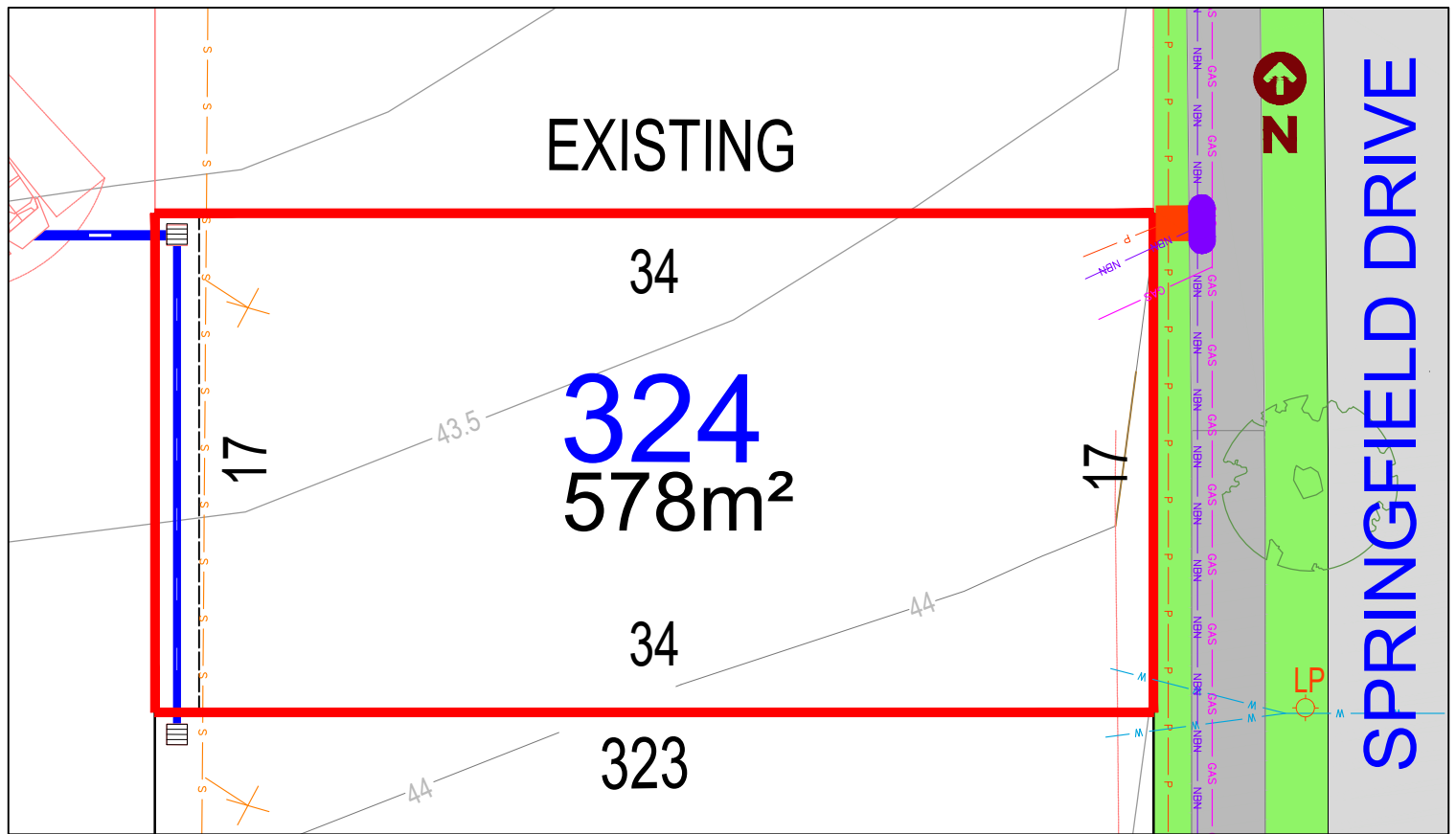
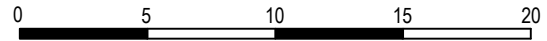

LEGEND:

- TELSTRA /NBN PIT
 - HYDRANT
 - STOP VALVE
 - SEWER MANHOLE
 - LIGHT POLE
 - KERB INLET PIT
 - STORMWATER PIT
 - ELECTRICITY PILLAR
 - ELECTRICAL SUBSTATION
 - STREET TREES
 - STORMWATER PIPE
 - SEWER JUNCTION
 - SEWER MAIN
 - GAS
 - WATER MAIN
 - TELSTRA /NBN
 - UNDER GROUND POWER
- THE SITE CLASSIFICATION STATED IS TAKEN FROM THE QUALTEST GEOTECHNICAL ASSESSMENT REPORT NEW17P-0054B-AB. DATED 28TH OCTOBER 2020 SECTION 5.1. SITE SPECIFIC CLASSIFICATION SHOULD BE UNDERTAKEN SEPARATELY BY BUILDERS. PRELIMINARY SITE CLASSIFICATION: H2
- (CA) EASEMENT TO DRAIN WATER 1.5m WIDE RESTRICTIONS ON USE OF LAND AFFECT THE LOT
RESTRICTIONS ON USE OF LAND AFFECT THE LOT

DISCLAIMER/ NOTES:

1. Contours are based on finished design levels and are subject to construction and Council certification and therefore should not be considered as final or as-built.
2. Location of utility services including but not limited to power, water, sewer, communications and gas are subject to construction and Supply Authority certification and therefore should not be considered as final or as-built.
3. Survey information such as boundary dimensions and areas, easements etc are subject to Final Survey. Purchasers should refer to the Deposited Plan and 88B Instrument contained in the Contract for Sale of Land for further detailed information.
4. Bushfire and Geotechnical classification are provided for convenience. Purchasers should refer to referenced detail specialist reports.
5. This Preliminary Site Analysis Plan has been collated from various sources of design information and is provided for convenience to assist Purchasers in obtaining quotations/tenders for dwelling construction.
6. This document does not form part of the Contract of Sale of the Land.

REVISION/S: HD308 STAGE 3A MARKETING r1

DATE: 23th of November 2020

BY: HIGH DEFINITION DESIGN PTY LTD

HEREFORD-HILL.com.au

