



LEGEND

- S Sewer main (DRAFT)
- O Sewer Man Hole
- W Water main
- Water Hydrant
- X Water Stop Valve
- E Electricity services
- Street Light
- Electrical Pillar
- NBN NBN
- NBN Pit
- Retaining Wall / Fence
- Design surface contour
- Stormwater pipe
- Stormwater lintel

(BA) EASEMENT TO DRAIN WATER 1.5 WIDE

THE SITE CLASSIFICATION STATED IS TAKEN FROM THE
QUALTEST GEOTECHNICAL ASSESSMENT REPORT
NEW17P-0054A-AA.REV1 DATED 23RD JUNE 2020
SECTION 5.1. SITE SPECIFIC CLASSIFICATION SHOULD
BE UNDERTAKEN SEPARATELY BY BUILDERS.
PRELIMINARY SITE CLASSIFICATION: E

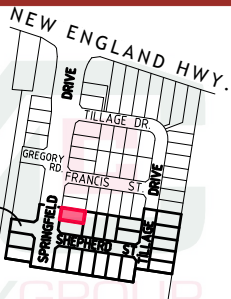

STAGE 2 SITE PLAN

Note: Gas servicing will be provided but
design is not available yet.

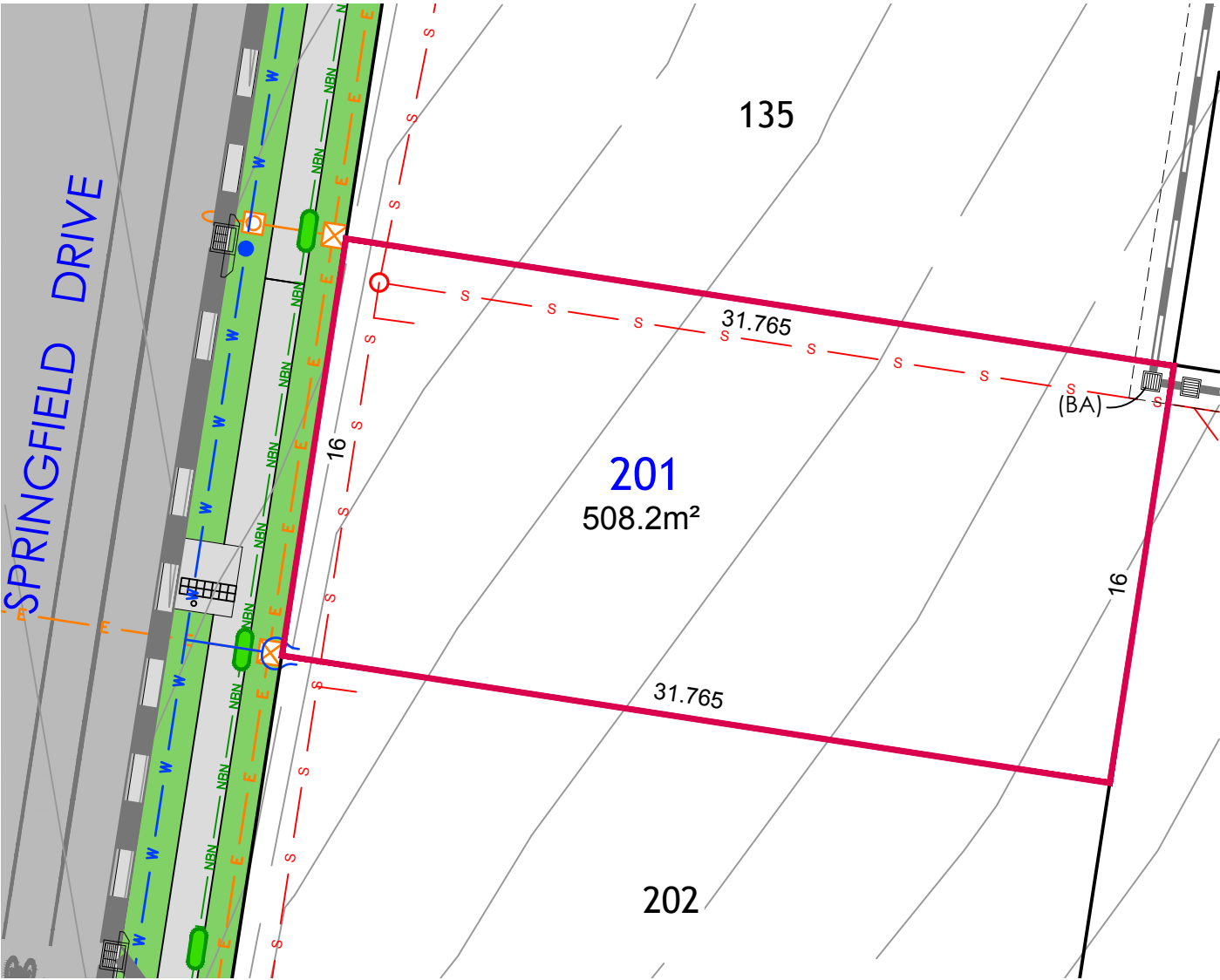

- Notes:
1. Contour interval is 0.2m. Contours are based on design plan information only, subject to construction.
 2. Utility servicing details are based on design information. Final location is subject to construction.
 3. For further information on restriction as to user, positive covenants and easements etc. affecting this lot, interested parties should refer to the Subdivision Plan and 88B Instrument.
 4. Slab thickness and piling requirements subject to structural design.

Scale: @ A4

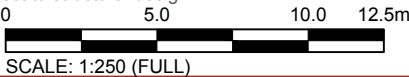

G	31/08/2020	Updated Easement	Notation	SS
Ver.	Date	Comment		By



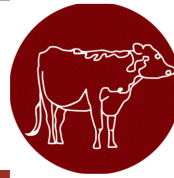

LEGEND

— S —	Sewer main (DRAFT)
○	Sewer Man Hole
— W —	Water main
●	Water Hydrant
X	Water Stop Valve
— E —	Electricity services
□	Street Light
□	Electrical Pillar
— NBN —	NBN
●	NBN Pit
▨	Retaining Wall / Fence
—	Design surface contour
—	Stormwater pipe
□	Stormwater lintel

THE SITE CLASSIFICATION STATED IS TAKEN FROM THE QUALTEST GEOTECHNICAL ASSESSMENT REPORT NEW17P-0054A-AA.REV1 DATED 23RD JUNE 2020 SECTION 5.1. SITE SPECIFIC CLASSIFICATION SHOULD BE UNDERTAKEN SEPARATELY BY BUILDERS.
PRELIMINARY SITE CLASSIFICATION: H2

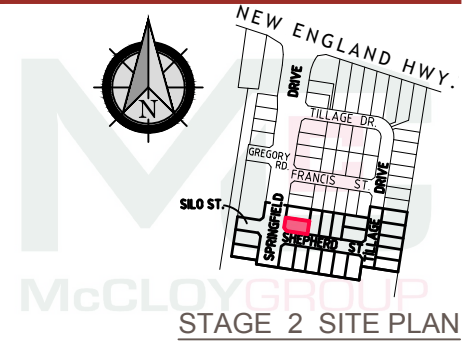

Note: Gas servicing will be provided but design is not available yet.

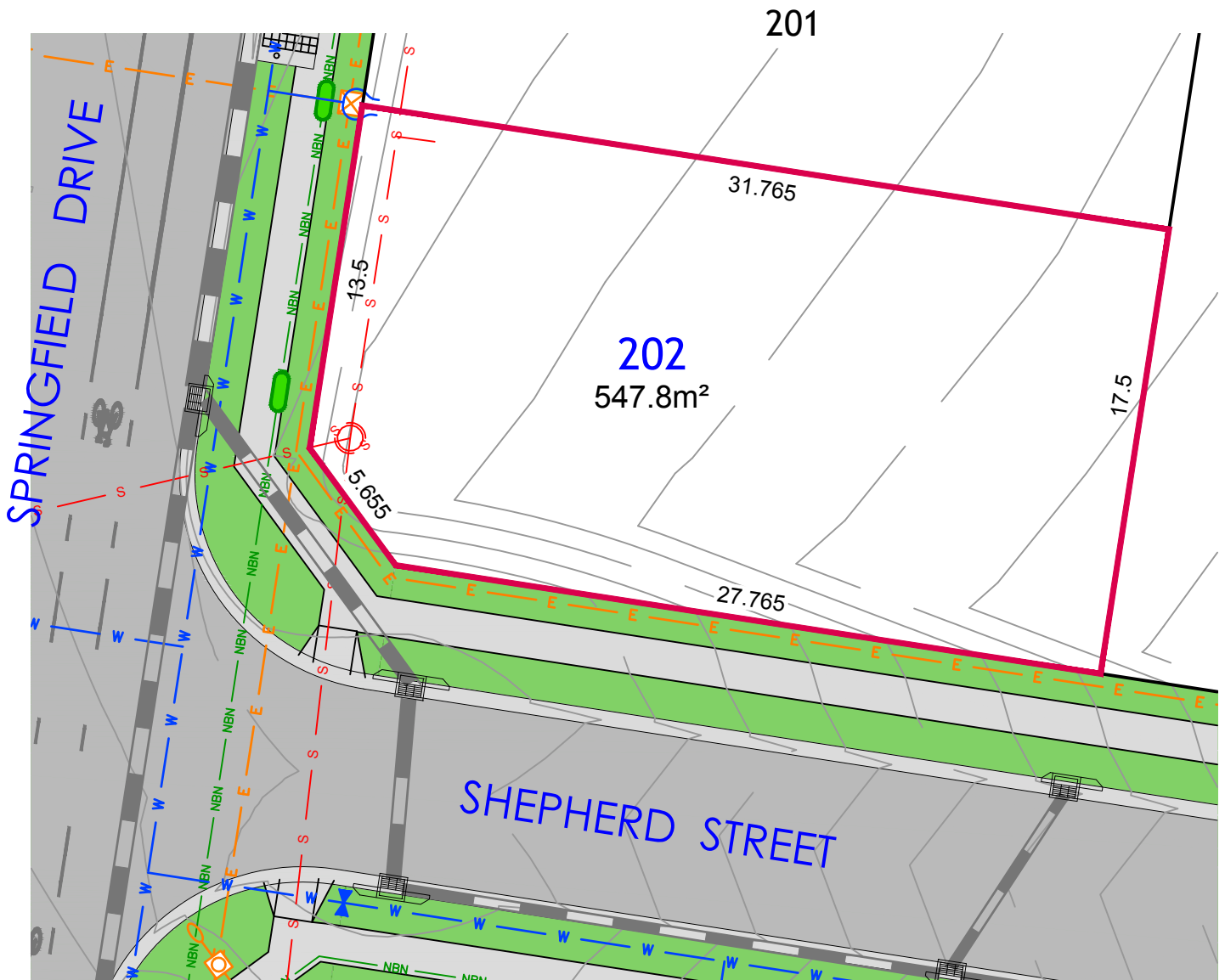

Notes:

- Contour interval is 0.2m. Contours are based on design plan information only, subject to construction.
- Utility servicing details are based on design information. Final location is subject to construction.
- For further information on restriction as to user, positive covenants and easements etc. affecting this lot, interested parties should refer to the Subdivision Plan and 88B Instrument.
- Slab thickness and piling requirements subject to structural design.

Scale: @ A4



G	31/08/2020	Updated Easement	Notation	SS
Ver.	Date	Comment		By





LEGEND

- S Sewer main (DRAFT)
- Sewer Man Hole
- W Water main
- Water Hydrant
- ✕ Water Stop Valve
- E Electricity services
- Street Light
- Electrical Pillar
- NBN NBN
- NBN Pit
- Retaining Wall / Fence
- Design surface contour
- Stormwater pipe
- Stormwater lintel

(BA) EASEMENT TO DRAIN WATER 1.5 WIDE

THE SITE CLASSIFICATION STATED IS TAKEN FROM THE QUALTEST GEOTECHNICAL ASSESSMENT REPORT NEW17P-0054A-AA.REV1 DATED 23RD JUNE 2020 SECTION 5.1. SITE SPECIFIC CLASSIFICATION SHOULD BE UNDERTAKEN SEPARATELY BY BUILDERS. PRELIMINARY SITE CLASSIFICATION: E

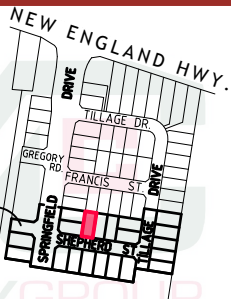

STAGE 2 SITE PLAN

Note: Gas servicing will be provided but design is not available yet.

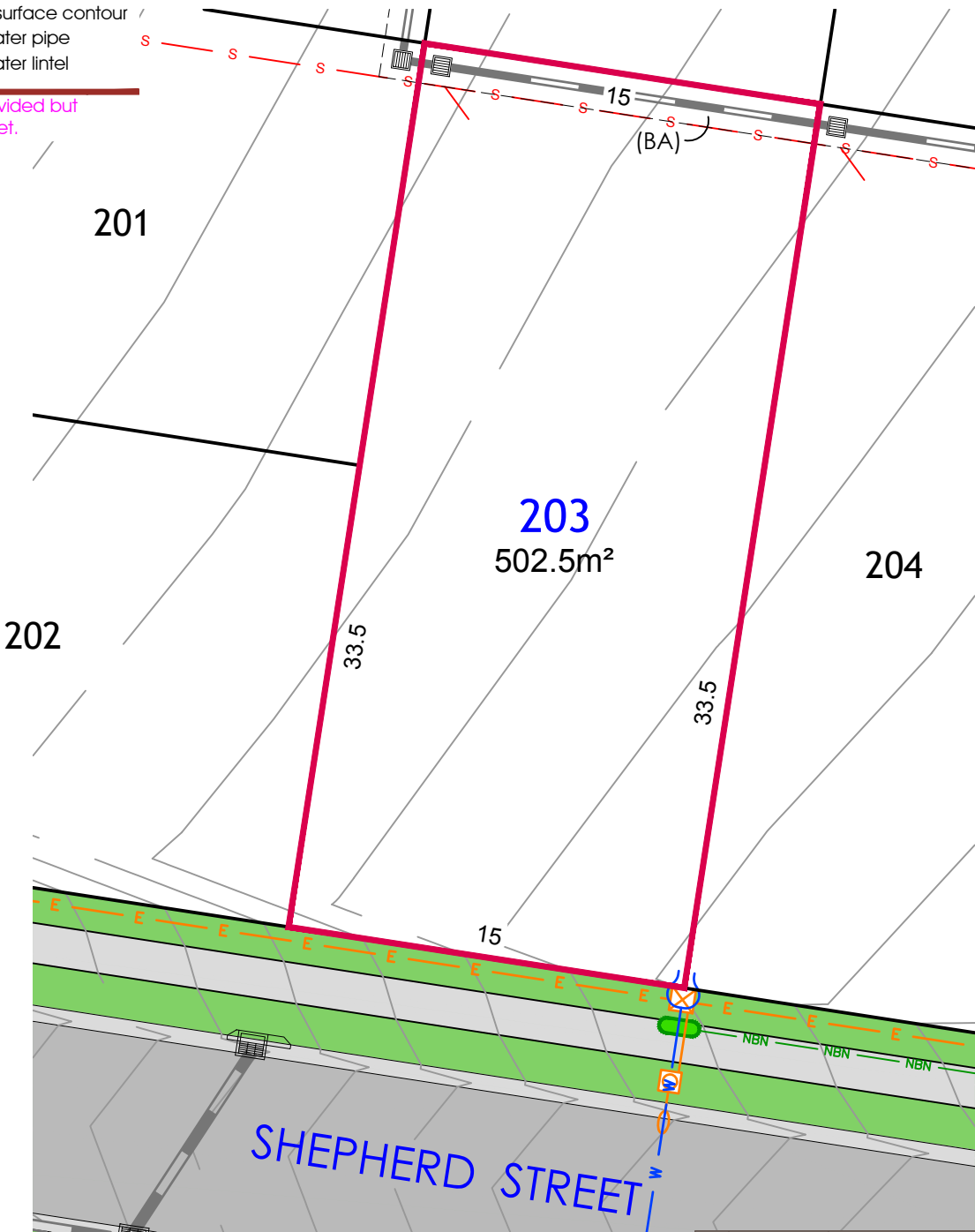

- Notes:
- 1. Contour interval is 0.2m. Contours are based on design plan information only, subject to construction.
 - 2. Utility servicing details are based on design information. Final location is subject to construction.
 - 3. For further information on restriction as to user, positive covenants and easements etc. affecting this lot, interested parties should refer to the Subdivision Plan and 88B Instrument.
 - 4. Slab thickness and piling requirements subject to structural design.

G	31/08/2020	Updated Easement	Notation	SS
Ver.	Date	Comment		By

Scale: @ A4

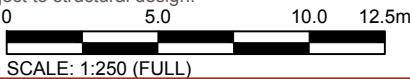

SCALE: 1:250 (FULL)





LEGEND

- S Sewer main (DRAFT)
- Sewer Man Hole
- W Water main
- Water Hydrant
- ✕ Water Stop Valve
- E E Electricity services
- Street Light
- Electrical Pillar
- NBN NBN
- NBN Pit
- Retaining Wall / Fence
- Design surface contour
- Stormwater pipe
- Stormwater lintel

(BA) EASEMENT TO DRAIN WATER 1.5 WIDE

THE SITE CLASSIFICATION STATED IS TAKEN FROM THE QUALTEST GEOTECHNICAL ASSESSMENT REPORT NEW17P-0054A-AA.REV1 DATED 23RD JUNE 2020 SECTION 5.1. SITE SPECIFIC CLASSIFICATION SHOULD BE UNDERTAKEN SEPARATELY BY BUILDERS. PRELIMINARY SITE CLASSIFICATION: E

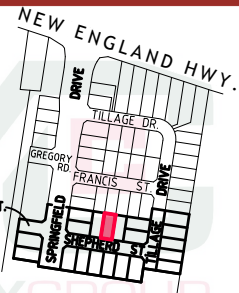

STAGE 2 SITE PLAN

Note: Gas servicing will be provided but design is not available yet.

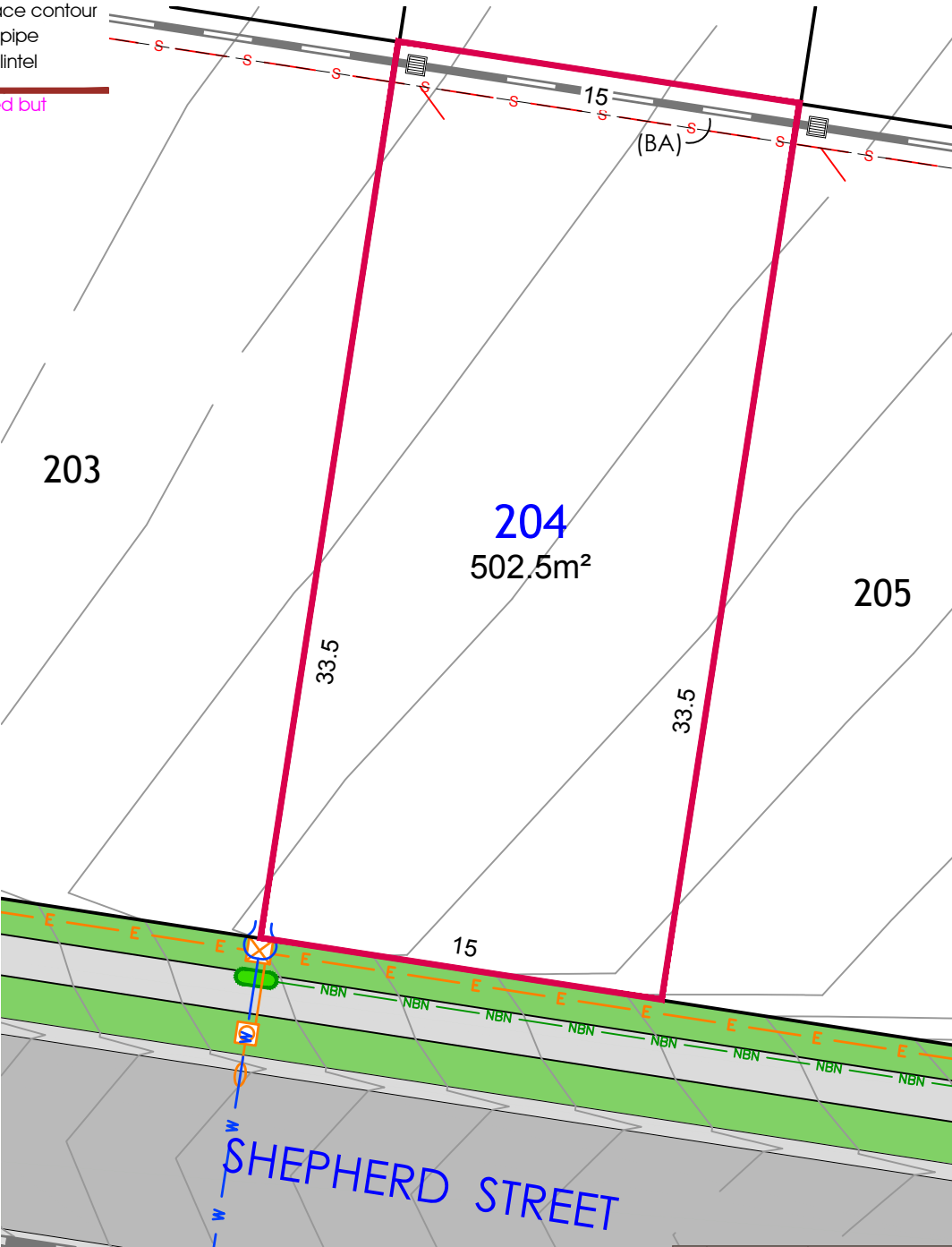

- Notes:
- 1. Contour interval is 0.2m. Contours are based on design plan information only, subject to construction.
 - 2. Utility servicing details are based on design information. Final location is subject to construction.
 - 3. For further information on restriction as to user, positive covenants and easements etc. affecting this lot, interested parties should refer to the Subdivision Plan and 88B Instrument.
 - 4. Slab thickness and piling requirements subject to structural design.

G	31/08/2020	Updated Easement	Notation	SS
Ver.	Date	Comment		By

Scale: @ A4

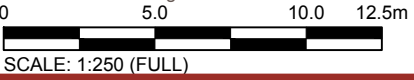

SCALE: 1:250 (FULL)





LEGEND

- S Sewer main (DRAFT)
- Sewer Man Hole
- W Water main
- Water Hydrant
- ✕ Water Stop Valve
- E E Electricity services
- Street Light
- Electrical Pillar
- NBN NBN
- NBN Pit
- Retaining Wall / Fence
- Design surface contour
- Stormwater pipe
- Stormwater lintel

(BA) EASEMENT TO DRAIN WATER 1.5 WIDE

THE SITE CLASSIFICATION STATED IS TAKEN FROM THE QUALTEST GEOTECHNICAL ASSESSMENT REPORT NEW17P-0054A-AA.REV1 DATED 23RD JUNE 2020 SECTION 5.1. SITE SPECIFIC CLASSIFICATION SHOULD BE UNDERTAKEN SEPARATELY BY BUILDERS. PRELIMINARY SITE CLASSIFICATION: E

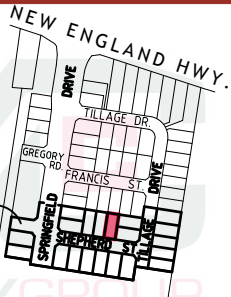

STAGE 2 SITE PLAN

Note: Gas servicing will be provided but design is not available yet.

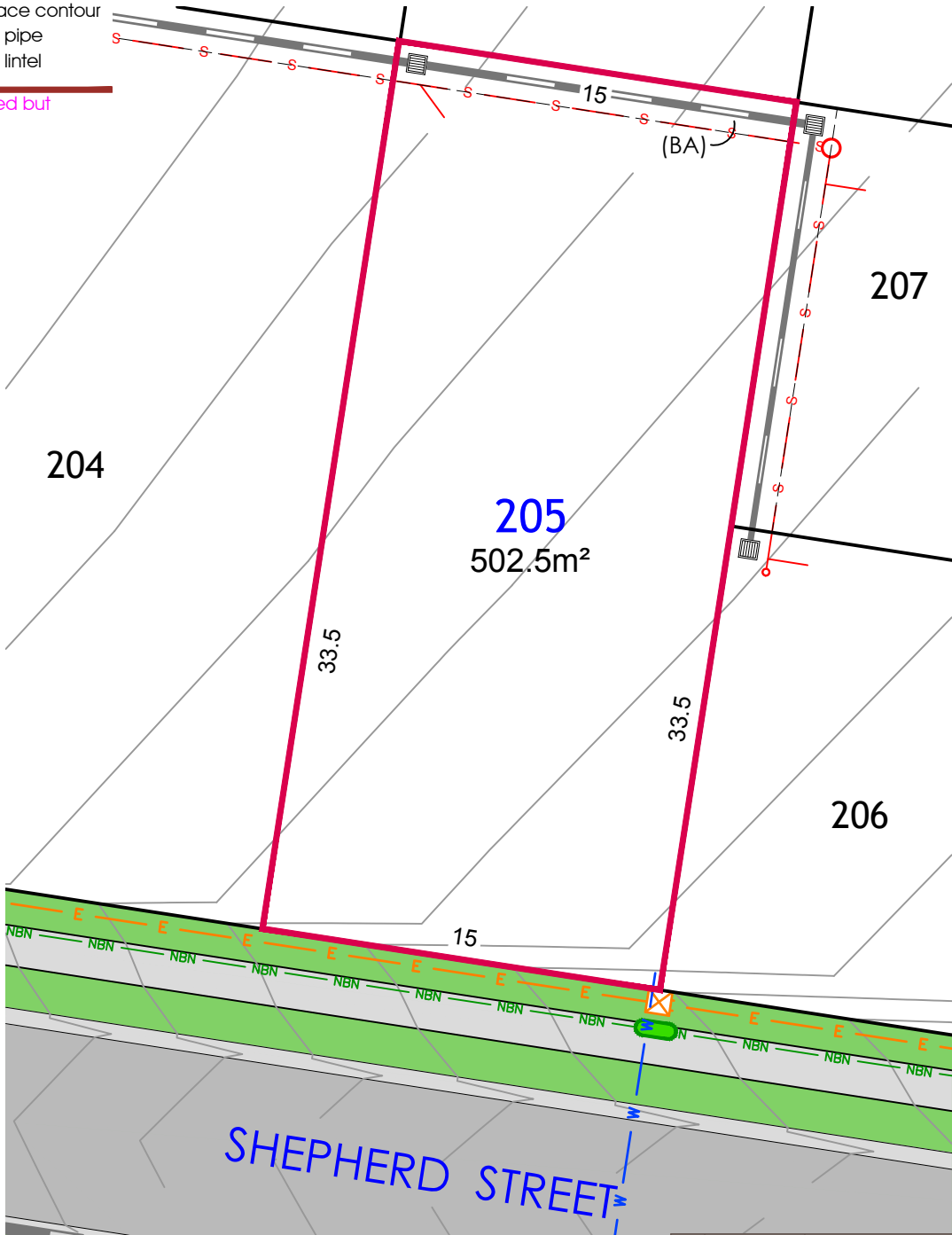

- Notes:
1. Contour interval is 0.2m. Contours are based on design plan information only, subject to construction.
 2. Utility servicing details are based on design information. Final location is subject to construction.
 3. For further information on restriction as to user, positive covenants and easements etc. affecting this lot, interested parties should refer to the Subdivision Plan and 88B Instrument.
 4. Slab thickness and piling requirements subject to structural design.

Scale: @ A4

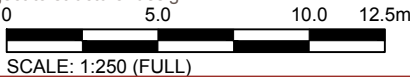

SCALE: 1:250 (FULL)

G	31/08/2020	Updated Easement	Notation	SS
Ver.	Date	Comment	By	



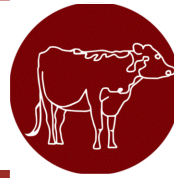

LEGEND

— S —	Sewer main (DRAFT)
○	Sewer Man Hole
— W —	Water main
●	Water Hydrant
X	Water Stop Valve
— E —	Electricity services
□	Street Light
X	Electrical Pillar
— NBN —	NBN
●	NBN Pit
/	Retaining Wall / Fence
—	Design surface contour
—	Stormwater pipe
—	Stormwater lintel

(BA) EASEMENT TO DRAIN WATER 1.5 WIDE

THE SITE CLASSIFICATION STATED IS TAKEN FROM THE QUALTEST GEOTECHNICAL ASSESSMENT REPORT NEW17P-0054A-AA.REV1 DATED 23RD JUNE 2020 SECTION 5.1. SITE SPECIFIC CLASSIFICATION SHOULD BE UNDERTAKEN SEPARATELY BY BUILDERS. PRELIMINARY SITE CLASSIFICATION: E

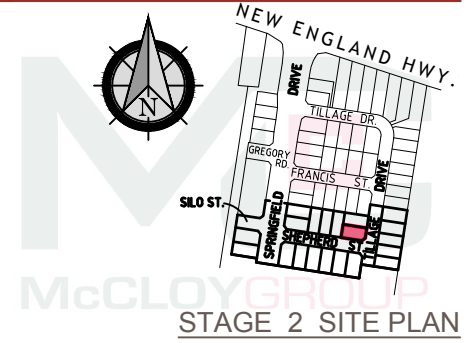

Note: Gas servicing will be provided but design is not available yet.

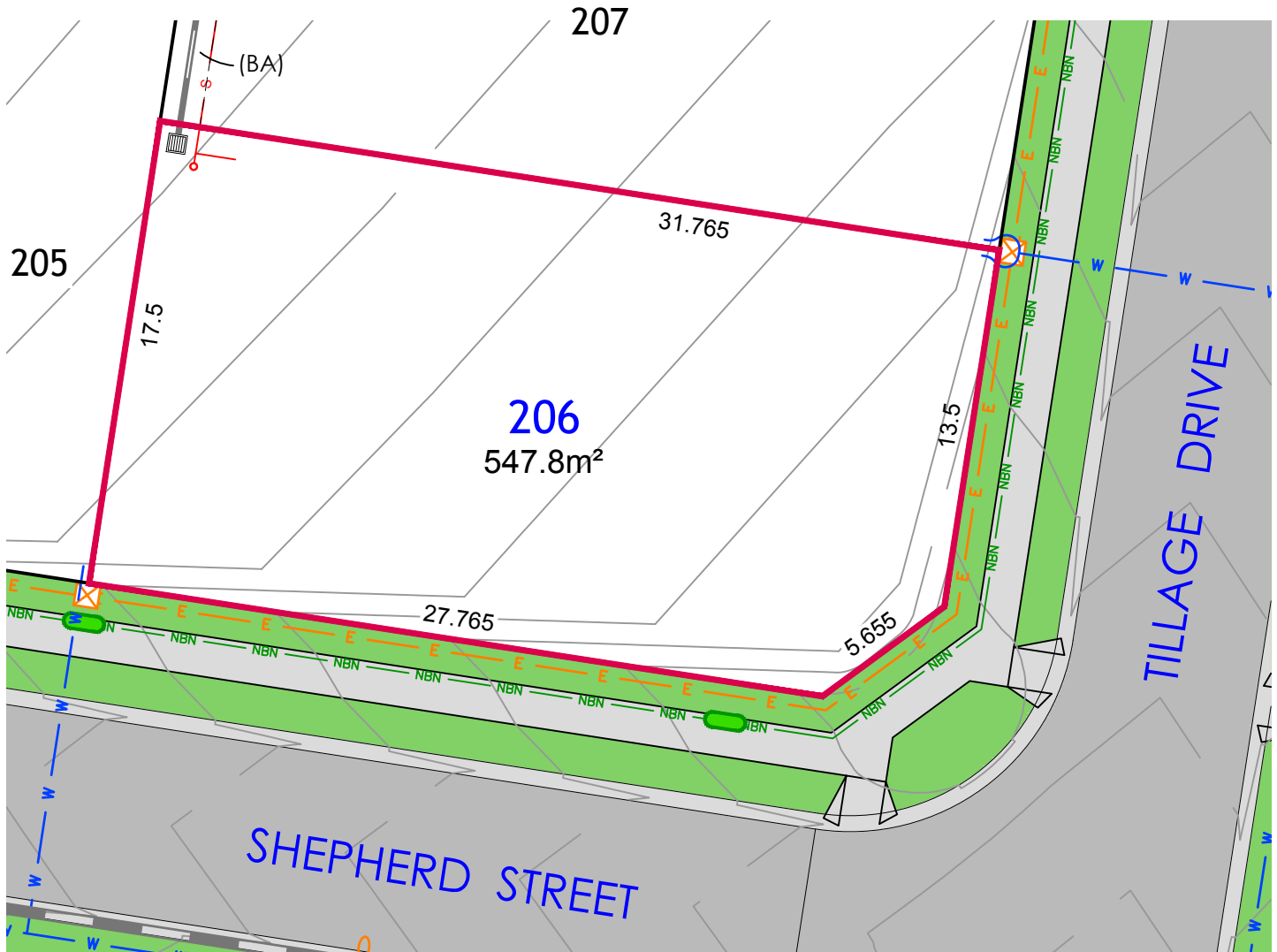

Notes:

- Contour interval is 0.2m. Contours are based on design plan information only, subject to construction.
- Utility servicing details are based on design information. Final location is subject to construction.
- For further information on restriction as to user, positive covenants and easements etc. affecting this lot, interested parties should refer to the Subdivision Plan and 88B Instrument.
- Slab thickness and piling requirements subject to structural design.

Scale: @ A4

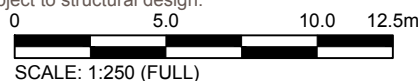

G	31/08/2020	Updated Easement	Notation	SS
Ver.	Date	Comment		By



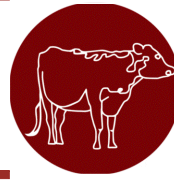

LEGEND

- S — Sewer main (DRAFT)
- Sewer Man Hole
- W — Water main
- Water Hydrant
- X Water Stop Valve
- E — Electricity services
- Street Light
- X Electrical Pillar
- NBN — NBN
- NBN Pit
- / — Retaining Wall / Fence
- Design surface contour
- Stormwater pipe
- Stormwater lintel

(BA) EASEMENT TO DRAIN WATER 1.5 WIDE

THE SITE CLASSIFICATION STATED IS TAKEN FROM THE QUALTEST GEOTECHNICAL ASSESSMENT REPORT NEW17P-0054A-AA.REV1 DATED 23RD JUNE 2020 SECTION 5.1. SITE SPECIFIC CLASSIFICATION SHOULD BE UNDERTAKEN SEPARATELY BY BUILDERS. PRELIMINARY SITE CLASSIFICATION: E

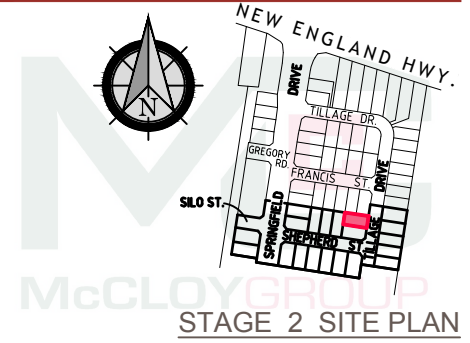

Note: Gas servicing will be provided but design is not available yet.

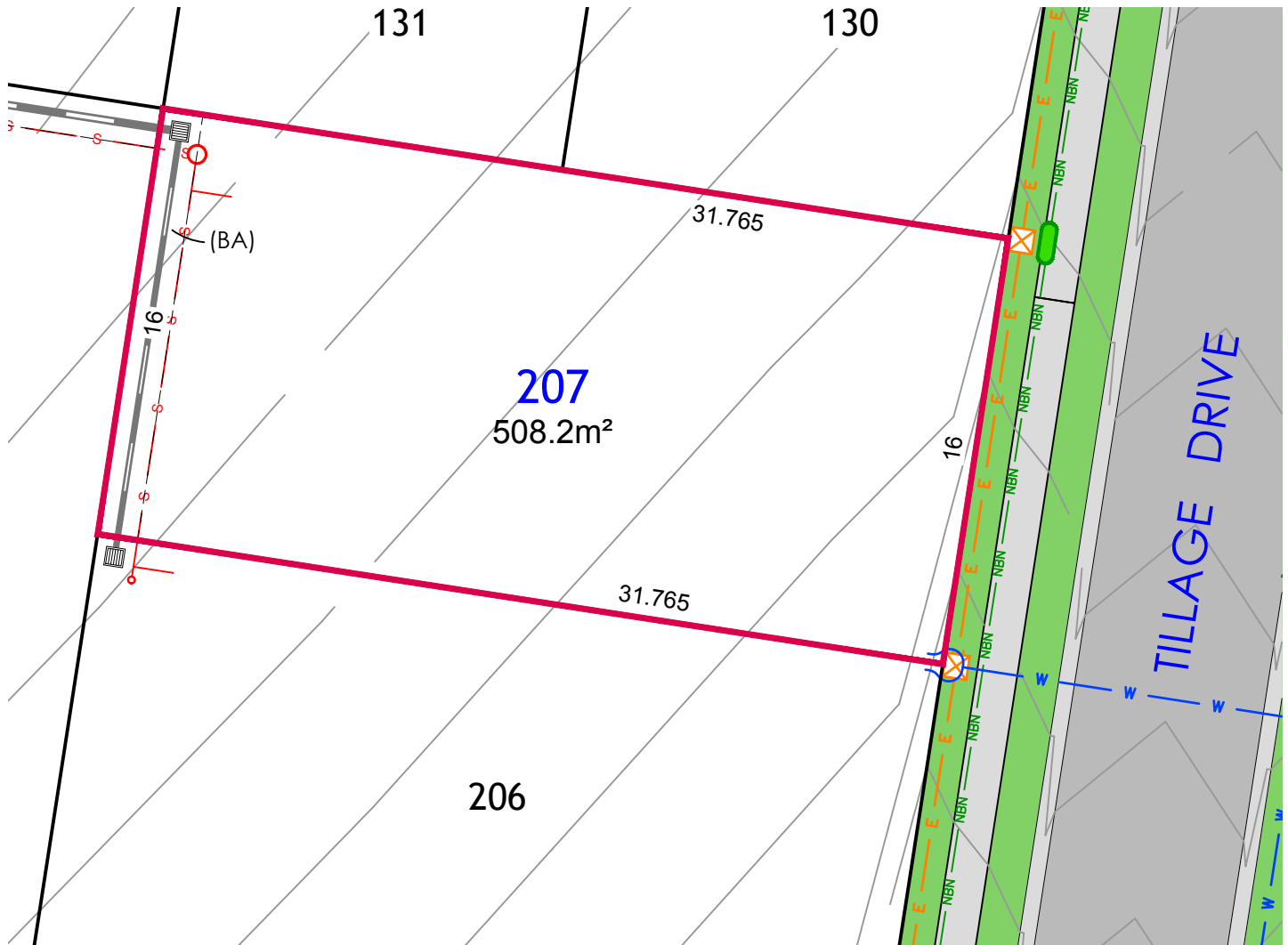

Notes:

1. Contour interval is 0.2m. Contours are based on design plan information only, subject to construction.
2. Utility servicing details are based on design information. Final location is subject to construction.
3. For further information on restriction as to user, positive covenants and easements etc. affecting this lot, interested parties should refer to the Subdivision Plan and 88B Instrument.
4. Slab thickness and piling requirements subject to structural design.

Scale: @ A4

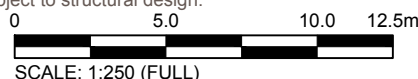

G	31/08/2020	Updated Easement	Notation	SS
Ver.	Date	Comment	By	



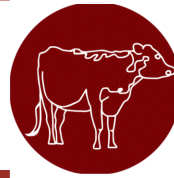

LEGEND

— S —	Sewer main (DRAFT)
○	Sewer Man Hole
— W —	Water main
●	Water Hydrant
X	Water Stop Valve
— E —	Electricity services
□	Street Light
X	Electrical Pillar
— NBN —	NBN
●	NBN Pit
— / —	Retaining Wall / Fence
—	Design surface contour
—	Stormwater pipe
□	Stormwater lintel

THE SITE CLASSIFICATION STATED IS TAKEN FROM THE QUALTEST GEOTECHNICAL ASSESSMENT REPORT NEW17P-0054A-AA.REV1 DATED 23RD JUNE 2020 SECTION 5.1. SITE SPECIFIC CLASSIFICATION SHOULD BE UNDERTAKEN SEPARATELY BY BUILDERS.
PRELIMINARY SITE CLASSIFICATION: E

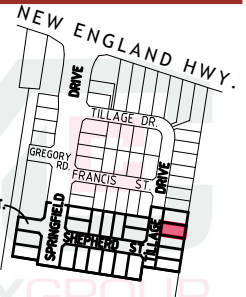

McCLOY GROUP
STAGE 2 SITE PLAN

Note: Gas servicing will be provided but design is not available yet.

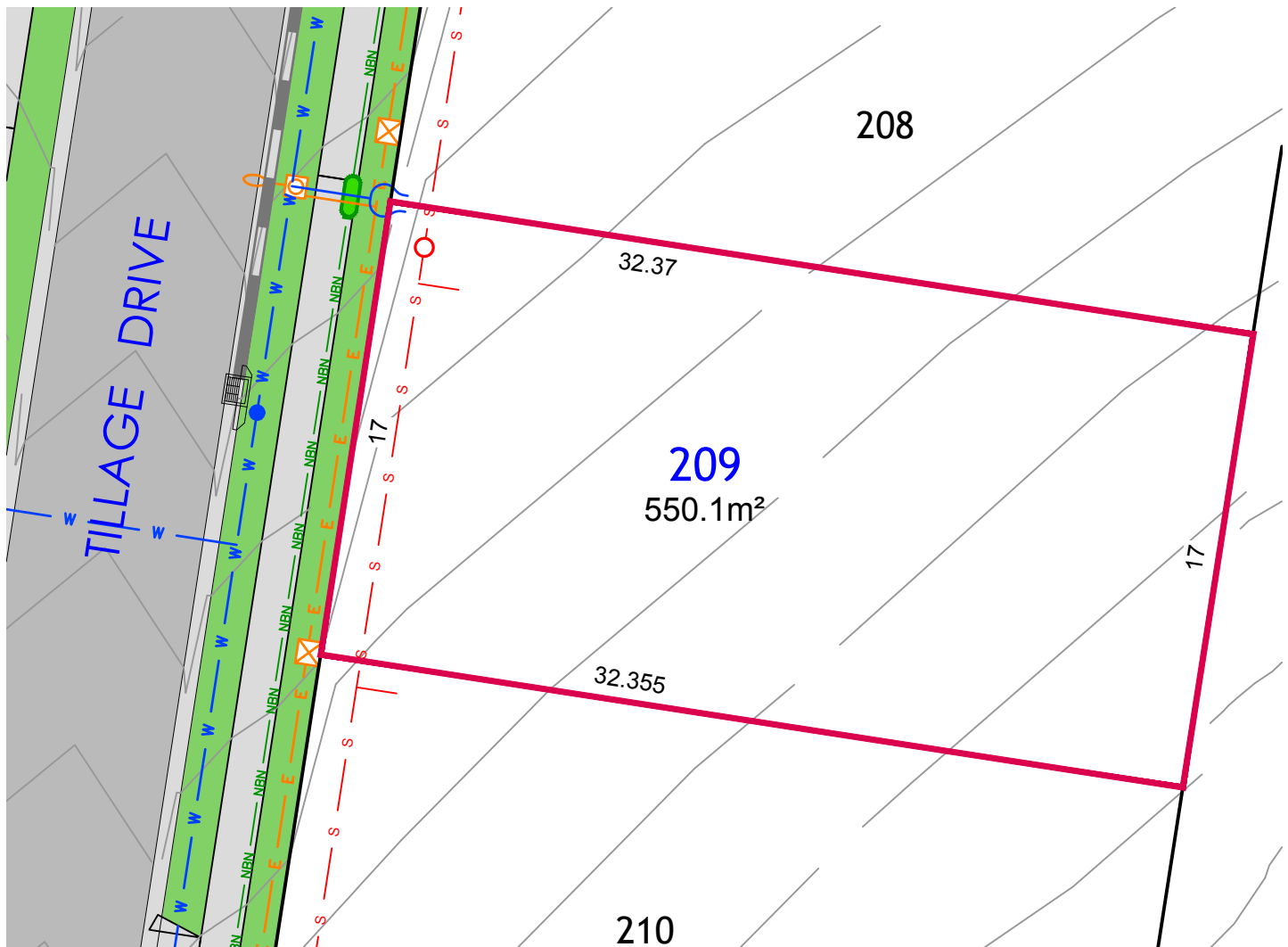

Notes:

1. Contour interval is 0.2m. Contours are based on design plan information only, subject to construction.
2. Utility servicing details are based on design information. Final location is subject to construction.
3. For further information on restriction as to user, positive covenants and easements etc. affecting this lot, interested parties should refer to the Subdivision Plan and 88B Instrument.
4. Slab thickness and piling requirements subject to structural design.

Scale: @ A4



G	31/08/2020	Updated Easement	Notation	SS
Ver.	Date	Comment		By



Lot 210

NEW ENGLAND HIGHWAY

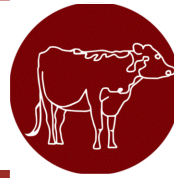

HEREFORD HILL

• LOCHINVAR •

LEGEND

- S — Sewer main (DRAFT)
- Sewer Man Hole
- W — Water main
- Water Hydrant
- X Water Stop Valve
- E — Electricity services
- Street Light
- Electrical Pillar
- NBN — NBN
- NBN Pit
- / — Retaining Wall / Fence
- Design surface contour
- Stormwater pipe
- Stormwater intel

THE SITE CLASSIFICATION STATED IS TAKEN FROM THE QUALTEST GEOTECHNICAL ASSESSMENT REPORT NEW17P-0054A-AA.REV1 DATED 23RD JUNE 2020 SECTION 5.1. SITE SPECIFIC CLASSIFICATION SHOULD BE UNDERTAKEN SEPARATELY BY BUILDERS. PRELIMINARY SITE CLASSIFICATION: E

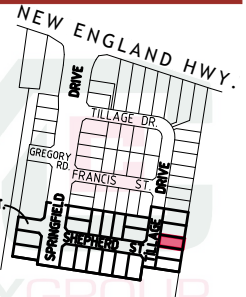

McCLOY GROUP
STAGE 2 SITE PLAN

Note: Gas servicing will be provided but design is not available yet.

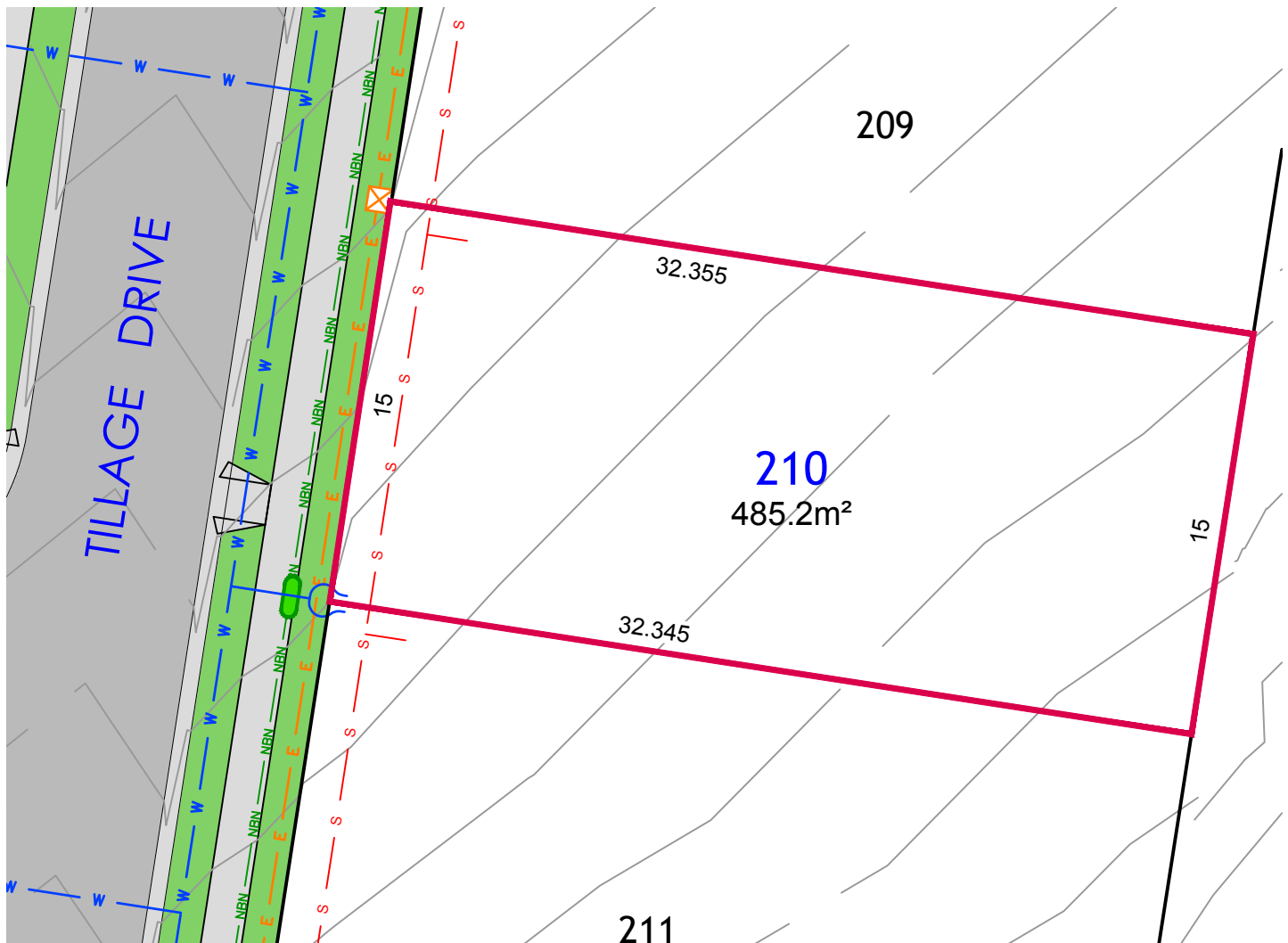

Notes:

1. Contour interval is 0.2m. Contours are based on design plan information only, subject to construction.
2. Utility servicing details are based on design information. Final location is subject to construction.
3. For further information on restriction as to user, positive covenants and easements etc. affecting this lot, interested parties should refer to the Subdivision Plan and 88B Instrument.
4. Slab thickness and piling requirements subject to structural design.

Scale: @ A4



SCALE: 1:250 (FULL)

G	31/08/2020	Updated Easement	Notation	SS
Ver.	Date	Comment	By	



herefordhill.com.au

mccloygroup.com.au

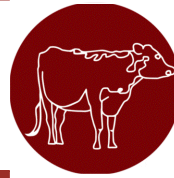

LEGEND

— S —	Sewer main (DRAFT)
○	Sewer Man Hole
— W —	Water main
●	Water Hydrant
X	Water Stop Valve
— E —	Electricity services
□	Street Light
□	Electrical Pillar
— NBN —	NBN
●	NBN Pit
— / —	Retaining Wall / Fence
—	Design surface contour
—	Stormwater pipe
—	Stormwater lintel

THE SITE CLASSIFICATION STATED IS TAKEN FROM THE QUALTEST GEOTECHNICAL ASSESSMENT REPORT NEW17P-0054A-AA.REV1 DATED 23RD JUNE 2020 SECTION 5.1. SITE SPECIFIC CLASSIFICATION SHOULD BE UNDERTAKEN SEPARATELY BY BUILDERS. PRELIMINARY SITE CLASSIFICATION: H2

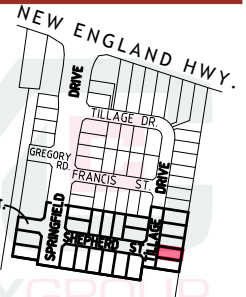

McCLOYGROUP
STAGE 2 SITE PLAN

Note: Gas servicing will be provided but design is not available yet.

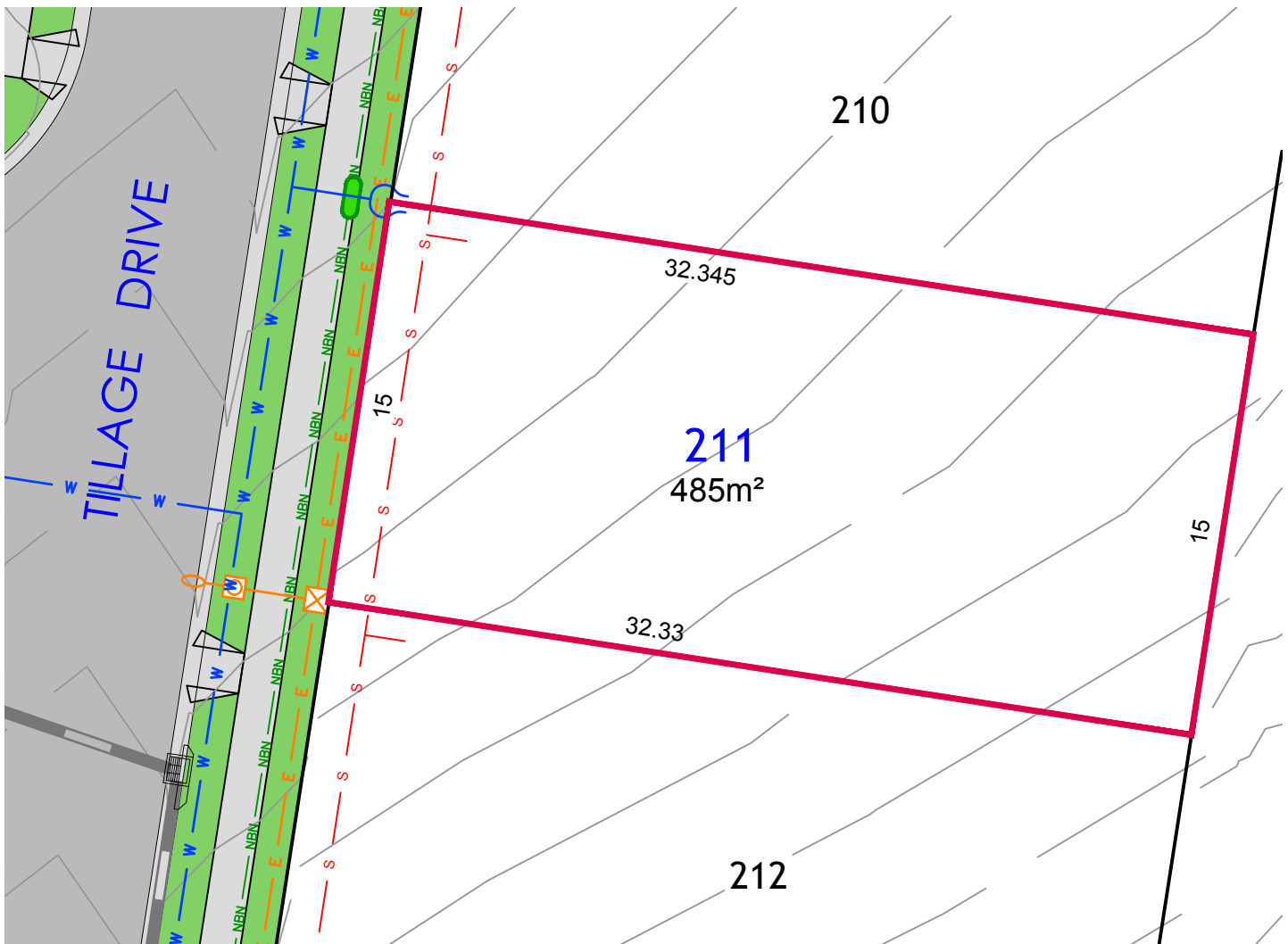

Notes:

1. Contour interval is 0.2m. Contours are based on design plan information only, subject to construction.
2. Utility servicing details are based on design information. Final location is subject to construction.
3. For further information on restriction as to user, positive covenants and easements etc. affecting this lot, interested parties should refer to the Subdivision Plan and 88B Instrument.
4. Slab thickness and piling requirements subject to structural design.

Scale: @ A4



G	31/08/2020	Updated Easement	Notation	SS
Ver.	Date	Comment		By



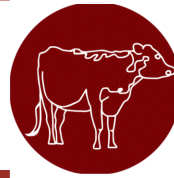

LEGEND

— S —	Sewer main (DRAFT)
○	Sewer Man Hole
— W —	Water main
●	Water Hydrant
X	Water Stop Valve
— E —	Electricity services
⊠	Street Light
⊠	Electrical Pillar
— NBN —	NBN
●	NBN Pit
— / —	Retaining Wall / Fence
—	Design surface contour
—	Stormwater pipe
⊠	Stormwater lintel

THE SITE CLASSIFICATION STATED IS TAKEN FROM THE QUALTEST GEOTECHNICAL ASSESSMENT REPORT NEW17P-0054A-AA.REV1 DATED 23RD JUNE 2020 SECTION 5.1. SITE SPECIFIC CLASSIFICATION SHOULD BE UNDERTAKEN SEPARATELY BY BUILDERS. PRELIMINARY SITE CLASSIFICATION: H2

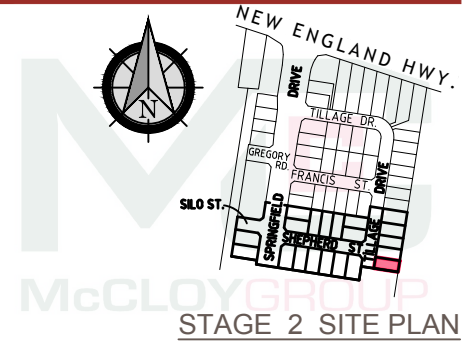

Note: Gas servicing will be provided but design is not available yet.

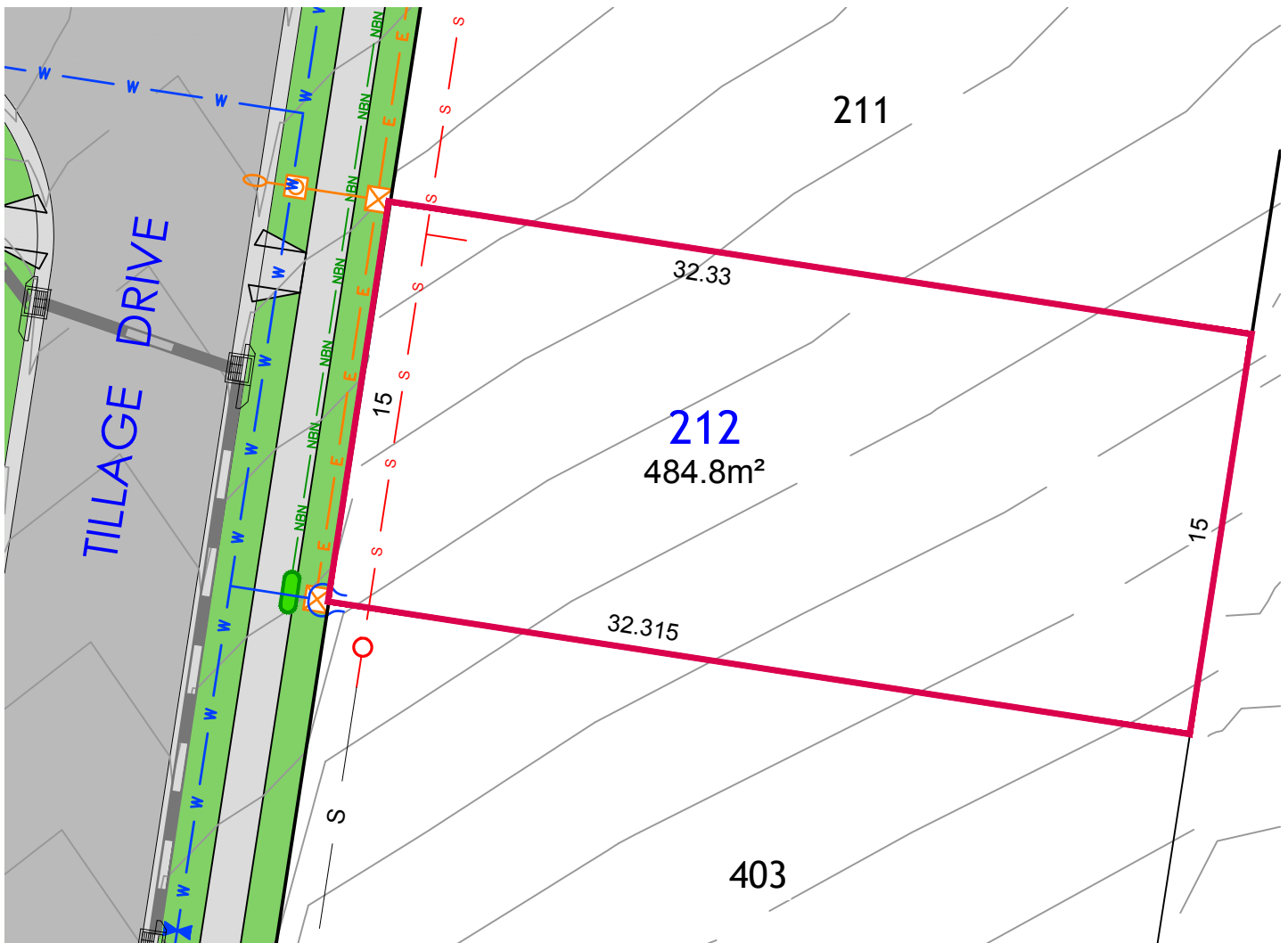

Notes:

1. Contour interval is 0.2m. Contours are based on design plan information only, subject to construction.
2. Utility servicing details are based on design information. Final location is subject to construction.
3. For further information on restriction as to user, positive covenants and easements etc. affecting this lot, interested parties should refer to the Subdivision Plan and 88B Instrument.
4. Slab thickness and piling requirements subject to structural design.

Scale: @ A4

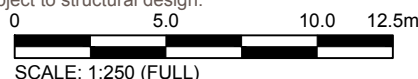

G	31/08/2020	Updated Easement	Notation	SS
Ver.	Date	Comment	By	





LEGEND

- S Sewer main (DRAFT)
- Sewer Man Hole
- W Water main
- Water Hydrant
- ✕ Water Stop Valve
- E Electricity services
- Street Light
- Electrical Pillar
- NBN NBN
- NBN Pit
- Retaining Wall / Fence
- Design surface contour
- Stormwater pipe
- Stormwater lintel

THE SITE CLASSIFICATION STATED IS TAKEN FROM THE QUALTEST GEOTECHNICAL ASSESSMENT REPORT NEW17P-0054A-AA.REV1 DATED 23RD JUNE 2020 SECTION 5.1. SITE SPECIFIC CLASSIFICATION SHOULD BE UNDERTAKEN SEPARATELY BY BUILDERS. PRELIMINARY SITE CLASSIFICATION: H2

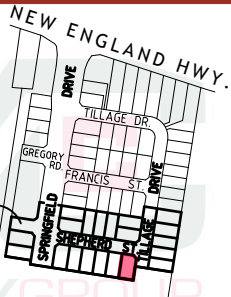

STAGE 2 SITE PLAN

Note: Gas servicing will be provided but design is not available yet.

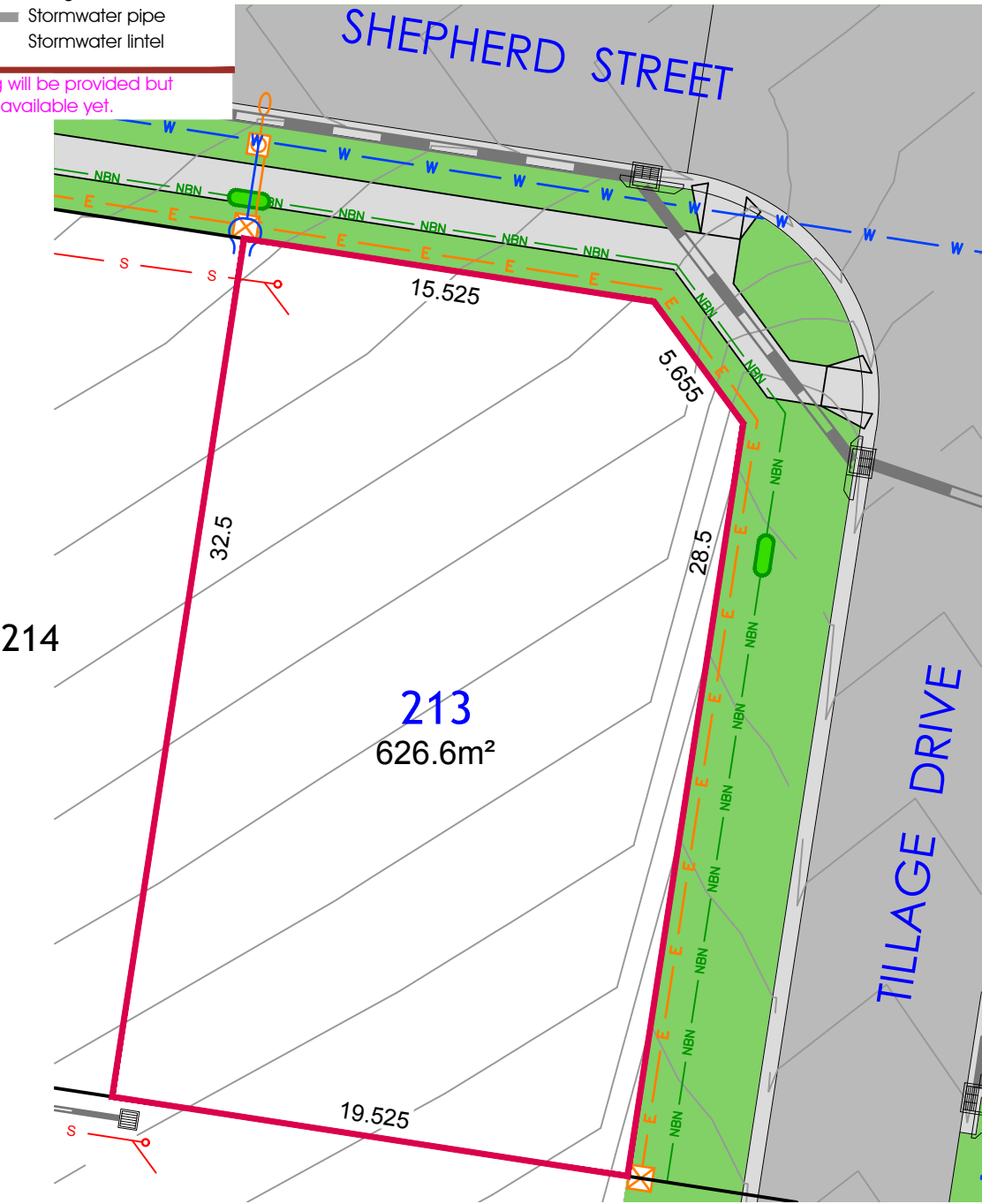

- Notes:
- Contour interval is 0.2m. Contours are based on design plan information only, subject to construction.
 - Utility servicing details are based on design information. Final location is subject to construction.
 - For further information on restriction as to user, positive covenants and easements etc. affecting this lot, interested parties should refer to the Subdivision Plan and 88B Instrument.
 - Slab thickness and piling requirements subject to structural design.

G	31/08/2020	Updated Easement	Notation	SS
Ver.	Date	Comment		By

Scale: @ A4

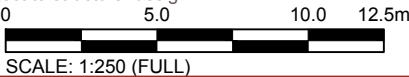

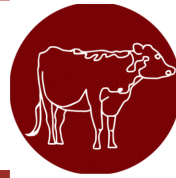

LEGEND

- S — Sewer main (DRAFT)
- Sewer Man Hole
- W — Water main
- Water Hydrant
- X Water Stop Valve
- E — Electricity services
- Street Light
- X Electrical Pillar
- NBN — NBN
- NBN Pit
- / — Retaining Wall / Fence
- Design surface contour
- Stormwater pipe
- Stormwater lintel

THE SITE CLASSIFICATION STATED IS TAKEN FROM THE QUALTEST GEOTECHNICAL ASSESSMENT REPORT NEW17P-0054A-AA.REV1 DATED 23RD JUNE 2020 SECTION 5.1. SITE SPECIFIC CLASSIFICATION SHOULD BE UNDERTAKEN SEPARATELY BY BUILDERS. PRELIMINARY SITE CLASSIFICATION: H2

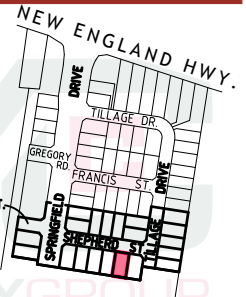

McCLOYGROUP
STAGE 2 SITE PLAN

Note: Gas servicing will be provided but design is not available yet.

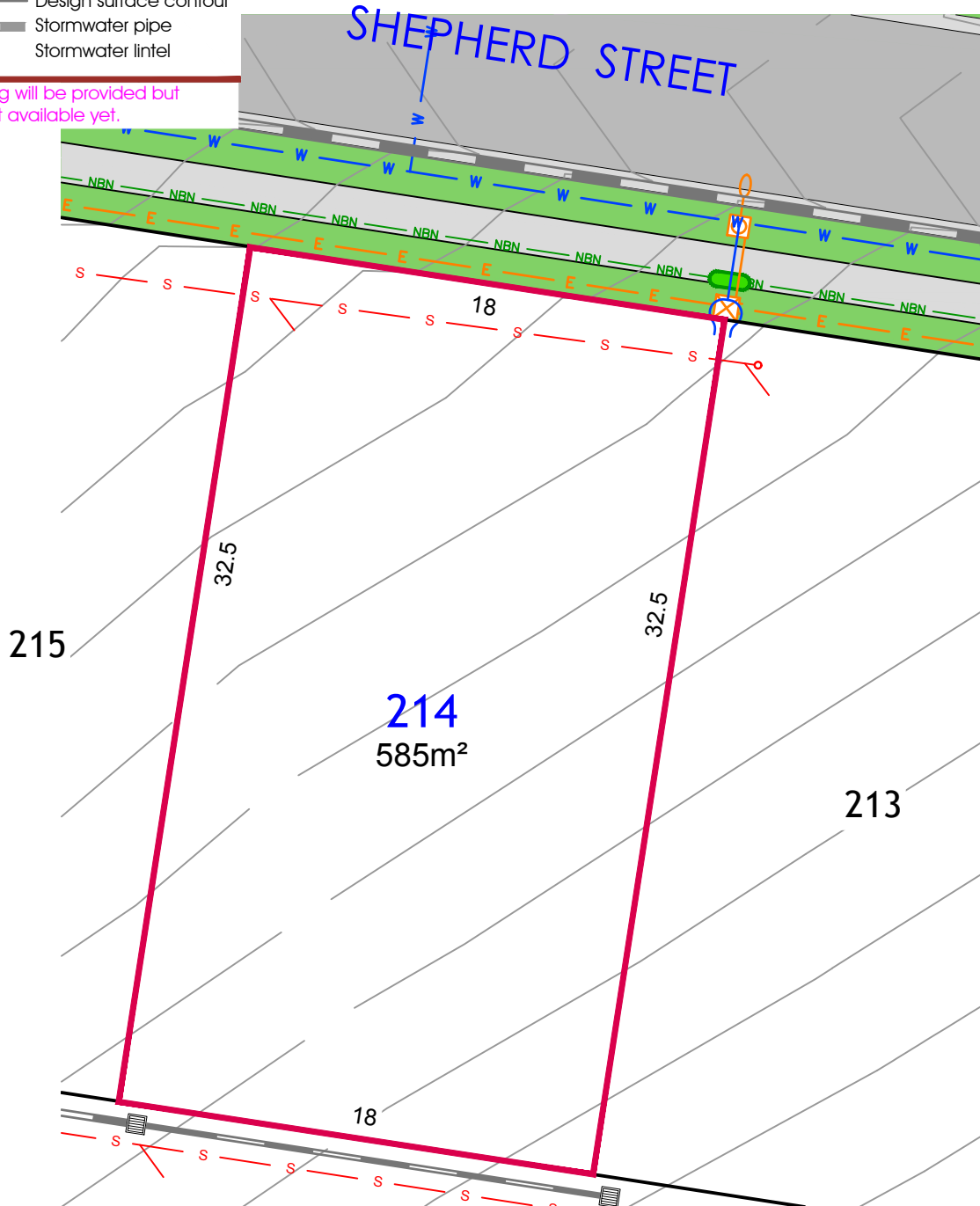

Notes:

1. Contour interval is 0.2m. Contours are based on design plan information only, subject to construction.
2. Utility servicing details are based on design information. Final location is subject to construction.
3. For further information on restriction as to user, positive covenants and easements etc. affecting this lot, interested parties should refer to the Subdivision Plan and 88B Instrument.
4. Slab thickness and piling requirements subject to structural design.

Scale: @ A4



G	31/08/2020	Updated Easement	Notation	SS
Ver.	Date	Comment		By



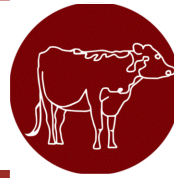

LEGEND

- S — Sewer main (DRAFT)
- Sewer Man Hole
- W — Water main
- Water Hydrant
- X Water Stop Valve
- E — Electricity services
- Street Light
- X Electrical Pillar
- NBN — NBN
- NBN Pit
- / Retaining Wall / Fence
- Design surface contour
- Stormwater pipe
- Stormwater lintel

THE SITE CLASSIFICATION STATED IS TAKEN FROM THE QUALTEST GEOTECHNICAL ASSESSMENT REPORT NEW17P-0054A-AA.REV1 DATED 23RD JUNE 2020 SECTION 5.1. SITE SPECIFIC CLASSIFICATION SHOULD BE UNDERTAKEN SEPARATELY BY BUILDERS. PRELIMINARY SITE CLASSIFICATION: H2

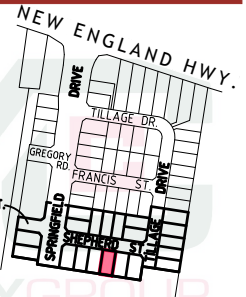

McCLOY GROUP
STAGE 2 SITE PLAN

Note: Gas servicing will be provided but design is not available yet.

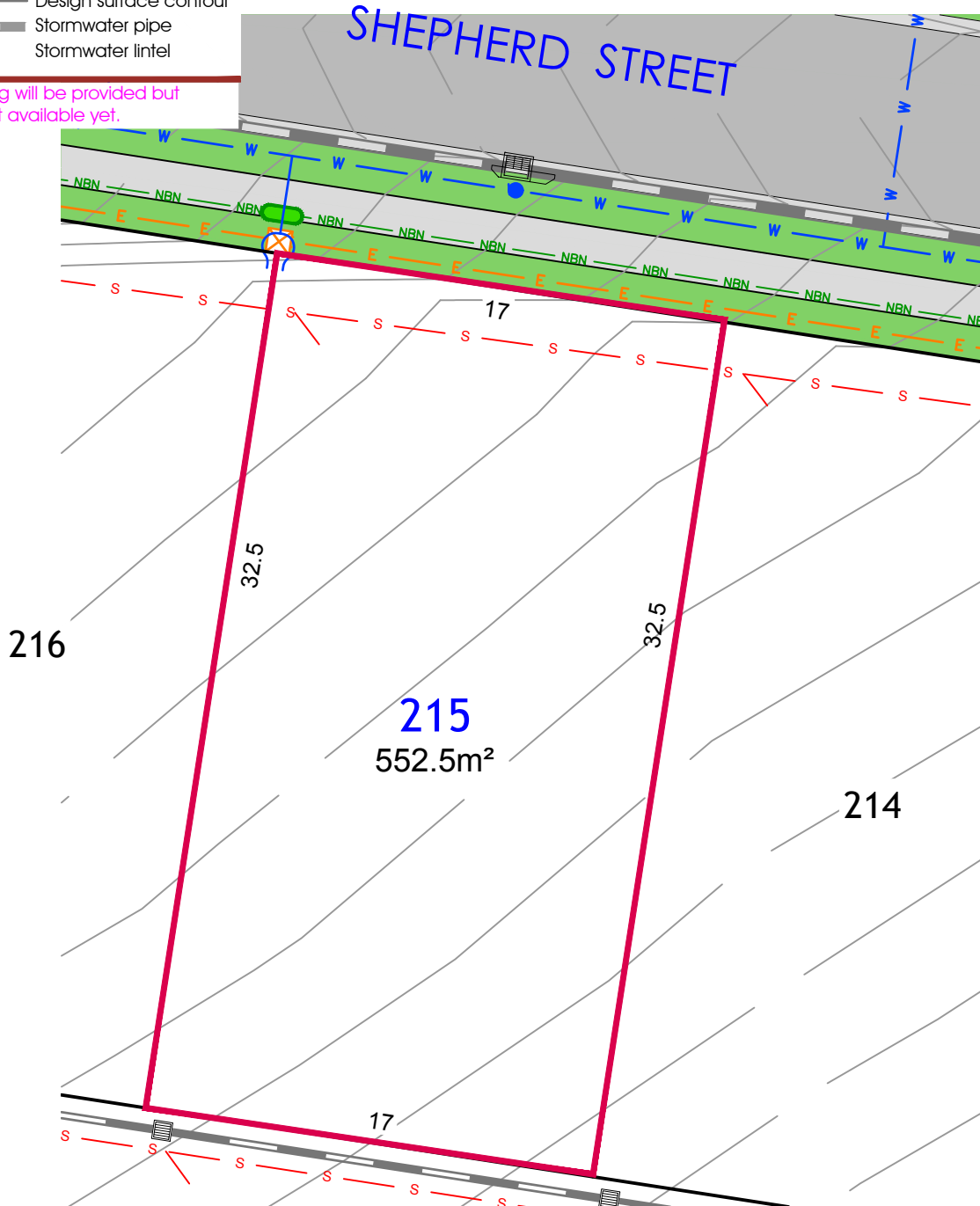

Notes:

1. Contour interval is 0.2m. Contours are based on design plan information only, subject to construction.
2. Utility servicing details are based on design information. Final location is subject to construction.
3. For further information on restriction as to user, positive covenants and easements etc. affecting this lot, interested parties should refer to the Subdivision Plan and 88B Instrument.
4. Slab thickness and piling requirements subject to structural design.

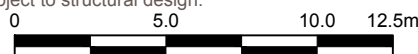

Scale: @ A4

SCALE: 1:250 (FULL)

G	31/08/2020	Updated Easement	Notation	SS
Ver.	Date	Comment		By



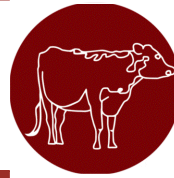

LEGEND

- S — Sewer main (DRAFT)
- Sewer Man Hole
- W — Water main
- Water Hydrant
- X Water Stop Valve
- E — Electricity services
- Street Light
- X Electrical Pillar
- NBN — NBN
- NBN Pit
- / — Retaining Wall / Fence
- Design surface contour
- Stormwater pipe
- Stormwater lintel

THE SITE CLASSIFICATION STATED IS TAKEN FROM THE QUALTEST GEOTECHNICAL ASSESSMENT REPORT NEW17P-0054A-AA.REV1 DATED 23RD JUNE 2020 SECTION 5.1. SITE SPECIFIC CLASSIFICATION SHOULD BE UNDERTAKEN SEPARATELY BY BUILDERS. PRELIMINARY SITE CLASSIFICATION: H2

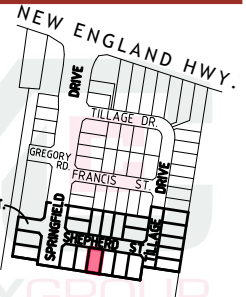

McCLOY GROUP
STAGE 2 SITE PLAN

Note: Gas servicing will be provided but design is not available yet.

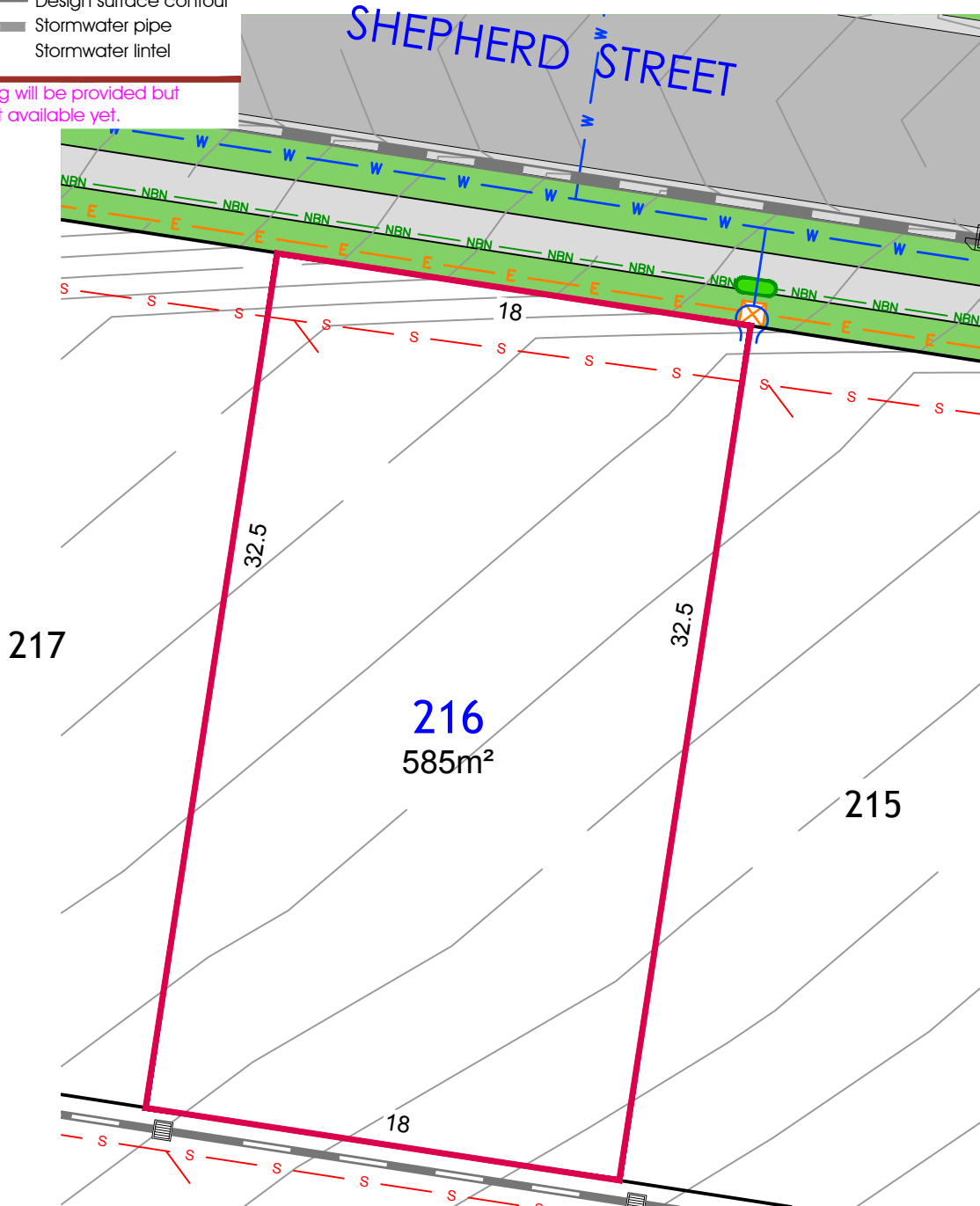

Notes:

1. Contour interval is 0.2m. Contours are based on design plan information only, subject to construction.
2. Utility servicing details are based on design information. Final location is subject to construction.
3. For further information on restriction as to user, positive covenants and easements etc. affecting this lot, interested parties should refer to the Subdivision Plan and 88B Instrument.
4. Slab thickness and piling requirements subject to structural design.

Scale: @ A4

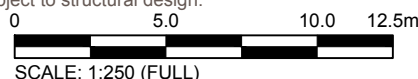

SCALE: 1:250 (FULL)

G	31/08/2020	Updated Easement	Notation	SS
Ver.	Date	Comment		By



Lot 217

NEW ENGLAND HIGHWAY

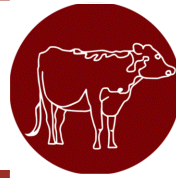

HEREFORD HILL

• LOCHINVAR •

LEGEND

- S — Sewer main (DRAFT)
- Sewer Man Hole
- W — Water main
- Water Hydrant
- X Water Stop Valve
- E — Electricity services
- Street Light
- X Electrical Pillar
- NBN — NBN
- NBN Pit
- / — Retaining Wall / Fence
- Design surface contour
- Stormwater pipe
- Stormwater lintel

THE SITE CLASSIFICATION STATED IS TAKEN FROM THE QUALTEST GEOTECHNICAL ASSESSMENT REPORT NEW17P-0054A-AA.REV1 DATED 23RD JUNE 2020 SECTION 5.1. SITE SPECIFIC CLASSIFICATION SHOULD BE UNDERTAKEN SEPARATELY BY BUILDERS. PRELIMINARY SITE CLASSIFICATION: H2

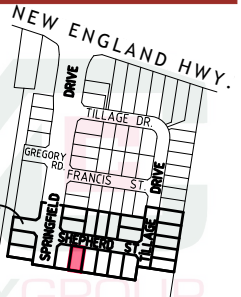

McCLOY GROUP
STAGE 2 SITE PLAN

Note: Gas servicing will be provided but design is not available yet.

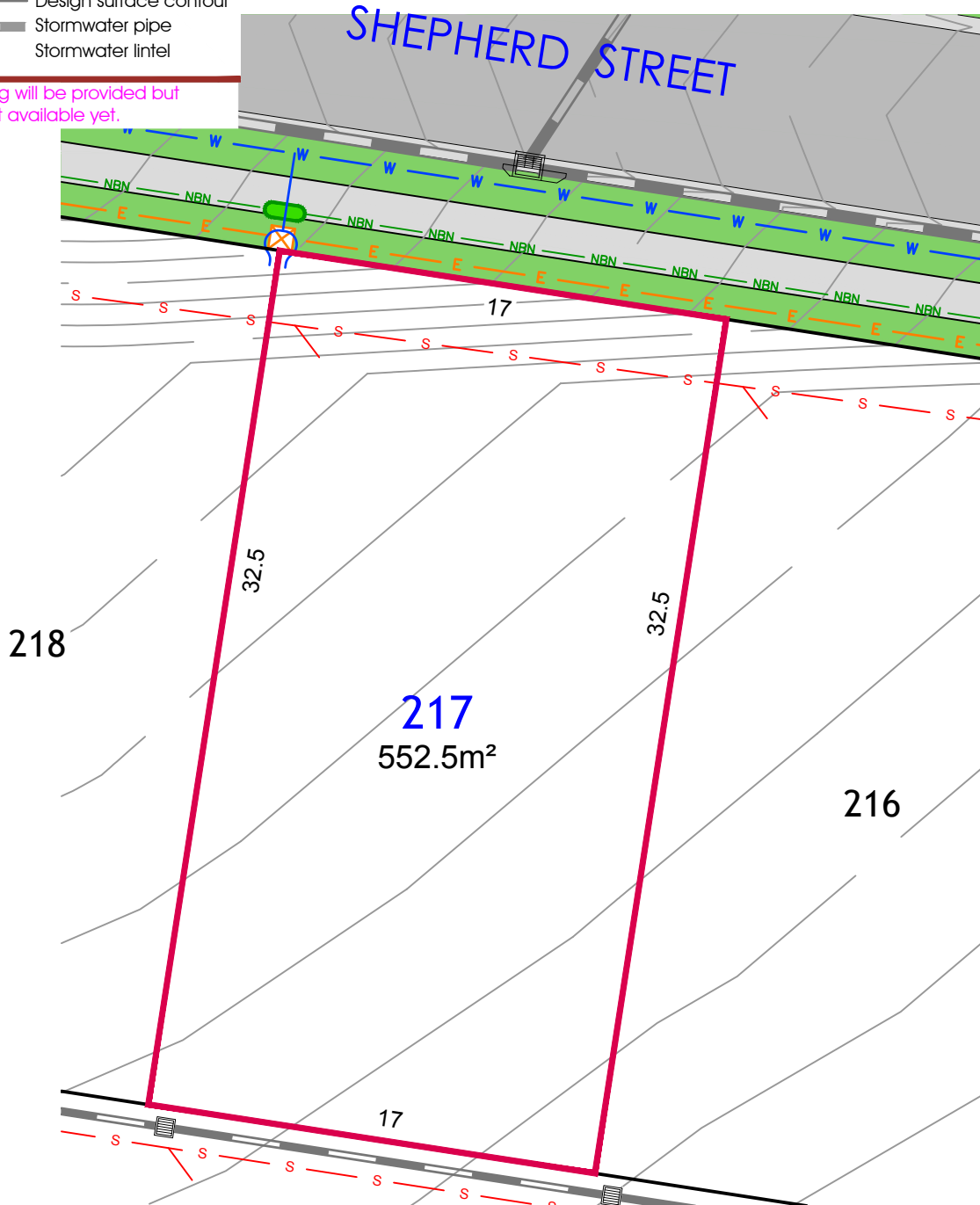

Notes:

1. Contour interval is 0.2m. Contours are based on design plan information only, subject to construction.
2. Utility servicing details are based on design information. Final location is subject to construction.
3. For further information on restriction as to user, positive covenants and easements etc. affecting this lot, interested parties should refer to the Subdivision Plan and 88B Instrument.
4. Slab thickness and piling requirements subject to structural design.

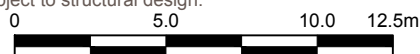

Scale: @ A4

SCALE: 1:250 (FULL)

G	31/08/2020	Updated Easement	Notation	SS
Ver.	Date	Comment		By



herefordhill.com.au

mccloygroup.com.au



LEGEND

- S Sewer main (DRAFT)
- Sewer Man Hole
- W Water main
- Water Hydrant
- ⋈ Water Stop Valve
- E E Electricity services
- ⦿ Street Light
- ⦿ Electrical Pillar
- NBN NBN
- NBN Pit
- Retaining Wall / Fence
- Design surface contour
- Stormwater pipe
- Stormwater lintel

THE SITE CLASSIFICATION STATED IS TAKEN FROM THE QUALTEST GEOTECHNICAL ASSESSMENT REPORT NEW17P-0054A-AA.REV1 DATED 23RD JUNE 2020 SECTION 5.1. SITE SPECIFIC CLASSIFICATION SHOULD BE UNDERTAKEN SEPARATELY BY BUILDERS. PRELIMINARY SITE CLASSIFICATION: H2

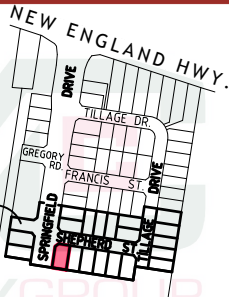

STAGE 2 SITE PLAN

Note: Gas servicing will be provided but design is not available yet.

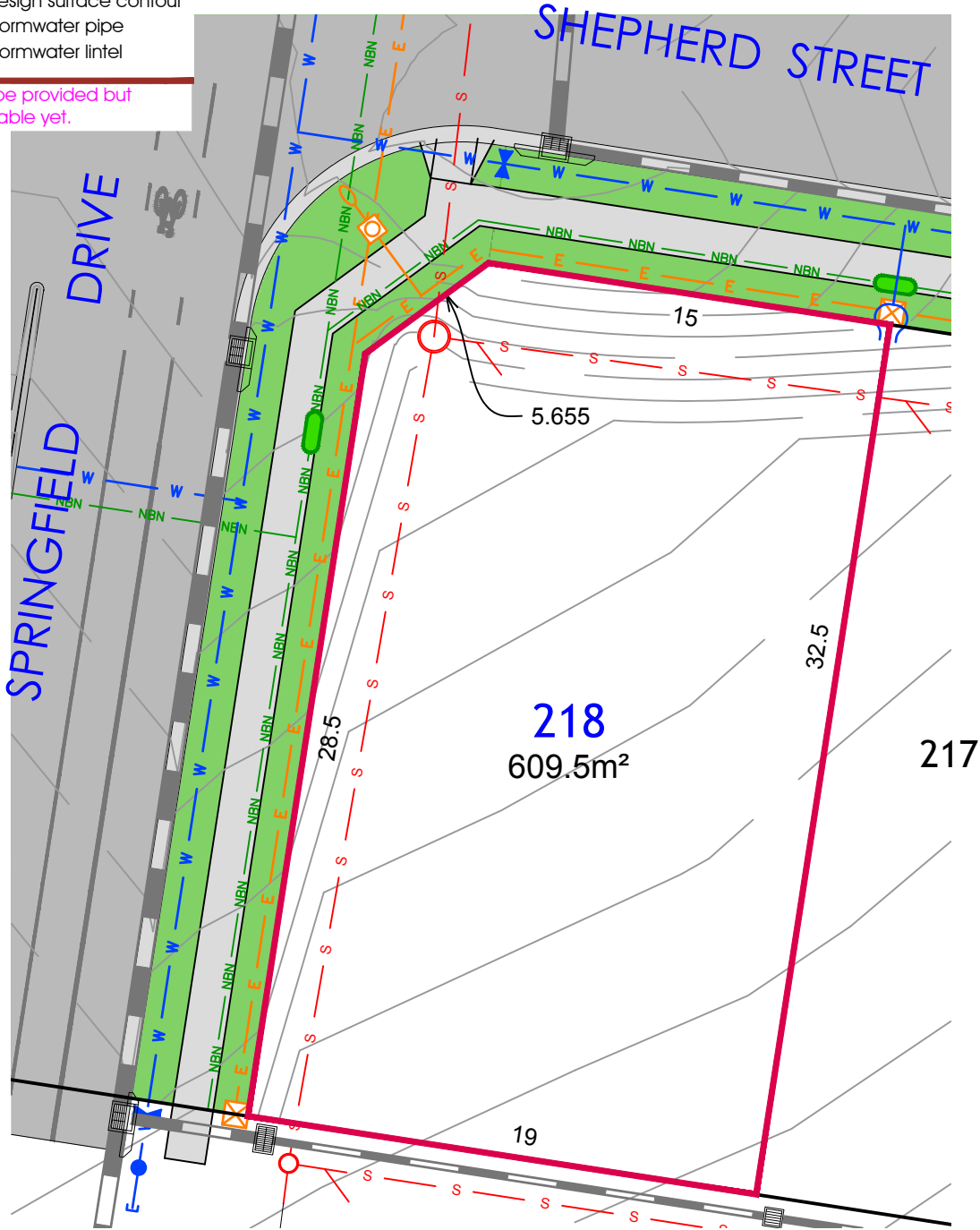

- Notes:
1. Contour interval is 0.2m. Contours are based on design plan information only, subject to construction.
 2. Utility servicing details are based on design information. Final location is subject to construction.
 3. For further information on restriction as to user, positive covenants and easements etc. affecting this lot, interested parties should refer to the Subdivision Plan and 88B Instrument.
 4. Slab thickness and piling requirements subject to structural design.

Scale: @ A4

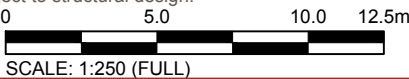

SCALE: 1:250 (FULL)

G	31/08/2020	Updated Easement	Notation	SS
Ver.	Date	Comment		By



Lot 219

NEW ENGLAND HIGHWAY

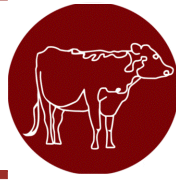

HEREFORD HILL

• LOCHINVAR •

LEGEND

- S — Sewer main (DRAFT)
- Sewer Man Hole
- W — Water main
- Water Hydrant
- X Water Stop Valve
- E — Electricity services
- ⬢ Street Light
- ⊠ Electrical Pillar
- NBN — NBN
- NBN Pit
- ▨ Retaining Wall / Fence
- Design surface contour
- ▬ Stormwater pipe
- ⊠ Stormwater lintel

(BA) EASEMENT TO DRAIN WATER 1.5 WIDE

THE SITE CLASSIFICATION STATED IS TAKEN FROM THE QUALTEST GEOTECHNICAL ASSESSMENT REPORT NEW17P-0054A-AA.REV1 DATED 23RD JUNE 2020 SECTION 5.1. SITE SPECIFIC CLASSIFICATION SHOULD BE UNDERTAKEN SEPARATELY BY BUILDERS. PRELIMINARY SITE CLASSIFICATION: H2

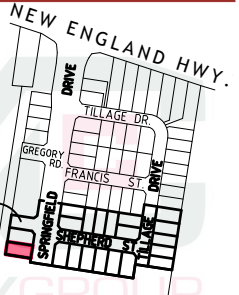

McCLOY GROUP
STAGE 2 SITE PLAN

Note: Gas servicing will be provided but design is not available yet.

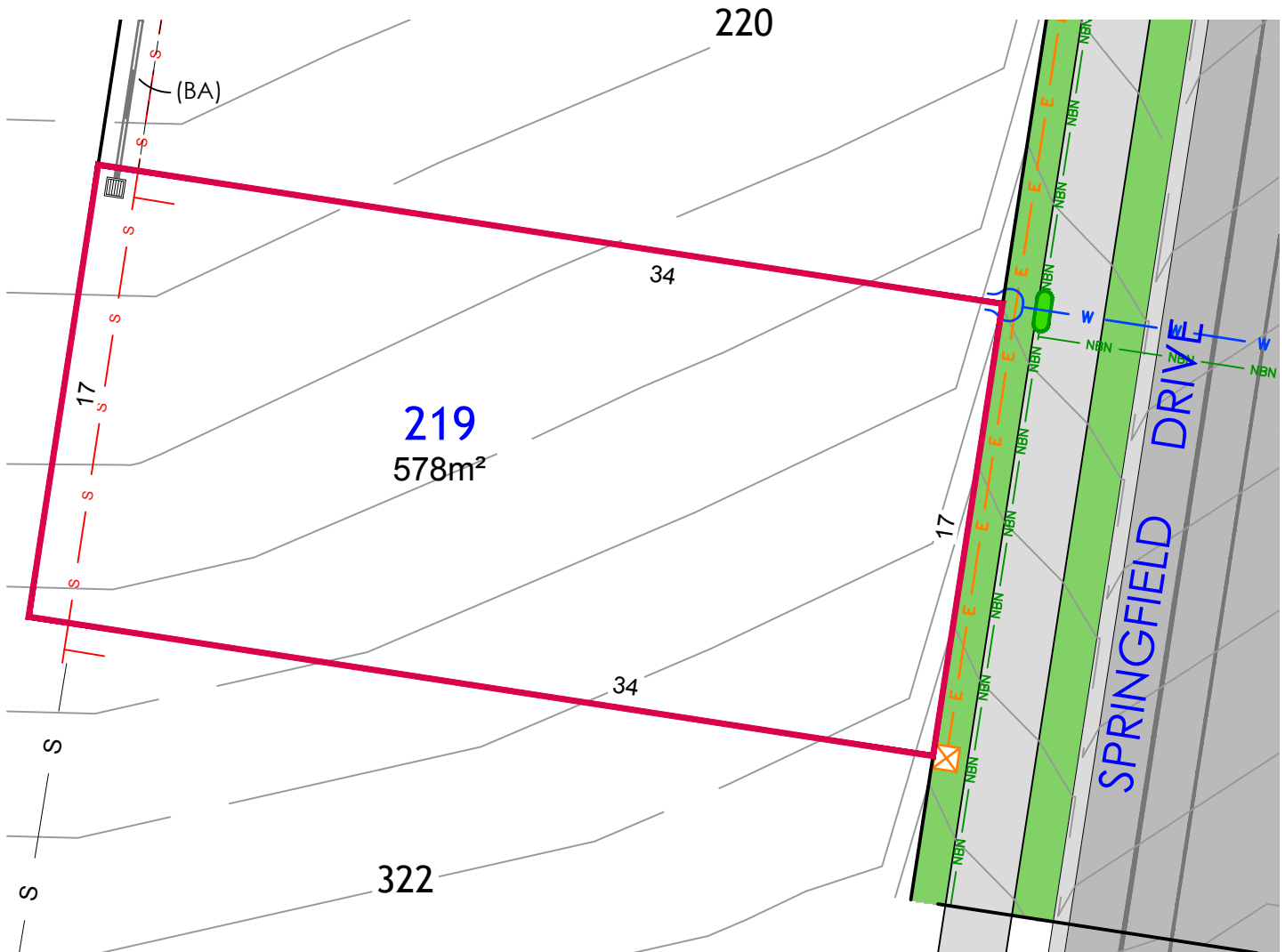

Notes:

1. Contour interval is 0.2m. Contours are based on design plan information only, subject to construction.
2. Utility servicing details are based on design information. Final location is subject to construction.
3. For further information on restriction as to user, positive covenants and easements etc. affecting this lot, interested parties should refer to the Subdivision Plan and 88B Instrument.
4. Slab thickness and piling requirements subject to structural design.

Scale: @ A4



SCALE: 1:250 (FULL)

G	31/08/2020	Updated Easement	Notation	SS
Ver.	Date	Comment		By



herefordhill.com.au

mccloygroup.com.au

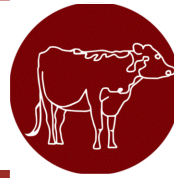

LEGEND

- S — Sewer main (DRAFT)
- Sewer Man Hole
- W — Water main
- Water Hydrant
- X Water Stop Valve
- E — Electricity services
- Street Light
- X Electrical Pillar
- NBN — NBN
- NBN Pit
- ▨ Retaining Wall / Fence
- Design surface contour
- ▬ Stormwater pipe
- ▬ Stormwater lintel

(BA) EASEMENT TO DRAIN WATER 1.5 WIDE

THE SITE CLASSIFICATION STATED IS TAKEN FROM THE QUALTEST GEOTECHNICAL ASSESSMENT REPORT NEW17P-0054A-AA.REV1 DATED 23RD JUNE 2020 SECTION 5.1. SITE SPECIFIC CLASSIFICATION SHOULD BE UNDERTAKEN SEPARATELY BY BUILDERS. PRELIMINARY SITE CLASSIFICATION: H2

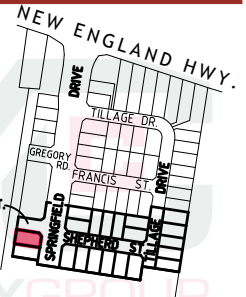

STAGE 2 SITE PLAN

Note: Gas servicing will be provided but design is not available yet.



Notes:

- Contour interval is 0.2m. Contours are based on design plan information only, subject to construction.
- Utility servicing details are based on design information. Final location is subject to construction.
- For further information on restriction as to user, positive covenants and easements etc. affecting this lot, interested parties should refer to the Subdivision Plan and 88B Instrument.
- Slab thickness and piling requirements subject to structural design.

Scale: @ A4

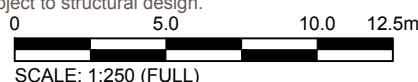

SCALE: 1:250 (FULL)

G	31/08/2020	Updated Easement	Notation	SS
Ver.	Date	Comment		By

